



# User manual

Prio

**etac**<sup>®</sup>  
Creating Possibilities

75440 - 2025-05-20 - Version 9

Applies to Etac Prio 3A with serial no beginning with 38D or  
serial no from S/N 1003310170001

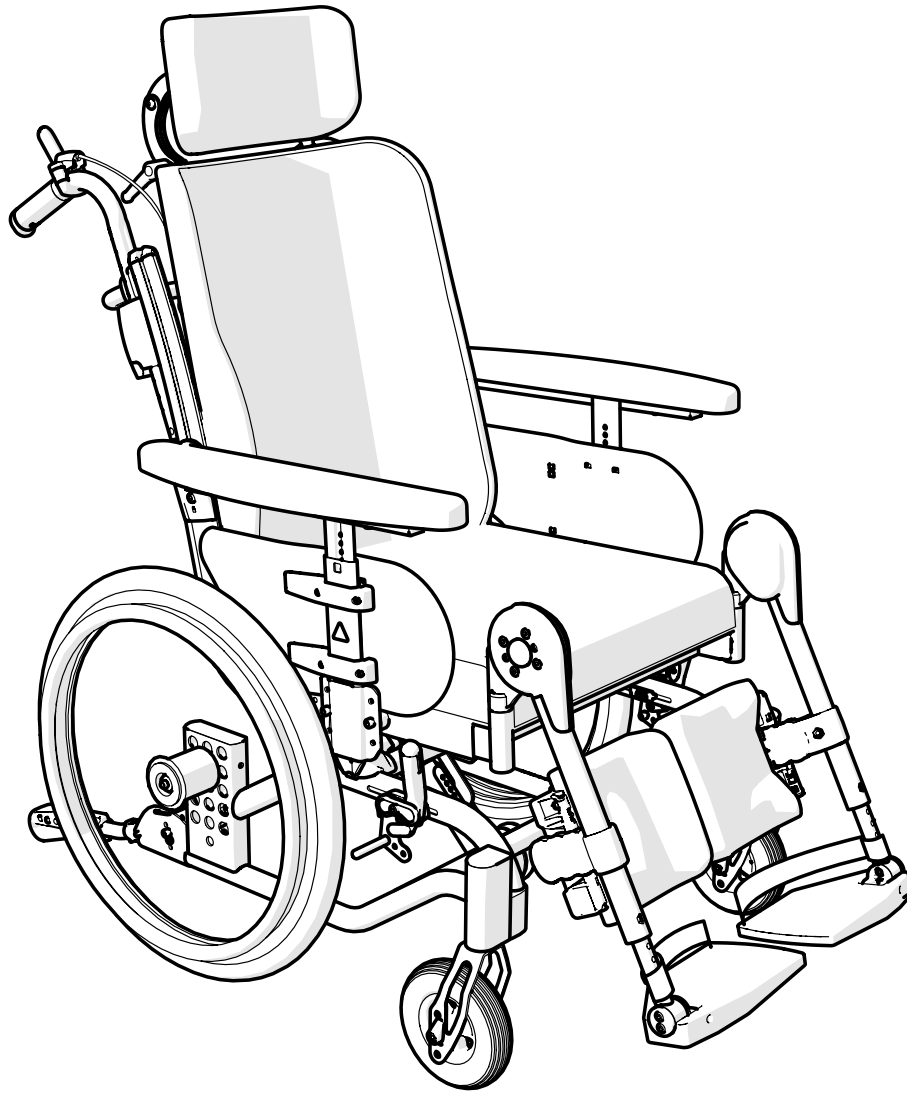

en



[www.etac.com](http://www.etac.com)

MD

CE

# Content

<b>1. General</b>		<b>14. Advanced settings, adjustments</b>	
<a href="#">Device description, Intended purpose,</a>		<a href="#">Seat height, seat height table</a>	<b>28-29</b>
<a href="#">Intended user group, Intended environment,</a>		<a href="#">Changing rear wheel position</a>	<b>30</b>
<a href="#">Intended application, Expected service life,</a>		<a href="#">Height adjustment front</a>	<b>31</b>
<a href="#">Indications, Contraindications, Warnings,</a>		<a href="#">Height adjustment front fork housing</a>	<b>31</b>
<a href="#">Declaration of conformity, Pre-purchase information,</a>		<a href="#">Disassembly/assembly of the castor wheel</a>	<b>31</b>
<a href="#">Adverse event, Customization, Warranty, Miscellaneous.....</a>	<b>3</b>	<a href="#">Disassembly/assembly of the front fork</a>	<b>31</b>
<b>2. Safety</b>		<a href="#">Seat height adjustment when the chair is equipped with attendant brake</a>	<b>32</b>
<a href="#">Symbols</a>	<b>4</b>	<a href="#">Back support height adjustment</a>	<b>33</b>
<a href="#">Transport in vehicle</a>	<b>5</b>	<a href="#">Seat depth - front</a>	<b>34</b>
<a href="#">Transportations in aeroplanes</a>	<b>5</b>	<a href="#">Seat depth - rear, manual recline function</a>	<b>35-37</b>
<b>3. Service and maintenance</b>		<a href="#">Gas piston attachment</a>	<b>38</b>
<a href="#">Cleaning, disinfectiion and maintenance</a>	<b>6</b>	<a href="#">Seat depth - rear, electrical recline function</a>	<b>39-41</b>
<a href="#">Fault-finding chart</a>	<b>6</b>	<a href="#">Screw positions for rear seat depth, electrical recline function</a>	<b>42</b>
<b>4. Technical data</b>		<a href="#">Adjustment of comfort lock</a>	<b>43</b>
	<b>7-8</b>	<b>15. Readjustments</b>	
<b>5. Description</b>		<a href="#">Arm support</a>	<b>44</b>
	<b>9</b>	<a href="#">Rear wheel with quick release</a>	<b>45</b>
<b>6. The chairs options</b>		<a href="#">Brake, adjustment</a>	<b>45</b>
	<b>10-11</b>	<a href="#">Brake lever adjustment</a>	<b>45</b>
<b>7. Accessories</b>		<a href="#">Brake, mounting and adjusting brake adapter</a>	<b>46</b>
	<b>12-13</b>	<a href="#">Balance point/balance settings</a>	<b>47</b>
<b>8. Installation upon delivery</b>		<a href="#">Amputee support</a>	<b>47</b>
<a href="#">Back support</a>	<b>14</b>	<a href="#">Elevating leg support with calf support</a>	<b>48</b>
<a href="#">Push handle/bow handle</a>	<b>15</b>	<a href="#">Anti tippers</a>	<b>48</b>
<a href="#">Cross brace</a>	<b>15</b>	<b>16. Accessories - adjustments, handling</b>	
<a href="#">Head support</a>	<b>15</b>	<a href="#">Positioning belt</a>	<b>49</b>
<b>9. Charging</b>		<a href="#">Attachment for chest harness</a>	<b>50</b>
	<b>16</b>	<a href="#">Back support widening</a>	<b>51</b>
<b>10. How to use</b>			
	<b>17-20</b>		
<b>11. Seat comfort settings</b>			
	<b>21-23</b>		
<b>12. Driving technique, use</b>			
	<b>24-26</b>		
<b>13. Removal of upholstery</b>			
	<b>27</b>		

# 1. General



Thank you for choosing an Etac product. In order to avoid damage during assembly, handling and use, it is important to read this manual and save it for future reference. You can also find it at [www.etac.com](http://www.etac.com). You can select your language via the "International" and "Local websites" link. Here you will also find other product documentation, such as pre-subscriber information, pre purchase guide, and reconditioning instructions.

In this manual the User is the person with disability for whom the assistive device is intended. The assistant is the person supporting the user.

Information on how people with impaired vision can access the manual can be found in our presales guide at [www.etac.com](http://www.etac.com).



To avoid damage or injury during handling and use, this manual should always accompany the device.

## Device description

Prio (hereafter also referred to as "the device" or "the product") is a manual wheelchair with rigid frame and tilt- and recline functions. Prio is adaptive and configurable through adjustable settings, options and accessories.

## Intended purpose

Prio is an assistive device intended for the alleviation of or compensation for a physical impairment due to an injury or disability. The device is designed for mobility and for tilt- and recline. The device is designed for hand and/or foot propulsion and/or to be pushed and steered by an attendant.

## Intended user group

The user group for Prio is based on the individual's functional ability and not on a specific diagnosis, health condition or age. It is intended for individuals with a height of 146 cm or more, or a mass of 40 kg or more.

Secondary users of the device are attendants providing assistance and clinicians/technicians who set up the device.

## Intended user environment

Prio is intended for indoor and outdoor use on levelled ground and accessible terrain. It is not to be exposed to salt water. The device has fixation points for transport in motor vehicle.

## Intended application

The device is intended for short-term and long-term use. The device is intended to be used with a seat cushion. The device is intended for refurbish and reuse. Follow the instructions in "Reconditioning instruction, Etac manual wheelchairs" on [www.etac.com](http://www.etac.com).

## Expected service life

The expected service life of the device is 10 years. Preventive maintenance is recommended. Lack of maintenance may reduce the expected service life of the device. For full information on the expected service life, see [www.etac.com](http://www.etac.com).

## Indications

Indication for use is disability, including, but not limited to, an impaired ability to ambulate and postural alignment.

## Contraindications

There are no known contraindications.

## Warnings

Warnings describing a risk element for a specific action or setting of the device can be found in the relevant section.



Do not leave the device in direct sunlight. A hot device may cause burns.



Tipping risk. Inactivated anti-tips will increase the risk of injury. Activate the anti-tips to avoid the risk of tipping.



Do not lift the wheelchair by the leg supports. Risk of injury.



A defective device must not be used. Risk of injury.



Do not stand on the foot plates. Risk of injury.



The electric functions must not be used when there is an obstacle, e.g. when the user's legs are under a table. Risk of injury.

Use of accessories, components or cables other than those specified could result in increased electromagnetic emissions or decreased electromagnetic immunity of this equipment and result in improper operation. Portable RF communications equipment (including peripherals such as antenna cables and external antennas) should be used no closer than 30 cm (12 inches) to any part of the device, including cables specified. Otherwise, degradation of the performance of this equipment could result..



Ignoring the instructions for use may result in injury.



Ensure that the user has the arms on the arm supports and feet on the foot supports. Risk of squeezing due to moving parts.



Do not lift the wheelchair by the Head Support Attachment. Risk of injury.



When attaching the rear wheels, make sure that the quick-release button fully returns. Test by pulling the wheel. Risk of injury.



Fingers can be injured if they get between the spokes. Spoke protection is available as a means to prevent injury.



The device can be adjusted beyond safe use. Adjustments should only be carried out by a person who understands the use of the device.

## Declaration of conformity

The device conforms with MDR (EU) 2017/745.

The device is tested and conforms with EN 12183 and ISO 7176-19.

## Pre-purchase information

Pre-purchase information can be found at [www.etac.com](http://www.etac.com).

## Adverse event

In case of an adverse event occurred in relation to use of the device, it must be reported to your local dealer and the national competent authority in a timely manner. The local dealer will forward information to the manufacturer.

## Customization

Actions outside the instructions and settings in the manual will invalidate the CE marking according to MDR 2017/745 and void the warranty.

## Combinations

Combinations between Etac devices and devices from other suppliers are presented in the combination list on [www.etac.com](http://www.etac.com).

## Miscellaneous

Etac regularly improves its products. We therefore reserve the right to modify the products without prior notice. The dimensions given on drawings or other material are solely for guidance.

We are not responsible for printing errors or incomplete information.

## Warranty:

5-year warranty against defects in materials and manufacture.

For conditions, see [www.etac.com](http://www.etac.com).

## Tools



Allen key  
3, 4, 5, 6 mm



Ring spanner  
8, 10, 13, 17,  
24 mm



Socket spanner  
19 mm



Screwdriver  
Ph 2

## 2. Safety

### Symbols

These symbols appear in the manual.



Warning, precaution or limitation



Useful advice and tips.



Material for recycling



Click on the icon or scan the QR code for video



Showing 1 of two options



Showing 2 of two options

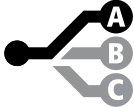

Showing 1 of three options



Showing 2 of three options



Showing 3 of three options



Adjusting back support angle



Adjusting seat angle

### Symbols

These symbols appear on the device.



Securing. Fixing points for the clamping system for transport in motor vehicles.



Risk of tipping: Always keep the anti-tips folded down.



Do not lift the chair by removable parts



The product meets the requirements according to ISO 7176-19.

### Product label

Article information.

Medical device	Product	Product Serial no.	Bar code acc. to GS1-128 GTIN-14 and serial no.*
 Max XXX kg	XXXXXXXXXXXX	XXXXXXXXXX XXXXXXXXXX	[ ] YYY-MM-DD
Maximum user weight		Item no.	Date of manufacture

\*The device's date of manufacture can be read from the barcode on the device. The number 11 is shown below the barcode in brackets. The number combination after these brackets is the date of manufacture.

Chair width

Made in Sweden

Etac Supply Center AB  
Långgatan 12  
SE-334 33 Anderstorp

**45**

Manufacturer      CE marked

## 2. Safety



### Transportation in vehicles

Etac's wheelchairs are tested in accordance with ISO 7176-19.

Etac recommends in the following order:

1) The user transfers to a seat in the vehicle and uses the vehicle's 3-point belt while travelling. The wheelchair is then placed in the boot or safely in the back seat so that it cannot overturn or roll.



- If possible, the wheelchair should be placed in the boot.
- If the wheelchair is placed in the back seat, make sure it can not overturn or roll. If possible secure the wheelchair with the car's safety belt.

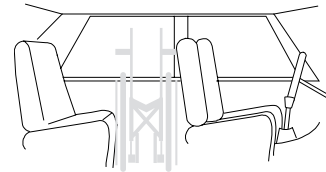

2) The wheelchair is secured facing forwards in the vehicle as per this manual, the user uses a separate 3-point belt that is secured in the vehicle.



This is the way the wheelchair is tested and approved according to ISO 7176-19:

- Clamping device UNWIN\_WWR/ATF/K/R according to ISO 10542.
- Three point strap 907523, Klippan Safety AB.
- Parking brakes activated.
- Anti-tip guards activated.
- Head support.
- Rear wheels with handrims.

### Securing

- Securement points rear must be used.
- Restraining device must not be put through the wheels or around the back tubes.
- Accessories that can be detached without tools (not arm supports, leg supports or accessories for positioning purpose) must be removed and clamped

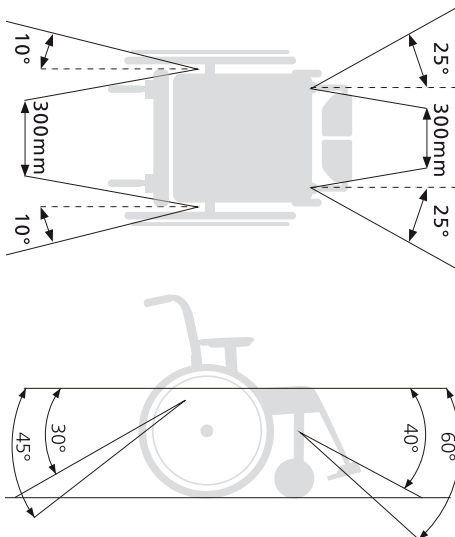
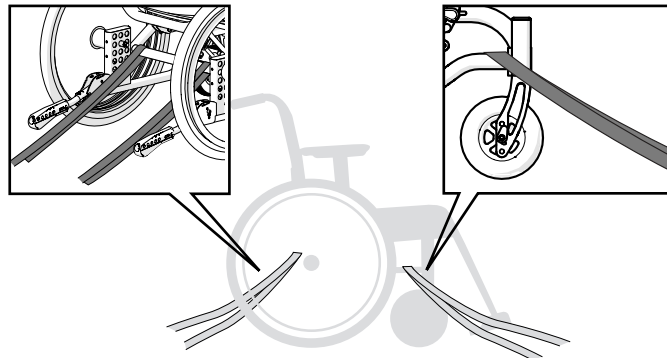
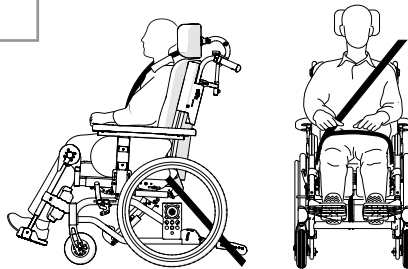

3) According to directive 2001/85/EC, appendix VII, point 3.8.3. there are specially marked wheelchair locations in vehicles that permit transport with a wheelchair facing in the opposite direction of travel. If this means of travel is used, the user/carer must be aware while travelling, prepared for sudden movements and have the capacity to maintain a safe sitting position throughout the entire journey. The user's disabilities must not be of such an extent that he/she is not able to hold onto the handles fitted in the vehicle when there are changes of speed or direction.



- Parking brakes activated.
- Anti-tip guards activated.
- Head support.
- Positioning belt should be used.
- Accessories that can be detached without tools must be removed and clamped.

### Transportation in aeroplanes

Lithium batteries are subject to statutory regulations.

Always contact your travel organiser or freight company for information about applicable freight regulations before transportation.

### 3. Service and maintenance

**General**

Device maintenance should be adapted to use.  
 If there is a fault in your wheelchair, please contact your prescriber or technical aids centre. A defective wheelchair must not be used.  
 If your chair needs reconditioning or repair, only original parts from Etac or components with equal quality should be used.  
 Etac will not be held responsible for damage or injury caused by use of non-original parts.



When necessary lubricate moving parts/joints with bicycle oil or similar.

**Washing the back support and seat**

The back cover is made from two-ply polyester. It is removed by unscrewing the end terminations on the back rail.  
 Then pull the cover upwards and wash in accordance with the washing instructions on the label.  
 The covers for the seat and back cushion are removable and must be washed in accordance with the washing instructions on the label.

**Rear wheel/castor**

Spokes: Loose spokes can lead to wheel wobble. Consult a cycle

dealer or technical aids centre if it is necessary to adjust the spokes.

- Wheel axles: Clean the wheel axles from hair and dirt as necessary.
- Ball bearings: Require no maintenance.
- Handrims: If a handrim is damaged in such a way that it can cause hand injuries, it should be replaced.

**Brakes**

Heavy dirt can have a negative effect on the brake mechanism. In the event of adjustments, see Section "Brakes, adjustment".

**Washing the frame**

It is important, both for the sake of hygiene and for the longevity of the chair, that the wheelchair is kept clean. It is equipped with a drainage hole which ensures that it is easy to wash and dry.

Clean the frame with a non-abrasive cleaning agent with a pH level between 5 and 9, or with a 70% disinfectant solution. Rinse and dry.

**Chair with electrical back and seat recline function**

Electrical components conform with protection class IPX6, which means the device may be cleaned with a brush and water.  
 Do not rinse electrical components with a

pressure washer.  
 Maximum washing temperature 20 °.  
 Do not use chemicals on electrical components.  
 The battery charger must not be connected. Internal cables must be connected.  
 Retract the actuator to the innermost position to avoid degreasing of the piston rod.  
 For washing in a cabinet washer-disinfectant, all electrical components must be removed. See separate service manual at [www.etac.com](http://www.etac.com).

**Storage**

The device should be stored indoors in a dry place at a temperature above 5 °C. If the device has been stored for a long time (more than four months), its function must be checked by an expert before use.

**Touch-up paint**

For minor scratches and paint damage, touch-up paint is available.

**Separation at source/disposal**

The device must be sorted in accordance with national regulations.  
 Batteries: hand in to battery recycling.  
 Motor and control box: hand in to electronics recycling.

<b>Fault-finding chart</b>	
The wheelchair pulls to the side	<ul style="list-style-type: none"> <li>Pump the tyres</li> <li>Check that the front fork attachments are mounted correctly and have the correct height adjustment</li> <li>Check that the rear wheels are mounted correctly</li> <li>The user is distributing weight unevenly in the wheelchair</li> <li>More strength being used on one side than the other</li> </ul>
The wheelchair is "heavy" to operate	<ul style="list-style-type: none"> <li>Pump the tyres</li> <li>Check that the rear wheels are mounted correctly</li> <li>Clean the castor axles of hair and dirt</li> <li>Too much weight over the castors. Adjust the centre of balance</li> </ul>
The wheelchair is "heavy" to turn	<ul style="list-style-type: none"> <li>Pump the tyres</li> <li>Check that the front forks have not been tightened too much</li> <li>Clean the castor axles of hair and dirt</li> <li>Too much weight over the castors. Adjust the centre of balance</li> </ul>
The user brake is not effective	<ul style="list-style-type: none"> <li>Pump the tyres</li> <li>Adjust the distance between the tyre and the brake (see Section "Brake, adjustment")</li> </ul>
The attendant brake is not effective	<ul style="list-style-type: none"> <li>Adjust the wire length using the adjustment nipple on the brake drum (see Section "Attendant brake")</li> </ul>
Rear wheels are "loose"	<ul style="list-style-type: none"> <li>Adjust the length of the axle shaft</li> </ul>
Rear wheels hard to remove/replace	<ul style="list-style-type: none"> <li>Clean and lubricate the quick release using e.g. cycle oil</li> <li>Adjust the length of the axle shaft</li> </ul>
The castor wheels "wobble"	<ul style="list-style-type: none"> <li>The front forks have not been tightened sufficiently</li> <li>Check that the front fork attachments are mounted correctly and have the correct height adjustment</li> <li>Too much weight over the castors. Adjust the centre of balance</li> </ul>
The wheelchair feels "awkward"	<ul style="list-style-type: none"> <li>Pump the tyres</li> <li>Check that screws and controls are properly tightened</li> </ul>
Electrical back and seat recline function does not work	<ul style="list-style-type: none"> <li>Hand control has been deactivated – activate by pressing the on/off button</li> <li>End position has been reached – use opposite button</li> <li>Battery is not charged – charge battery</li> <li>Hand control function is locked – unlock function (See section 'Electrical recline function')</li> <li>Hand control is not connected – check that the hand control is correctly connected to the electronics unit</li> <li>Error on hand control – phone retailer or technician for replacement of hand control</li> <li>Error on electronic unit – phone retailer or technician for replacement of electronics unit</li> <li>Damaged cables – phone retailer or technician for replacement of cables</li> </ul>
Electrical back and seat recline function does not work in spite of action taken	<ul style="list-style-type: none"> <li>Reset the system by pressing the arrow up buttons and holding for five seconds</li> </ul>



## 4. Technical data

Type of chair	Art no	Total width	Seat height	Seat depth*	Effective seat width	Transport width	Weight**	Transport weight***	Max. user weight
40 cm	13420305	59 cm	38-52.5 cm	39-51 cm	40 cm	56 cm	33.0	22.4	135 kg
45 cm	13420309	64 cm	38-52.5 cm	39-51 cm	45 cm	61 cm	33.3	22.7	135 kg
50 cm	13420313	69 cm	38-52.5 cm	39-51 cm	50 cm	66 cm	33.6	23.0	135 kg
55 cm	13420317	74 cm	38-52.5 cm	39-51 cm	55 cm	71 cm	33.9	23.3	135 kg

Total length	Folded length	Seat angle	Back support angle	Back support height	Handrim size	Leg support length
101.5 cm	86.5 cm	-3° – +20°	0° – +30°	46-62 cm 52-68 cm****	44.5-52.5 cm	33-61 cm

\* The seat depth is measured from the front of the seat cushion to the middle of the back cushion.

\*\* With arm supports, elevating leg supports, calf supports, rear wheels and anti-tips.

\*\*\* Without arm supports, head support, seat cushion, elevating leg supports, calf supports, rear wheels.

\*\*\*\* With back support extension

Max. incline sideways	Max. incline down	Max lutning broms	Tyre							
			High pressure 22"	High pressure 24"	Solid 22"	Solid 24"	Solid (solid inner tube) 22"	Solid (solid inner tube) 24"	Solid 16"	
			PSI/Bar	110/7.5	110/7.5	-	-	-	-	-
>20°	>20°	7°		550 mm	590 mm	550 mm	600 mm	550 mm	590 mm	390 mm
				25 mm	25 mm	32 mm	32 mm	25 mm	25 mm	40 mm

### Chair with electrical back and seat recline function

Operating environment		
	Long-term/short-term storage and transportation	Operation
Temperature	-10 - +40	+5 - +30
Relative air humidity	20 - 90%	
Atmospheric pressure	700 - 1060 hPa	

If the chair has been stored at a low temperature, it must be adapted to the operating conditions before use.

Electrical system	
Supply voltage	100 - 240 VAC, 50/60 Hz (-15% +10%)
Maximum input current	3.9 A
Intermittent (periodic motor use)	5% 1 min constant use 19 min standby
Nominal voltage	25.9 V DC
Protection class	IPX6
	The part in contact with the patient meets the requirements for protection against electric shocks in IEC60601-1.
Degree of protection <input type="checkbox"/>	Class 2
Battery type	Lithium ion

Complete information and user instructions for electrical components is available at [www.linak.com](http://www.linak.com), or contact your retailer or technical aids centre.

### Electromagnetic compatibility (EMC)

This device has been tested and complies with the EMC limit values given in IEC 60601-1-2 for class B equipment.

## 4. Technical data



ALU	Fe	PES	Fe/CF/ALU	PP/TPR	ALU/PA/PE/PU



## 5. Description

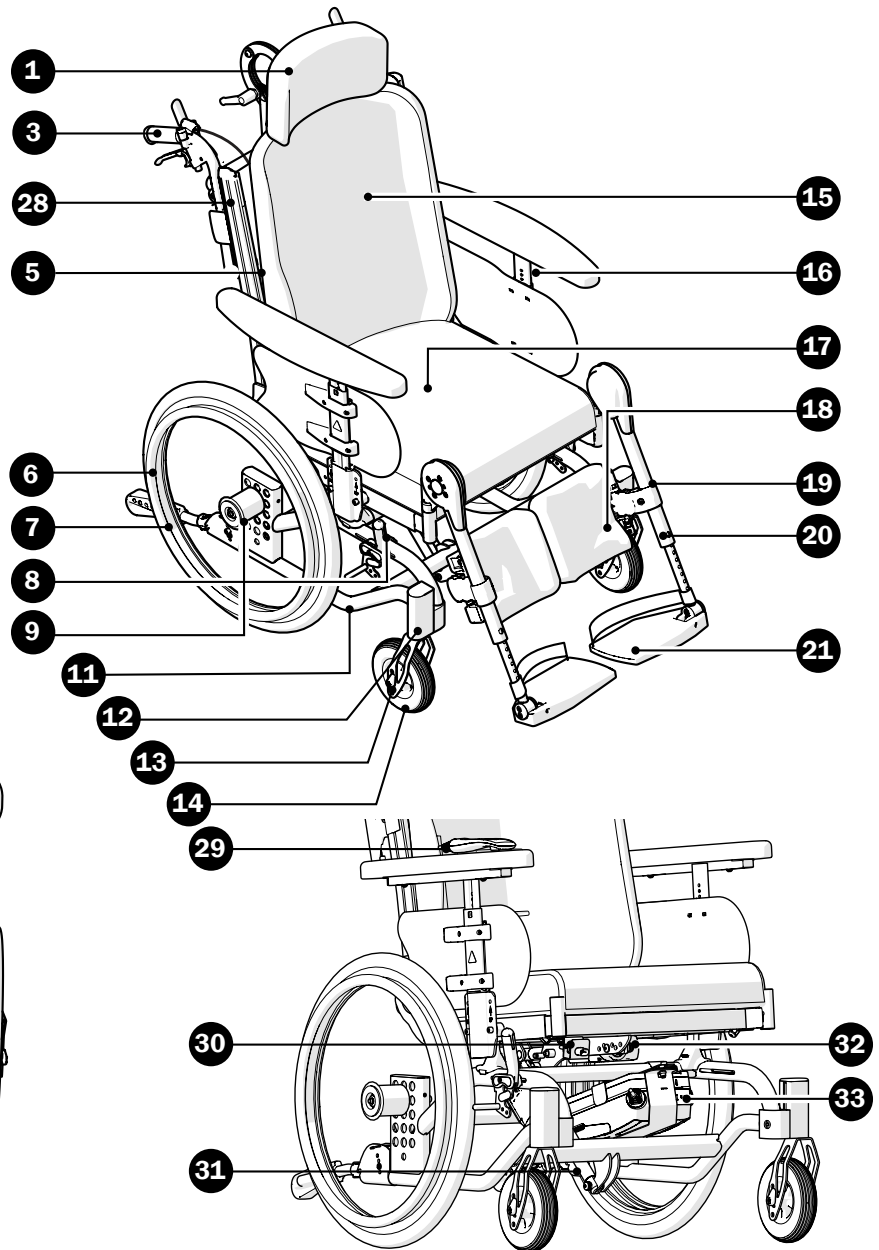
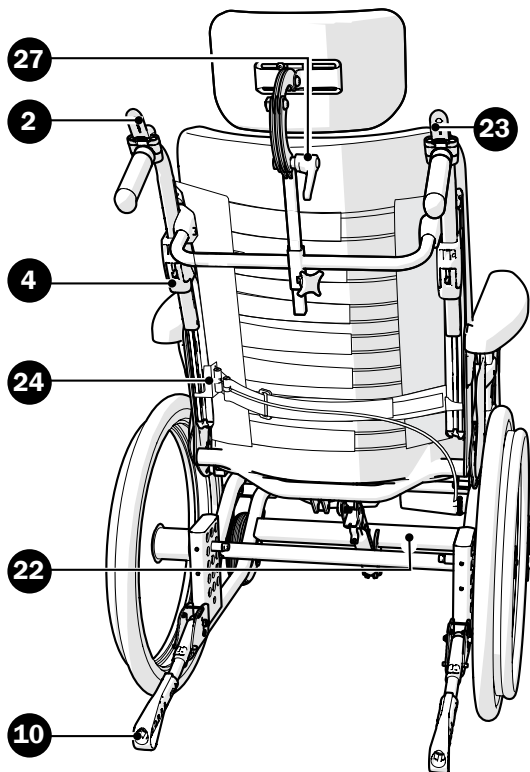
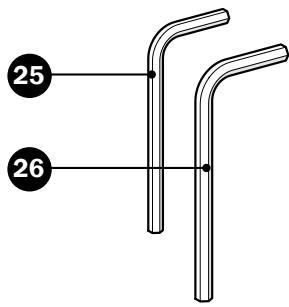

- |                           |                                   |                                   |
|---------------------------|-----------------------------------|-----------------------------------|
| 1. Head support           | 13. Front fork                    | 25. Tool - Allen key 3 mm         |
| 2. Controls - back angle  | 14. Castor wheel                  | 26. Tool - Allen key 5 mm         |
| 3. Push handles           | 15. Back cushion                  | 27. Snap lock - head support      |
| 4. Push handle locking    | 16. Arm supports                  | 28. Trunk support attachment      |
| 5. Back support           | 17. Seat cushion                  | 29. Hand control                  |
| 6. Rear wheel             | 18. Calf pad                      | 30. Charging socket               |
| 7. Handrim                | 19. Leg supports                  | 31. Seat angle actuator           |
| 8. User brake             | 20. Knob footplate lock           | 32. Back angle actuator           |
| 9. Quick release hub      | 21. Footplate with heel straps    | 33. Battery pack and control unit |
| 10. Anti-tips             | 22. Item and serial number label* |                                   |
| 11. Chassis               | 23. Tilt controls - tilt          |                                   |
| 12. Front fork attachment | 24. Dynamic pelvic support        |                                   |

\*The device's date of manufacture can be read from the barcode on the device. The number 11 is shown below the barcode in brackets. The number combination after these brackets is the date of manufacture.

## 6. The chairs options

In the "Chair options" section you can see all configurations available for the wheelchair. For more information about chair options, see [www.etac.com](http://www.etac.com)

Settable= Adjusted using tools. Adjustable= Adjusted without tools.

<b>Seat height</b>	38-52,5 cm with 20", 22" or 24" rear wheel	
	40-45 cm with 16" rear wheel. (51.5 cm with seat height adaptor 16")	
<b>Seat angle</b>	Max. forward angle: 3° Max. backward angle: 20° See also Comfort lock	
<b>Castor wheel</b>	150x35 mm, semi-solid 45 or 57 mm hub width	
	165x30 mm, solid 57 mm hub width	
	175x45 mm (7") semi-solid 57 mm hub width	
	200x35 mm 57 mm hub width	
	200x38 solid 45 mm	
	200x50 mm, 57 mm hub width	
<b>Front fork</b>	Short (three height positions for castor wheels) 57 mm hub width	
	Medium (three height positions for castor wheels) 57 mm hub width	
	S, steel, for 45 mm hub width	
	M, steel, for 45 mm hub width	
<b>Rear wheel</b>	16", width: 42 mm, solid tyres (no handrim)	
	20", width: 32 mm, solid tyres solid or high-pressure tyres (C5 or C6)	
	22", width: 32 mm, solid tyres solid or high-pressure tyres (C5 or C6)	
	24", width: 32 mm, solid tyres solid or high-pressure tyres (C5 or C6)	
<b>Handrim</b>	Aluminium	
	Plastic coated	
	Stainless steel	
<b>Camber</b>	0°	
<b>Seat cushion</b>	Basic; lightly contoured, cold foam. Plush or hygiene cover	
	Comfort; lightly contoured, cold foam with soft memory foam in seat area. Plush- or hygiene cover	
	Tidy; with hygiene cover. Material: Hygiene. Water repellent, wipeable with wet cloth, washing 90° C .	
<b>Back support angle</b>	0° - +30°	
<b>Back support angle, fixed</b>	5°, 10° or 15°	
<b>Lumbar angle</b>	-12° to +10°	
<b>Seat depth</b>	Three alternative positions with separate intervals. Standard setting: Position 2	Position 1: 39-46 cm (short cushion)
		Position 2: 41,5-48,5 cm (short cushion)
		Position 3: 44-51 cm (short or long cushion)
<b>Head support with side support</b>	Curved cushion with soft padding, height, depth, side and angle-adjustable. Plush or hygiene cover. Black or stainless-steel bar, one or three knobs.	
	Curved cushion with side support and soft padding, height, depth, side and angle-adjustable. Hygiene cover. Black or stainless-steel bar, one or three knobs.	
<b>Head support anatomic</b>	Medium	
	Large	
<b>Back support height</b>	Adjustable height: 46-62 cm. With height extension 52-68 cm	
<b>Back support upholstery</b>	Adjustable velcro straps. Dynamic pelvic support, settable in height	



## 6. The chairs options

<b>Back support cushion 3D</b>	3-part back support cushion suitable for kyphotic users. Vertical and horizontal shape is created based on the user's back curvature. Plush	
<b>Back support cushion/Back support cover</b>	Back support cushion with plush or hygiene cover	
	Soft cover. Plush.	
<b>Pelvic support</b>	Dynamic pelvic support adjustable in height	
<b>Comfort lock</b>	Four optional modes. Provides the carer with clear instructions as to the mode that has been prescribed as the most frequent rest mode. Not in combination with electric recline function	0° seat tilt
		4° seat tilt
		8° seat tilt
		12° seat tilt
<b>User operated recline function</b>	Mounted on the arm support. To be applied on the seat tilt function only (not for back recline).	
<b>Electrical recline function</b>	Electrical recline of seat and back angle operated by means of hand control. Limitations: Not with comfort lock, dynamic pelvic support, QR-pin for back support, oxygen basket, clips angle restriction.	
<b>Push handle/Bow handle</b>	Height-adjustable in 2 cm intervals.	Push handles
		Bow handle
		Bow handle angle-adjustable (not available for 55 cm wide chairs)
<b>Leg support, elevating</b>	Six fixed positions. With padded kneepads and folding calf supports, height, angle and depth-settable	
<b>Leg support, Cross model</b>	Detachable, swing-away	
<b>Foot supports</b>	13 cm deep. Folding, angle and depth-settable. Includes heel straps. The footplate can be combined with an extended footplate.	Std Max. length: 55 cm. Min. length: 38.5 cm.
		Extended attachment tubes +10 cm. Shortened attachment tubes -8 cm.
	Solid foot support Add-On incl foot plates.	
Solid foot support, angle adjustable. In combination with leg supports (fixed angle, angle adjustable or Cross model)		
<b>Castor housing</b>	Standard	
	Widened 6 cm	
<b>Leg support, other</b>	Amputee leg support, height, depth and angle-adjustable	
	Amputee weight, angle-adjustable	
	Plaster cast leg support, depth and angle-adjustable	
<b>Arm support</b>	L49, arm support cushion PU 49x8. Settable in depth with allen screw or finger screw. Settable in height 23,5-35 cm or low 20-26 cm (only allen screw).	
	L38, arm support cushion solid 38x5. Settable in height 21-32,5 cm.	
	L37, arm support cushion PU 37x8. Settable in depth with allen screw. Settable in height 23,5-35 cm.	
<b>Brakes</b>	Angled handle	Red handle
		Black handle
	Extended handle, folding	
Single hand brake (not in combination with brake adapter)		
<b>Brake adapter</b>	For 16" and 20" rear wheels in certain positions (see section "Adjustment of the centre of balance")	
	For 22" rear wheels in certain positions (see section "Adjustment of the centre of balance")	
<b>Drum brake</b>	Brake handle with 10 cm opening grip	

## 6. The chairs options

<b>Single hand drive</b>	Telescopic shaft, detachable. Right or left mounting. Limitations: Not in rear wheel position C1 or B1, not in combination with attendant brake or basket. In combination with Lille Viking, only in rear wheel position C2).	
<b>Colour, upholstery</b>	Hygiene cover: Grey Plush: Grey	

## 7. Accessories

Assembly instructions are provided with all accessories when they are supplied by Etac.

You can find the instructions as well as more information about the accessories on our website [www.etac.com](http://www.etac.com).

Settable= Adjusted using tools. Adjustable= Adjusted without tools.

<b>Widening kit</b>	Increases the distance between the arm supports by 2 cm	
<b>Seat height adapter 16"</b>	For increased seat height (to 51.5 cm)	
<b>Back support height extension</b>	Increases the back support height by 60 mm	
<b>Back support widening</b>	Widens the upper part of the back support by 40 mm per side	
<b>Tray</b>	Transparent, installed on the arm support. Not in combination with drip stand	
<b>Hemi/Communication tray</b>	Right/Left	
<b>Head support R82</b>	Adjustable side supports	
<b>Arm support, padding</b>	For arm support standard or arm support with solid plate	
<b>Hemiplegic arm support cushion</b>	Including attachment. Curved cushion. Depth, angle and height-adjustable	
<b>Arm support pad wide</b>	Mounted on armrest with standard arm support plate	
<b>Calf strap</b>	Detachable, black nylon, length-adjustable	
<b>Padding, calf strap</b>	For calf strap	
<b>Calf support</b>	Plush. To be mounted/adjusted with velcro	
<b>Padding, foot support</b>	For foot support with depth 13 cm	
	For solid, angle adjustable foot support	
<b>Extended foot support</b>	Fits onto the existing footplate, seat width 40-55 cm. Depth 21.5 cm	
<b>Extended foot support Add-on</b>	Fits onto the existing footplate, from seat width 40-55 cm. Extends the depth of the foot supports to 22.5 cm	
<b>Foot box</b>	Padded. Securely contains the feet, while still allowing some movement. Medium or large	
<b>Distal thigh support Add-On</b>	Padded. Helps to align the femur, position the knees in a more neutral position and to control abduction.	
<b>Positioning belt</b>	Two-piece with snap lock, fixing points on the wheelchair frame	
<b>Front bracket, positioning belt</b>	Extra attachment for the positioning belt. Enables assembly of both 2- and 4-point belts, equipped with slots for individual adjustment	
<b>Chest strap bracket</b>	Only in combination with angle-adjustable head supports	
<b>Lateral support</b>	Adjustable in height, depth and width and detachable.	
<b>Lateral support swing-away</b>	Swing-away and detachable. Adjustable in height, depth and width	
<b>Cover for lateral support</b>	Plush, for lateral support pad	
<b>Adapterkit</b>	For lateral support cushion R82. For attachment to lateral support	
<b>Side stop</b>	Combined with wedge or side support cushion. Creates a more distinct stop and holds wedge or side support cushion in place. Straight or angled 30 mm	

## 7. Accessories



<b>Spoke guards</b>	With grey or yellow print		
<b>Tool kit</b>			
<b>Side support cushion</b>	Provides light lateral support. Used (in combination with arm supports) in cases where trunk support is too stabilising.		
<b>Back support wedges</b>	Provides individual support. Available in multiple sizes.		
	Dark grey plush, 15 or 30 cm		
<b>Sideguard pad</b>	Reduces the width between the arm supports by 30 mm (15 mm on each side)		
<b>Drip stand</b>	Bracket and stand. Not in combination with tray		
<b>Oxygen holder/Transport basket</b>	Not in combination with electric recline function or Lille Viking auxiliary engine. Only with seat heights above 43 cm		
<b>Pommel</b>	Depth-settable		
<b>Angle restriction</b>	Reduces the control range of the seat angle by 2° per clip Reduces the control range of the back angle by 2.5° per clip Not in combination with electric recline function		
<b>Back angle control</b>	Reduces the control range of the back angle variably		
<b>Lock, seat and back angle controls</b>	Locks the seat and/or back angle		
<b>QR-pin back support</b>	Simplifies folding of the back support (not in combination with seat depth pos. 1, 39-46 cm)		
<b>Memory function head support</b>	Simplifies mounting of head support (preset height)		
<b>Cane holder</b>	Two parts, one of which is an elasticated section that is fastened around the cane		
<b>Extension back upholstery</b>	Covers the gap between the seat and the back at higher back heights and provides extra support for the seat cushion		
<b>Propulsion motor, Lille Viking</b>	Assistance aid for outdoor use (not under 45 cm seat height)		
<b>Combinations</b>	Power assist		
	Head support		
	Seat cushions		
	Belts and harnesses		

## 8. Installation upon delivery

### Back support

The wheelchair is supplied with the back support folded and with push handles/bow handle and head supports unassembled.

1-3. Install fixed gas piston/actuator in the back support frame.



When attaching the QR-axle make sure that the quick-release button fully returns. Test by pulling the axle. Risk of injury.

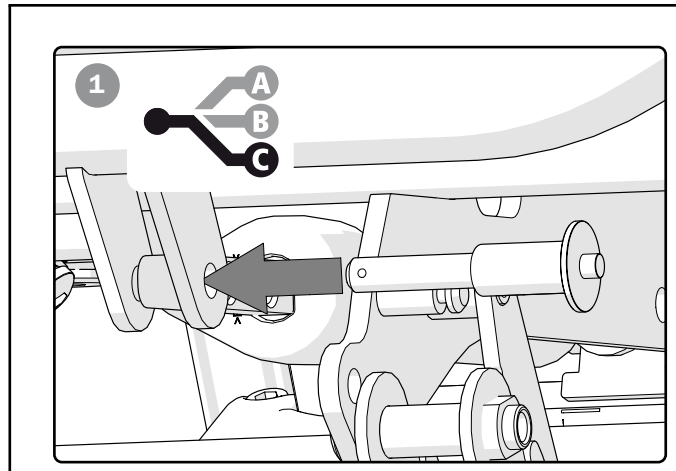
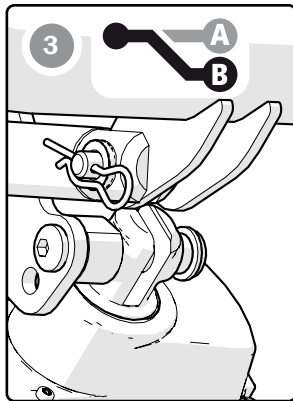
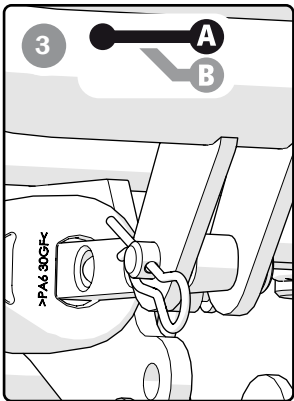
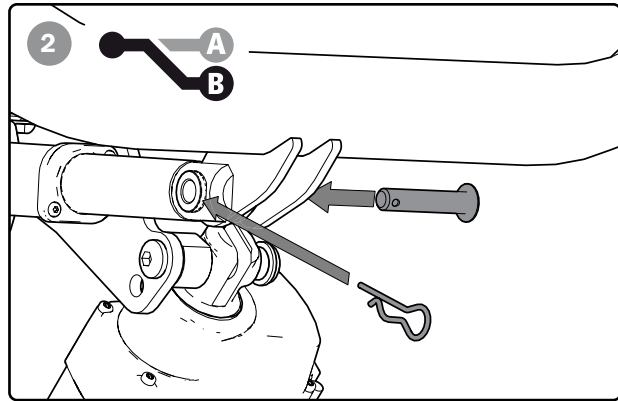
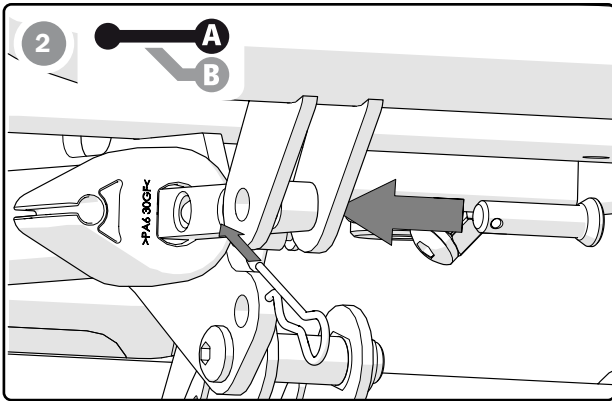
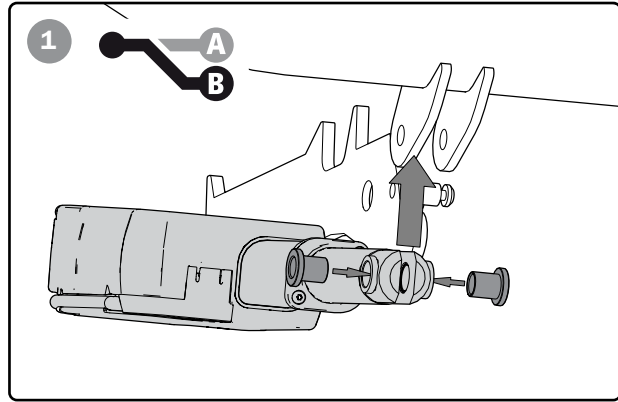
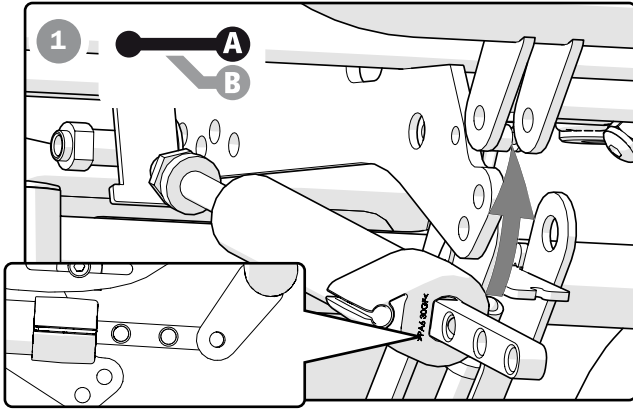

10 mm



5 mm



6 Nm

### Back support with fixed angle

1. Mount the back support frame in the desired position.

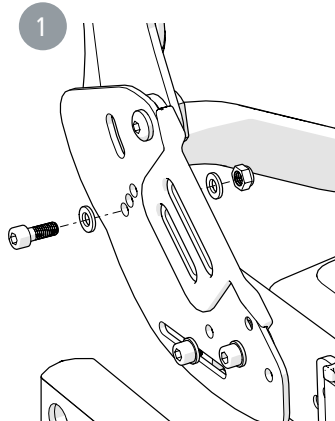

5 Nm



5 mm



10 mm



## 8. Installation upon delivery

### Push handle/Bow handle

Install the push handles/bow handle by loosening the handle and pushing in the locking pins on the push handle. Note! push handle with symbol for back angle must be installed on the *left* side, push handle with symbol for tilt must be installed on the *right* side.

Fasten the handle.



Make sure knobs are securely tightened and that the push handle locking pins are secured in the push handle attachment. This is especially important when lifting the wheelchair with the user in.

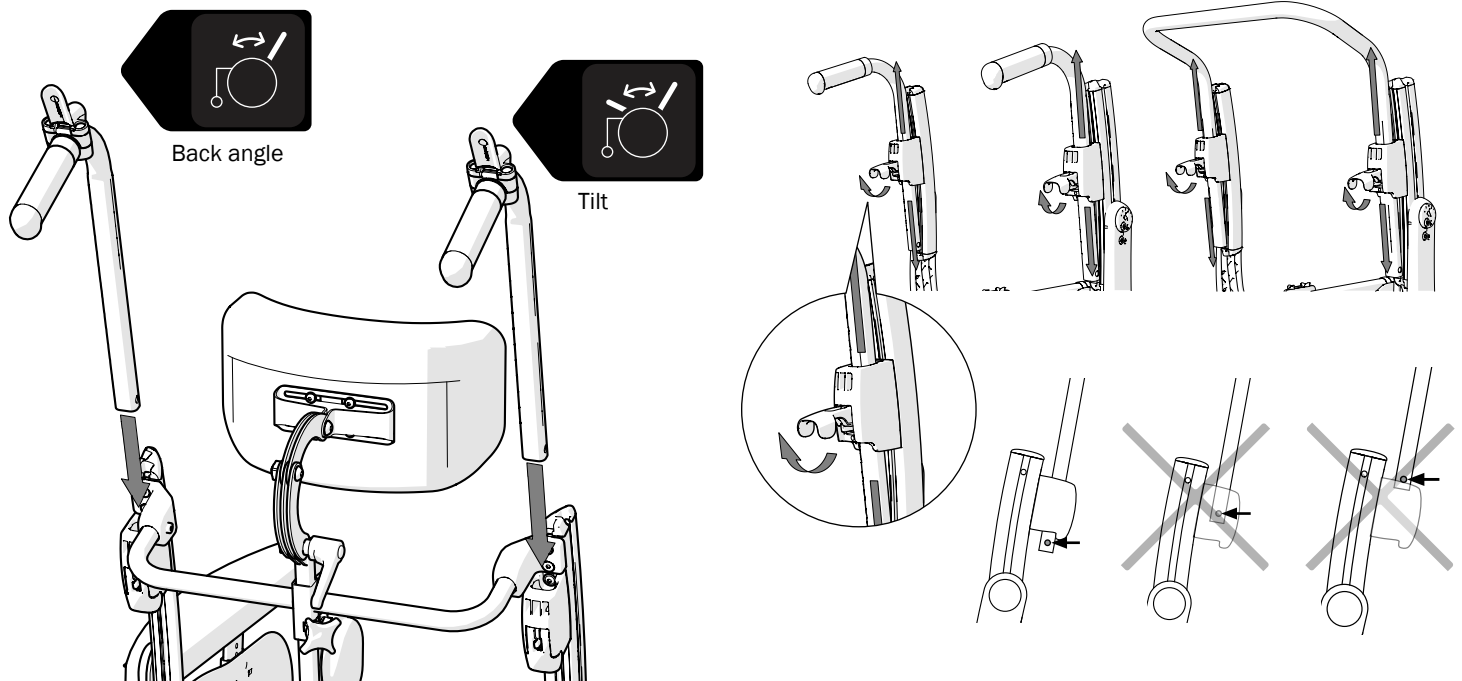

### Cross brace

If the chair is equipped with a push brace, it can sometimes be delivered with the cross brace removed. Fit the cross brace as shown in the illustrations.

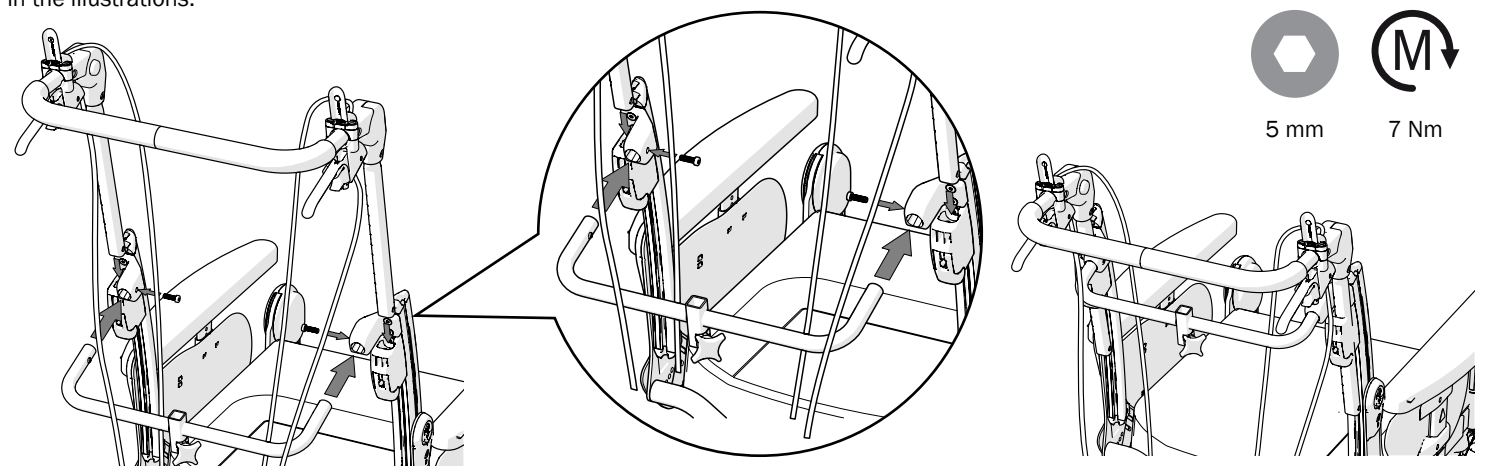

### Head support



Do not lift the wheelchair by the Head Support Attachment. Risk of injury.

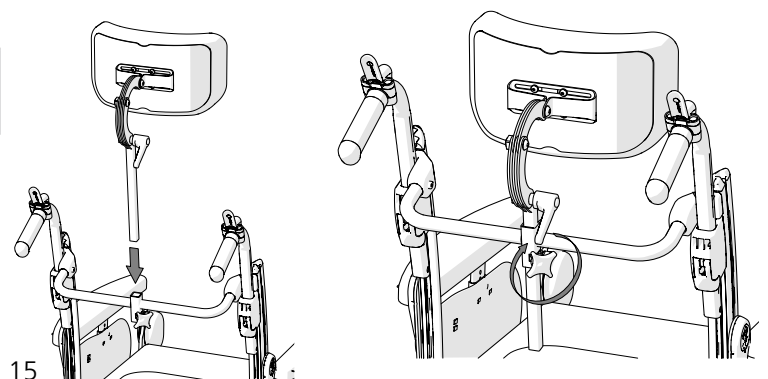

## 9. Charging

### Charging the battery (Electrical recline function)

When the chair is delivered the battery is base charged. The battery must be charged fully before the device is used for the first time, but not later than 12 months after delivery. After this, conservation charging is required at least once every 12 months.

Charging should be done in a dry environment. Ensure that the charging socket is completely dry before charging.

Insert the charging socket and connect the charger to a wall socket.

The voltage indicator (A) is illuminated, showing that the charger is connected.

The two indicators showing that the battery is charging (B) flash. When the lights go out, the battery is fully charged.

When the battery level is low (0-35%) the hand control emits an audible signal when it is used.



Do not use the wheelchair while charging the battery. Risk of injury if the power cord gets damaged.

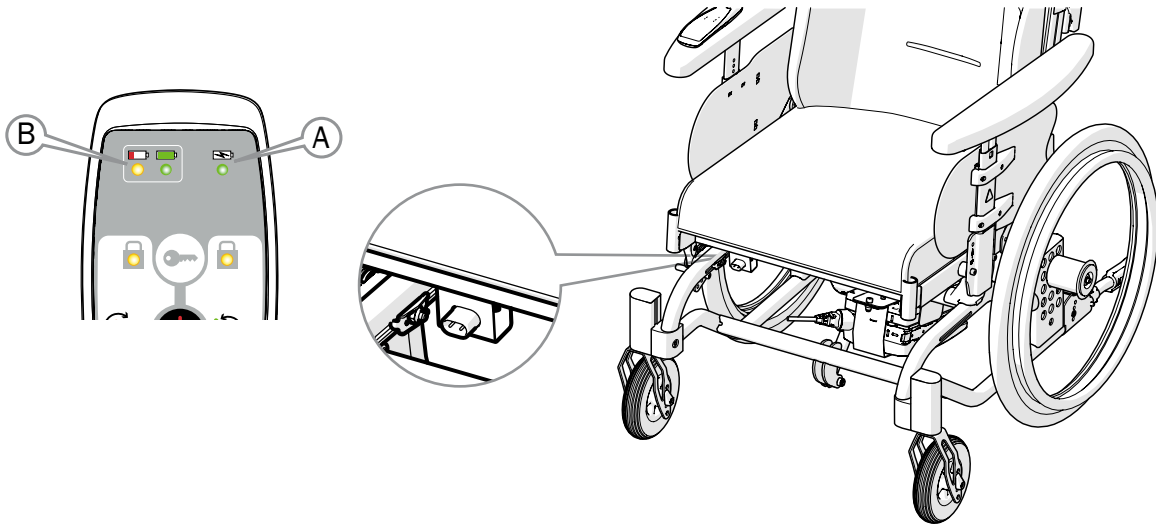

## 10. How to use

### Tilt function, comfort lock

The chair is tilted by pressing down the adjustment on the right handle frame (or on the arm support if the device is equipped with user operated tilt function). On chairs equipped with comfort locks, forward tilting is stopped at the pre-installed comfort lock. Keep the adjustment pressed down, and press forward slightly to get past the comfort lock.



Tipping risk. Inactivated anti-tips will increase the risk of injury. Activate the anti-tips to avoid the risk of tipping.

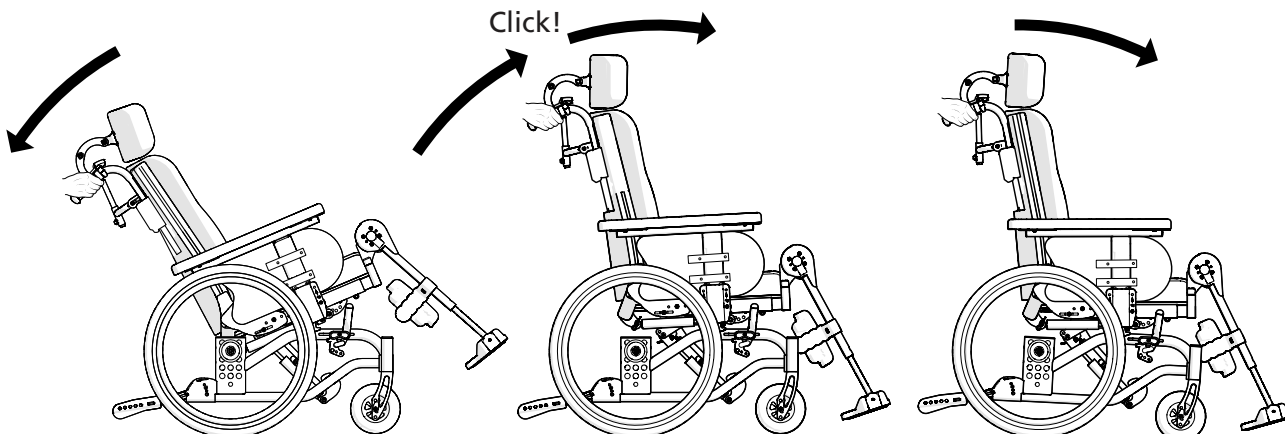
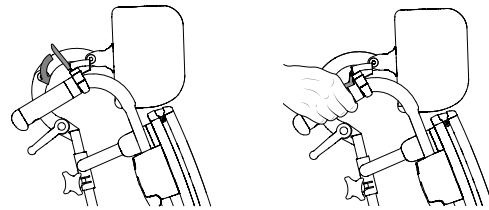

# 10. How to use



## Back angling

The back angle is changed by pressing down the back angle controls on the left side (not for fixed back angle).



Tipping risk. Inactivated anti-tips will increase the risk of injury. Activate the anti-tips to avoid the risk of tipping.

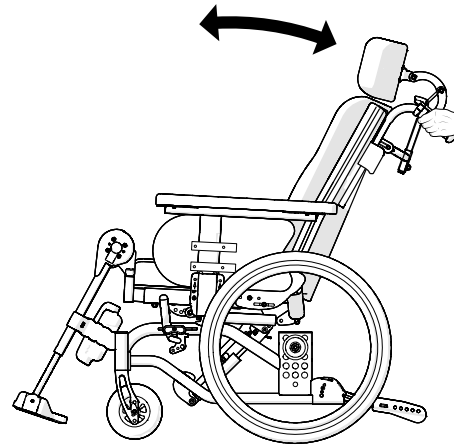
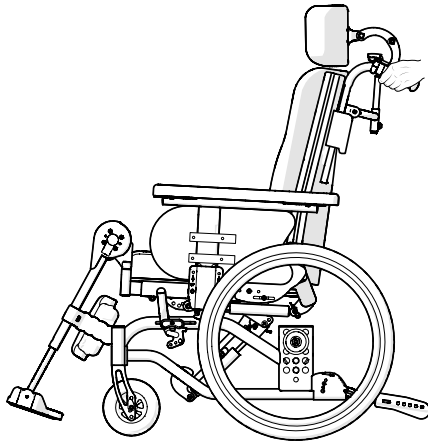
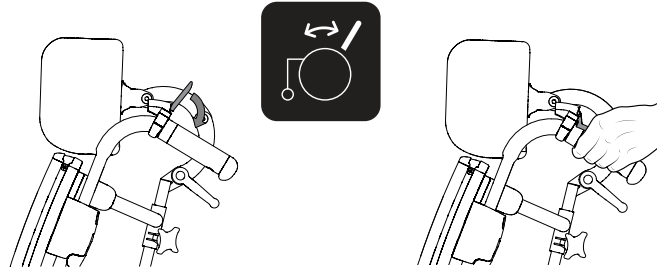

## Electrical recline function

Back angle and seat angle are adjusted by means of the hand control. The hand control is deactivated after not being used for 30 seconds. It can also be deactivated manually by clicking the on/off button.



The hand control must not be used by persons with cognitive impairment or by children. Risk of squeezing due to moving parts.

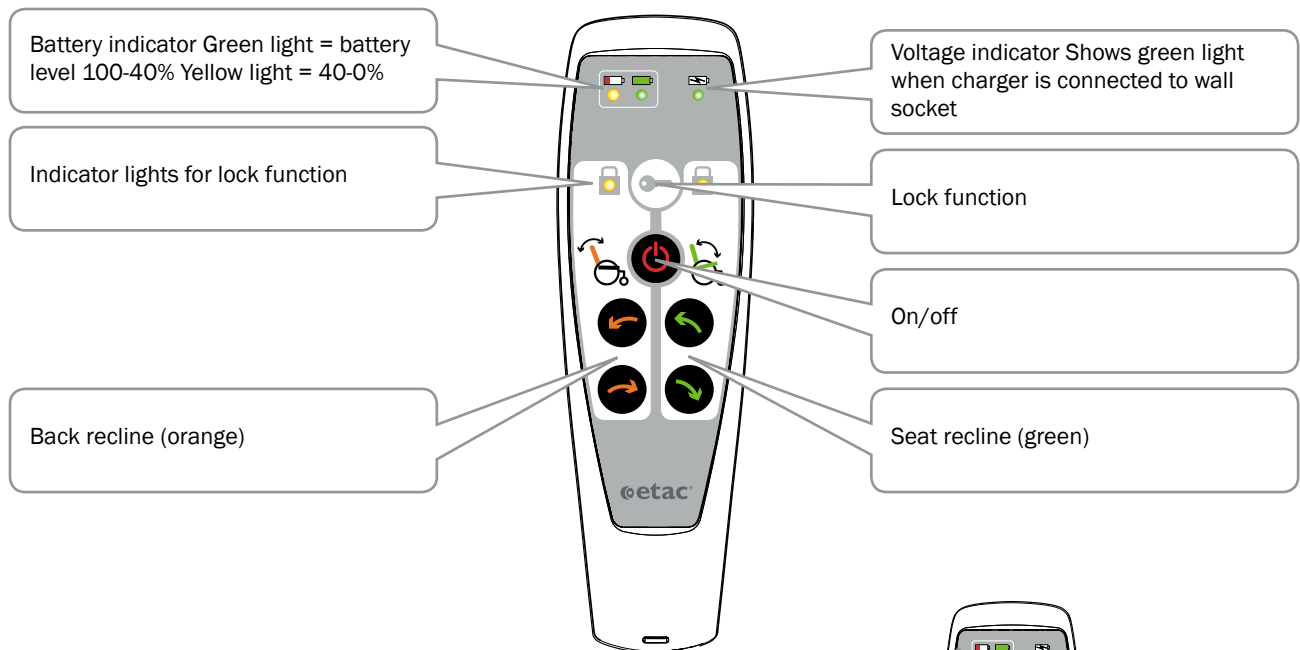

## Locking of functions

The back and/or seat recline functions can be locked. Press the locking button and hold it down. At the same time, press one of the arrow buttons for the selected function. (Both of them work.) The indicator light is lit when the selected function is locked.

Repeat the same procedure to unlock.

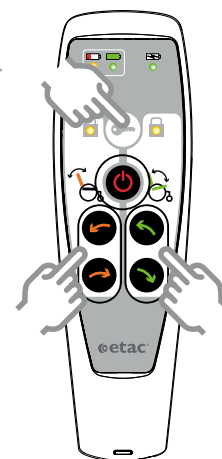

## 10. How to use

### Charging

When the battery level is low (0-35%) the hand control emits an audible signal when it is used and the yellow light (A) is lit. See section 'Charging'.

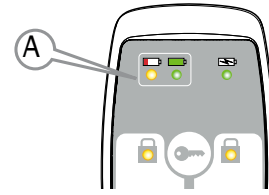

Do not use the wheelchair while charging the battery. Risk of injury if the power cord gets damaged.

### Electrical recline function, back angle

The back angle is adjusted by means of the arrow buttons on the left-hand side of the hand control.



Tipping risk. Inactivated anti-tips will increase the risk of injury. Activate the anti-tips to avoid the risk of tipping.



The electric functions must not be used when there is an obstacle, e.g. when the user's legs are under a table. Risk of injury.

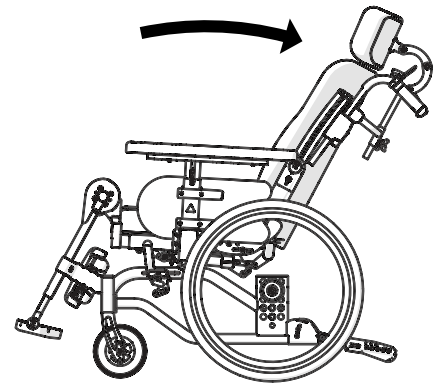
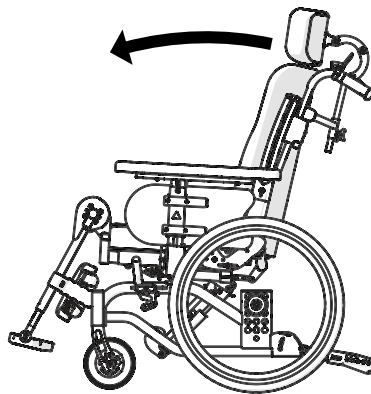
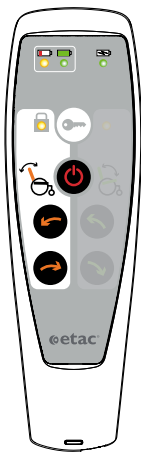

### Electrical recline function, seat angle

The seat angle is adjusted by means of the arrow buttons on the right-hand side of the hand control.



The electric functions must not be used when there is an obstacle, e.g. when the user's legs are under a table. Risk of injury.



Tipping risk. Inactivated anti-tips will increase the risk of injury. Activate the anti-tips to avoid the risk of tipping.

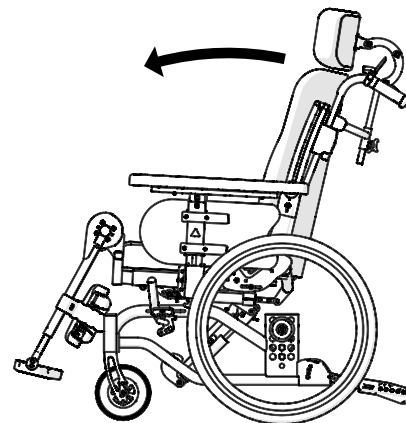
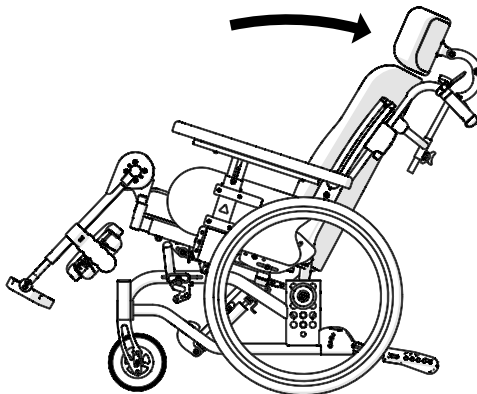
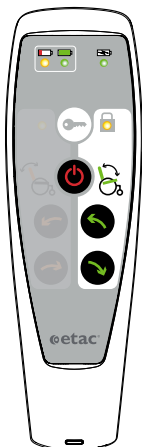



## 10. How to use

### Rear wheel with quick release hub

Push the button on the quick-release hub and mount the wheel. The distance between the hub sleeve and the locking balls can be adjusted by adjusting the nut on the outside of the hub. The distance between the hub sleeve and the locking balls should be 0.2 to 1.2 mm.

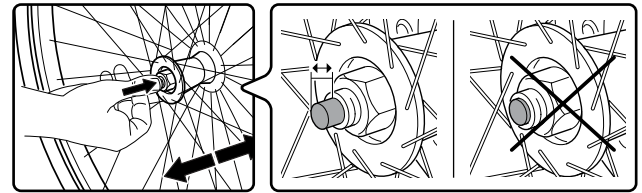

When attaching the rear wheels, make sure that the quick-release button fully returns. Test by pulling the wheel. Risk of injury.

### Anti-tips

- The anti-tips can be folded and are height-settable.
- When unfolding the anti-tip guard, make sure that the locking pin snaps in properly.
- After all adjustments to the chair, the function of the anti-tip guard must be checked. If the anti-tip guard needs to be adjusted, contact your technical aids centre.

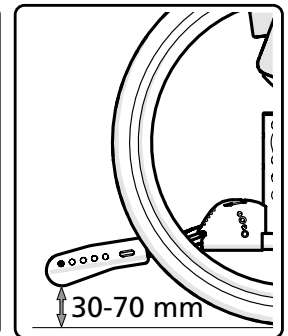
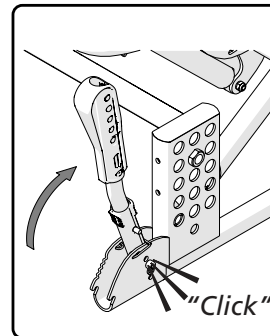
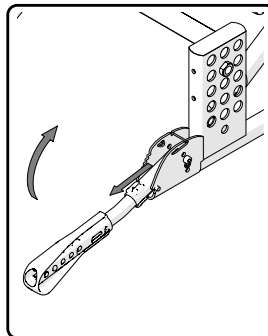

Tipping risk. Inactivated anti-tips will increase the risk of injury. Activate the anti-tips to avoid the risk of tipping.

**Tilter** is integrated in the frame

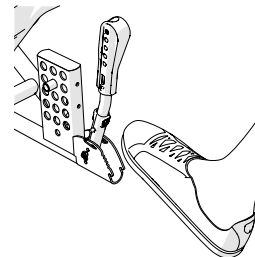

### Leg support, elevating

The leg support can be lifted/swung to the side as needed. The footplates can be folded and the calf support can be swung to the side.

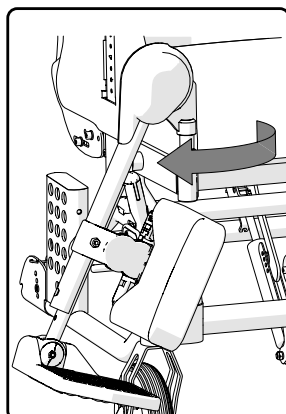
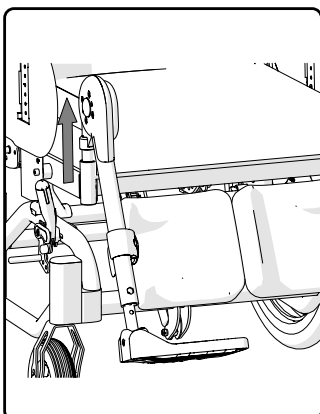

### Leg support angle

The leg support angle is adjustable in fixed positions. Set the angle by pressing down the button and lifting/lowering.



Do not lift the wheelchair by the leg supports. Risk of injury.

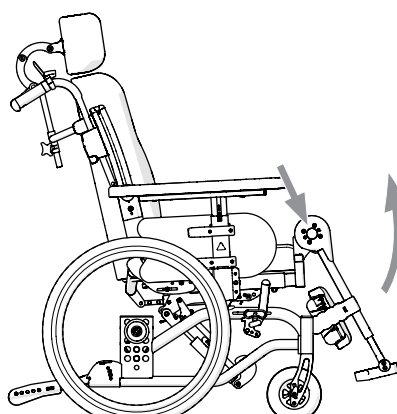

## 10. How to use

### The push handle/bow handle, height-adjustable

Loosen the knob for the push handle lock (A). Install desired height. Ensure that the push handle is in a "snap lock" position, tighten the knob.



Make sure the locking handles are properly locked and that the safety buttons have popped out below the brackets.

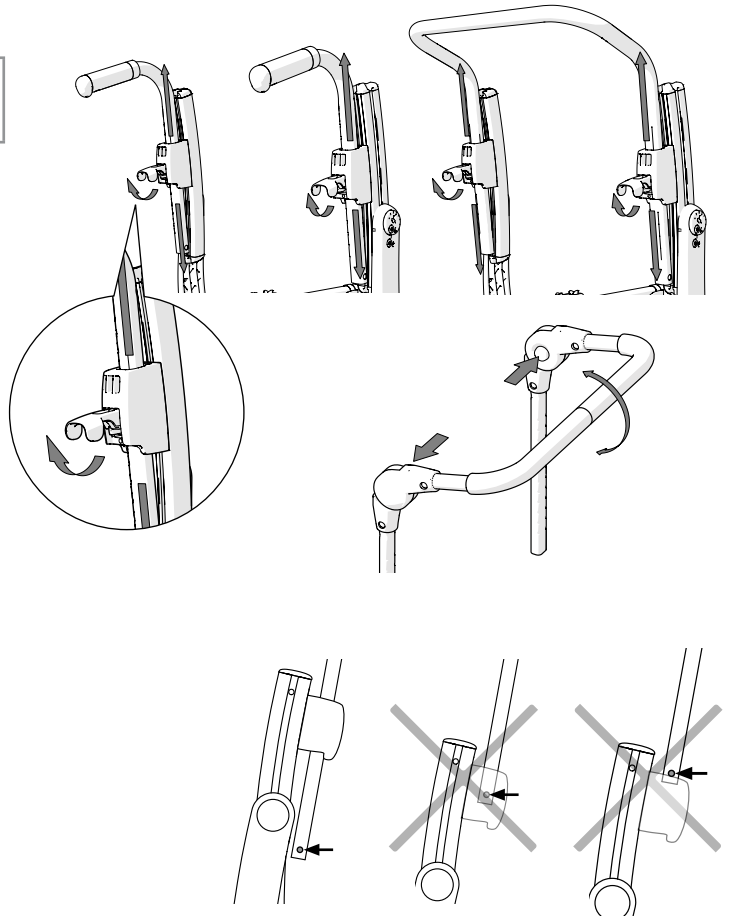

### Attendant brake (motion brake)

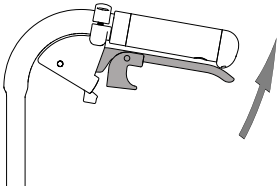

- Brake while in motion by pushing the brake handle upwards.

### Attendant brake (parking brake)

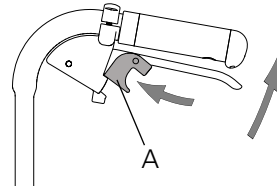

- Activate the parking brake by pressing the brake handle upwards and pressing button A.
- Loosen by pressing the handle upwards.



## 11. Seating comfort settings

### Seating comfort

Good seating comfort depends on the needs and possibilities available to each individual. The following general guidelines here show what to consider when settings are made.

### Back support upholstery

The back support upholstery is adjusted with the user sitting in the wheelchair.

- Make sure the user is sitting as far back in the seat as possible.
- Angle the back support so that the dynamic pelvic support is activated (see illustration).
- Support the pelvis by tightening the dynamic pelvic support belt. Remember that the belt is automatically loosened when the back support is tilted back (see illustration). The pelvic support belt is height-adjustable (see illustration).
- Then adjust the upper strap to provide the user with upper body support and balance.
- The other straps are adjusted to provide space for the user's posterior and follow the back's natural curvature.

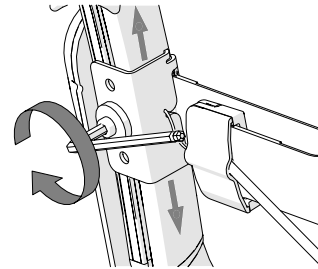
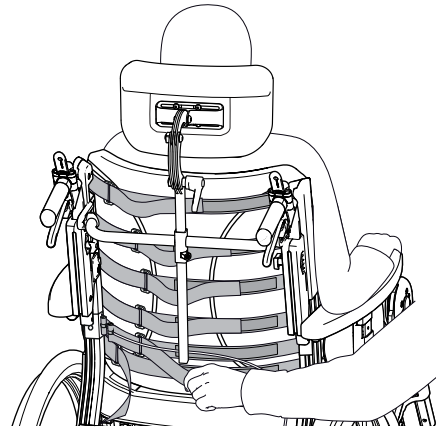

Tipping risk. Inactivated anti-tips will increase the risk of injury. Activate the anti-tips to avoid the risk of tipping.

### Dynamic pelvic support activated

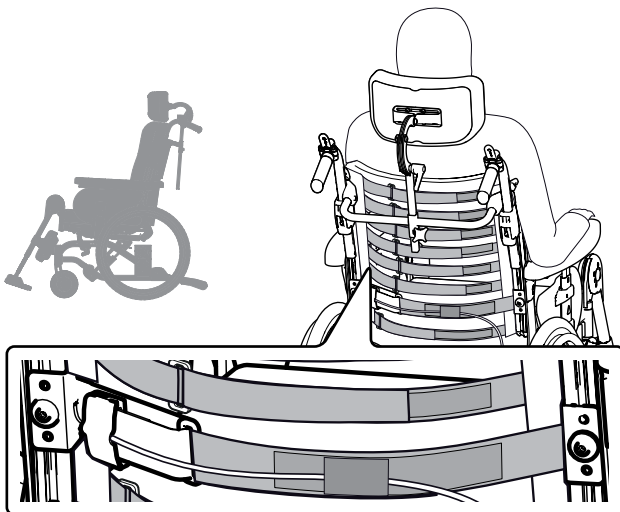

### Dynamic pelvic support deactivated

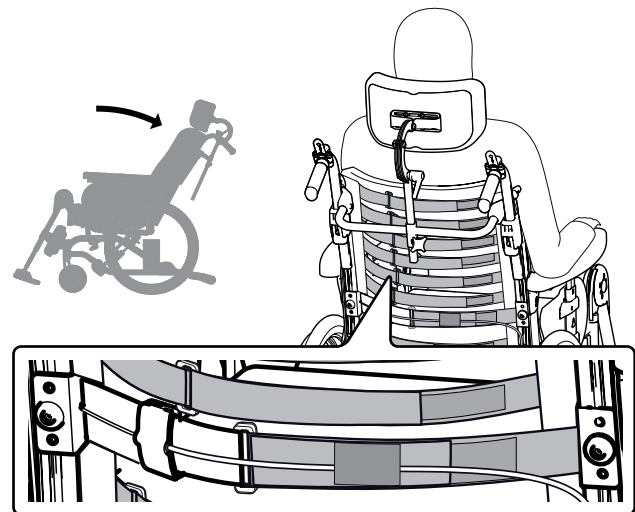

# 11. Seating comfort settings

## Head support

The head support is height, depth, side and angle-adjustable.



Tipping risk. Inactivated anti-tips will increase the risk of injury. Activate the anti-tips to avoid the risk of tipping.



Do not lift the wheelchair by the Head Support Attachment. Risk of injury.



It is easier to install screws and nuts when the head support is removed.

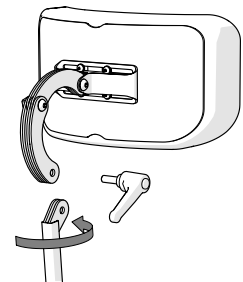
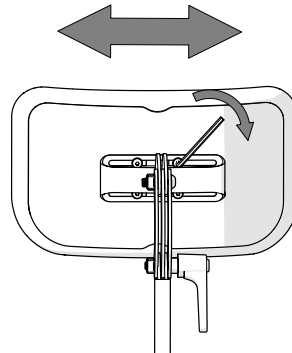
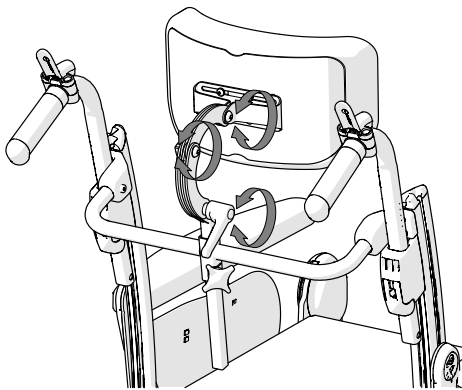
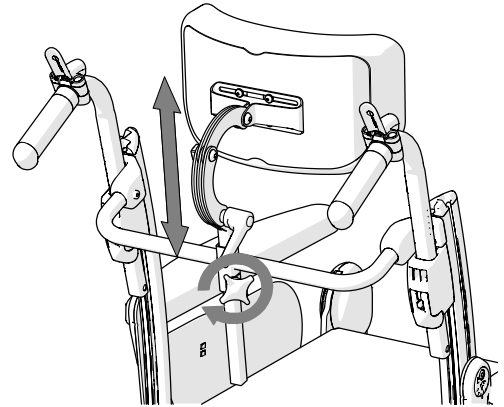

## Footplates

Adjust the height to support the feet and so that the thighs rest against the seat cushion.

For outdoor use the footplates should be raised 4 – 6 cm above the ground.



Do not stand on the foot plates. Risk of injury.

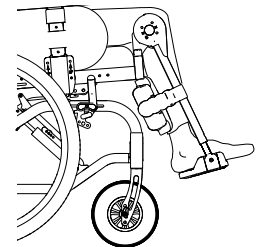

## Angle adjustment

Adjust the angle of the foot supports so that your ankles are at a 90° angle.

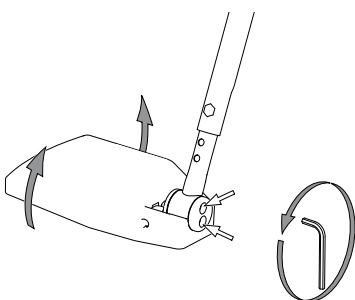

5 mm

## Adjusting the height

Fully loosen the locking handle on the leg support. Remove the screw. Set the height. Replace the screw and handle. Tighten securely.

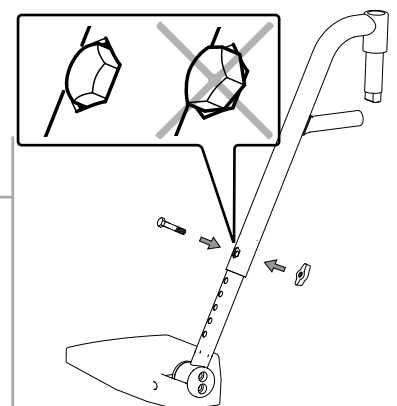
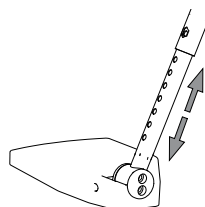
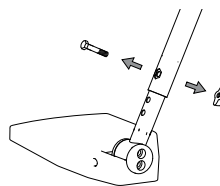



## 11. Seating comfort settings

### Changing the depth of the foot supports

Adjust the depth of the foot supports by switching the right and left foot support. Do not forget to adjust the angle.

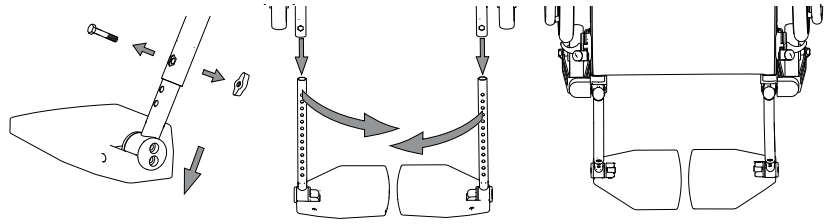

### Calf/heel strap

- Adjust the length so that the centre of the feet are placed on the footplates.

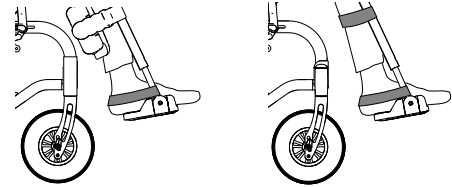

### Arm support (adjustment)

- Loosen the screw for height adjustment and move the arm support up or down to the desired height. Tighten the screws.
- Loosen the screws on the underside of the arm support cushion to adjust the length of the cushion.
- Correctly adjusted arm supports provide upper body support. The arm support plate should be approximately 5 mm taller than the elbow when bent at an angle of 90°.
- If necessary, the arm support attachment can be adjusted in height. (see section "Settings, readjustments").

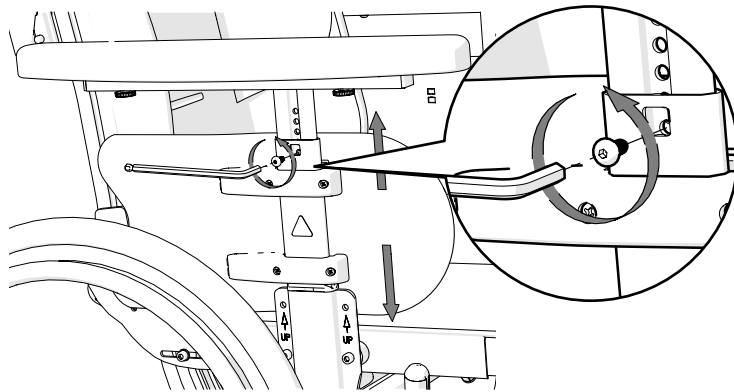

5 mm

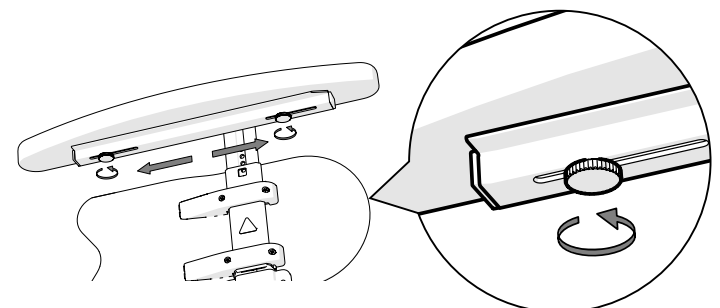
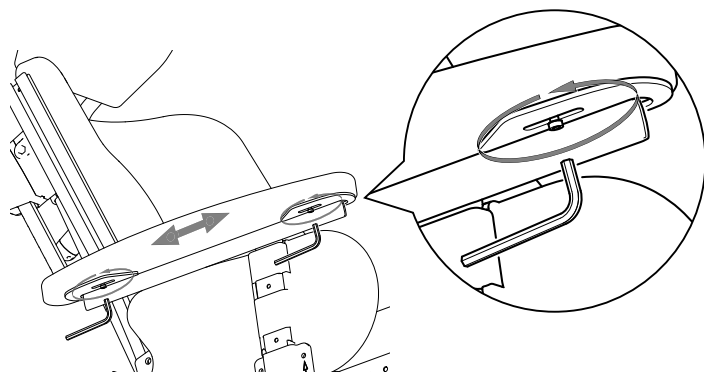

## 12. Driving technique, use



### Parking

Turn the castor wheels forward, apply the brakes.

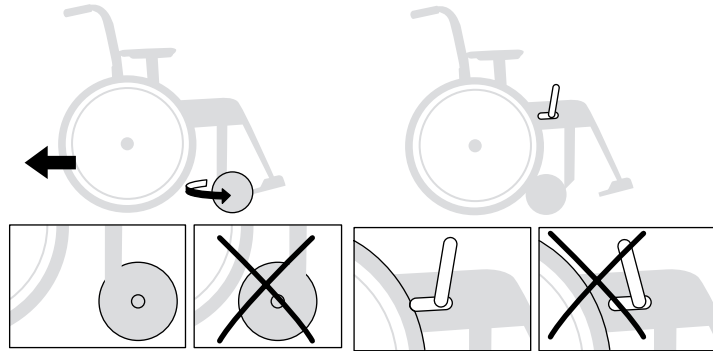

### Transferring to/from the wheelchair



Do not stand on the foot plates. Risk of injury.

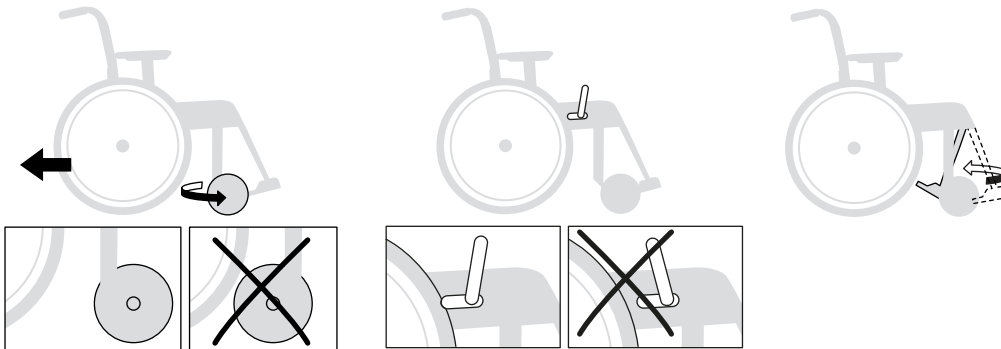

### Sideways

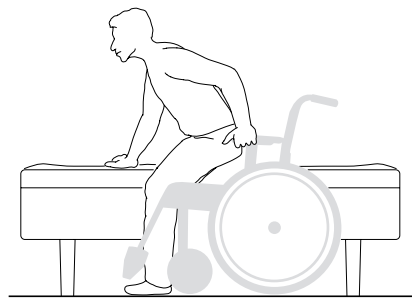
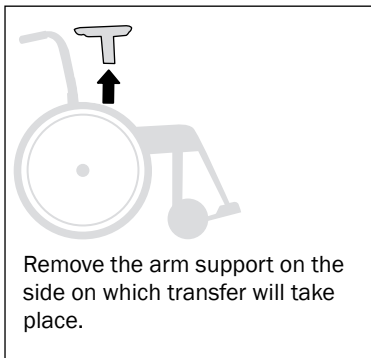

### From the front

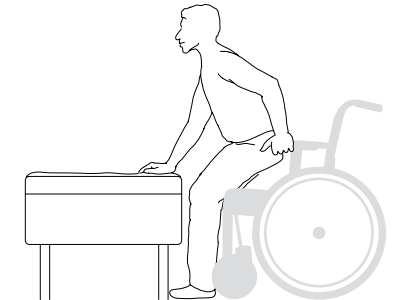

### Lifting the wheelchair

- Ensure that the vertically adjustable push handles are properly tightened.
- Swing the leg supports away and lift the wheelchair by the front upper part of the frame.

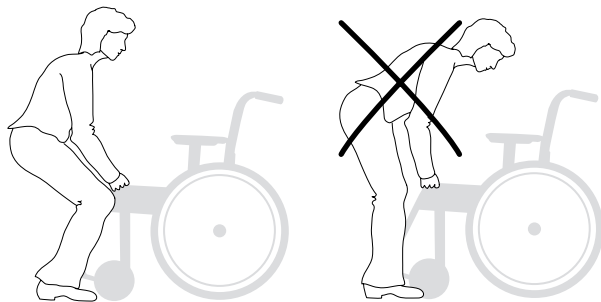

Do not lift the wheelchair by the Head Support Attachment. Risk of injury.



Do not lift the wheelchair by the leg supports. Risk of injury.

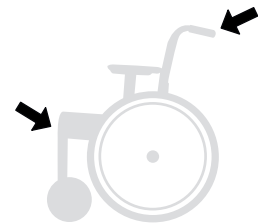



## 12. Driving technique, use



Tipping risk. Inactivated anti-tips will increase the risk of injury. Activate the anti-tips to avoid the risk of tipping.



### Carers, up forwards

- Ensure that the anti-tips are disabled.

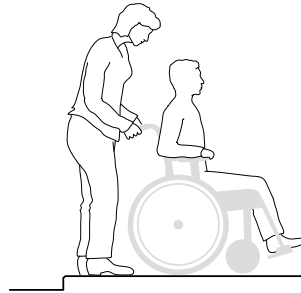
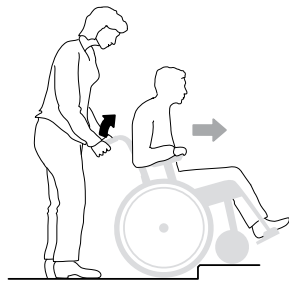
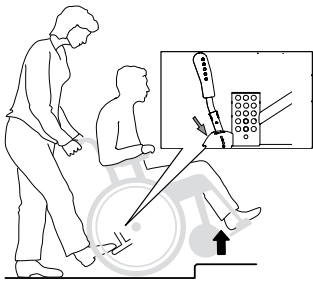

### Carers, up backwards

- Ensure that the anti-tips are disabled.

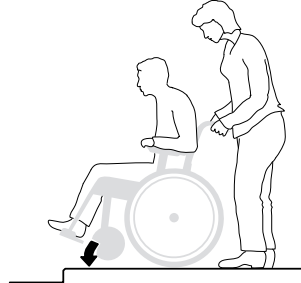
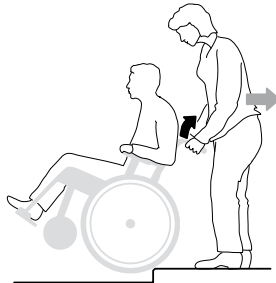
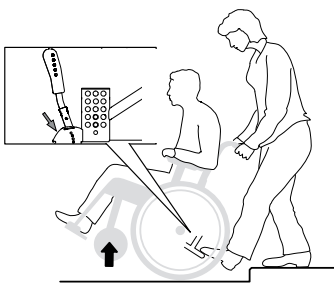

### Carers, down forwards

- Ensure that the anti-tips are disabled.

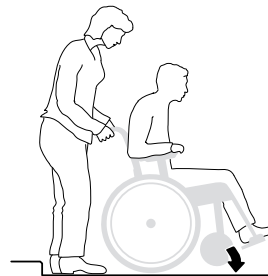
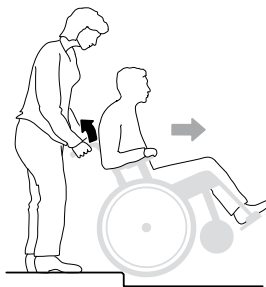
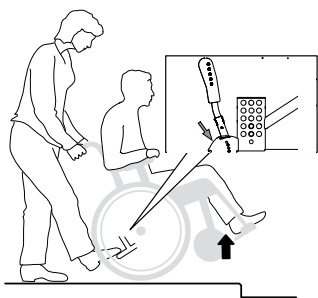

### Carers, down backwards

- Ensure that the anti-tips are disabled.

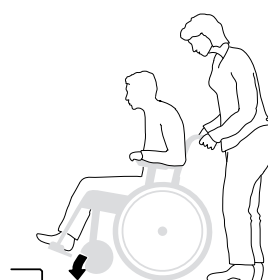
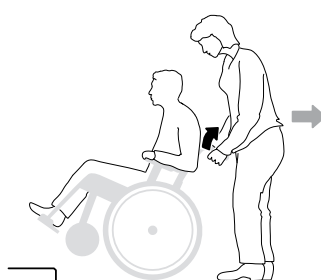
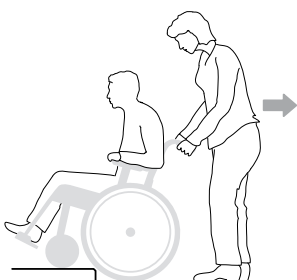

## 12. Driving technique, use



### Stairs, up

- Ensure that the anti-tips are disabled and that height-adjustable handles are securely tightened.

We recommend there always being two carers for this transfer. One walking behind and holding the push handle and one walking in front, holding the frame. Never use an escalator, even if a carer is available.

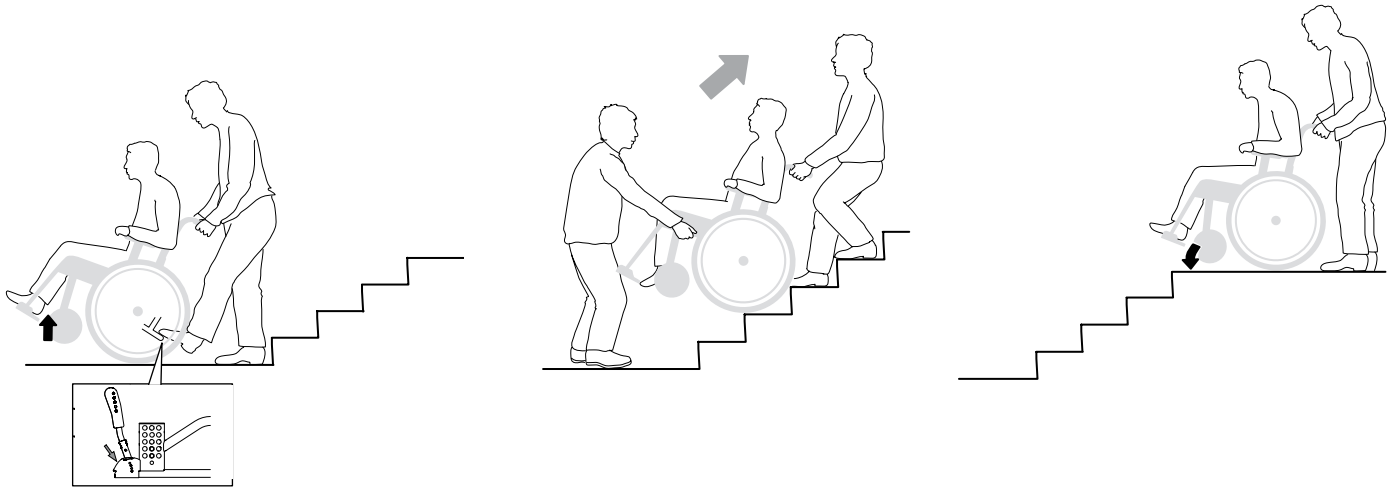

### Stairs, down

- Ensure that the anti-tips are disabled and that height-adjustable handles are securely tightened.

We recommend there always being two carers for this transfer. One walking behind and holding the push handle and one walking in front, holding the frame. Never use an escalator, even if a carer is available.

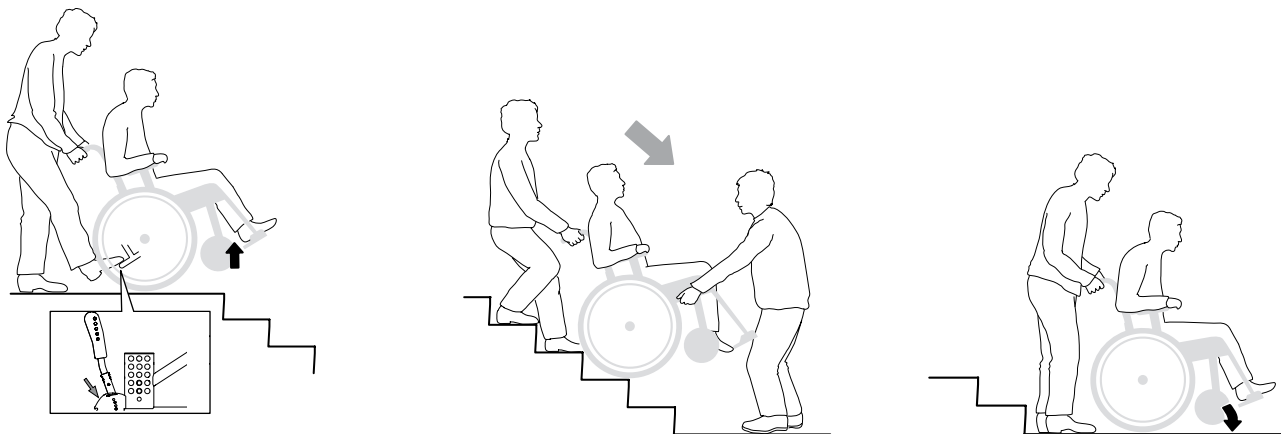

## 13. Removal of upholstery



### Back cushion

- The back cushion is removed and attached using the zipper.

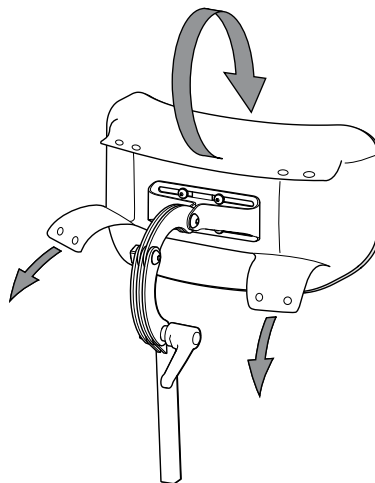
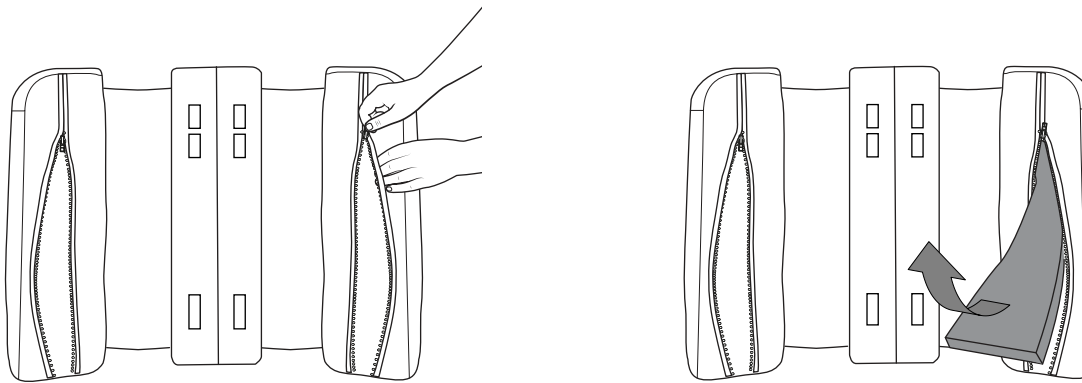
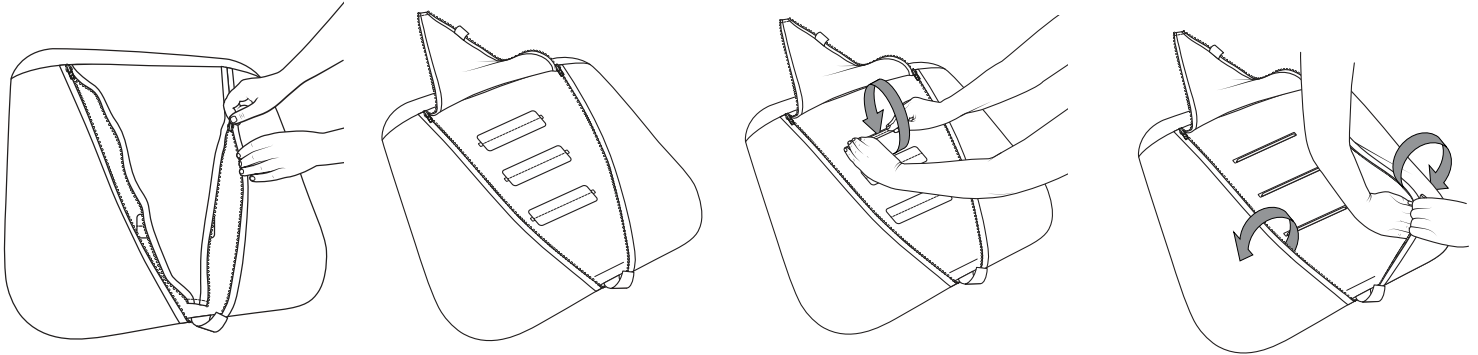



# 14. Advanced settings, adjustments

## Seat height

Seat height adjustable using:

- The rear wheel position in the frame and the castor position in the fork.
- Change of rear wheel size

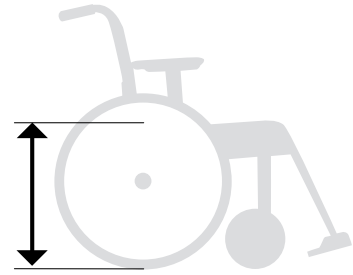

The chassis undercarriage must always be horizontal. When changing the seat height, the front seat height must also be adjusted. See Section "Height adjustment, front".



Tipping risk. Inactivated anti-tips will increase the risk of injury. Activate the anti-tips to avoid the risk of tipping.

**Seat height table 57 mm hub width**

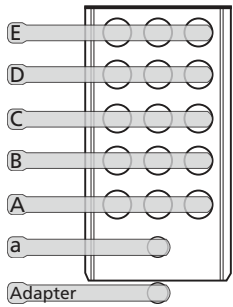

			Short fork								Medium fork															
			S1				S2				S3				M1				M2				M3			
Pos.		Seat height	6"	6"	6,5"	7"	8"	6"	6,5"	7"	8"	6"	6,5"	7"	8"	6"	6,5"	7"	8"	6"	6,5"	7"	8"			
E		20"	X																							
		22"	X	X	X										X	X										
		24"		X	X	X	X	X						X	X	X*	X									
D		20"	X	X	X									X	X											
		22"	X	X	X	X	X	X	X				X	X	X	X*	X	X	X							
		24"		X	X	X	X	X	X	X			X	X	X	X*	X	X	X	X	X					
C		20"	X	X	X	X	X	X	X					X	X	X	X*	X	X							
		22"		X	X	X	X	X	X	X				X	X	X	X*	X	X	X	X	X				
		24"					X	X	X	X							X*	X	X	X	X	X	X			
B		20"		X	X	X	X	X	X	X				X	X			X	X	X	X	X				
		22"					X		X	X							X*		X	X	X	X	X			
		24"								X								X	X	X	X	X	X			
		16"***	X	X									X													
A		20"					X		X	X	X					X*	X	X	X	X	X	X	X			
		22"									X								X	X	X	X	X			
		24"																			X	X	X			
		16"***	X	X	X	X	X	X									X*	X								
a		16"***		X	X	X	X	X	X	X				X	X	X	X*	X	X	X	X		X			
Ad.		16"***																					X			

\*Only 8 x 13/8" (200 x 35 mm), not 8 x 2" (200 x 50 mm)

\*\* Chair equipped with electrical recline function must have anti-crush guard fitted.



## 14. Advanced settings, adjustments

### Front forks and castor positions

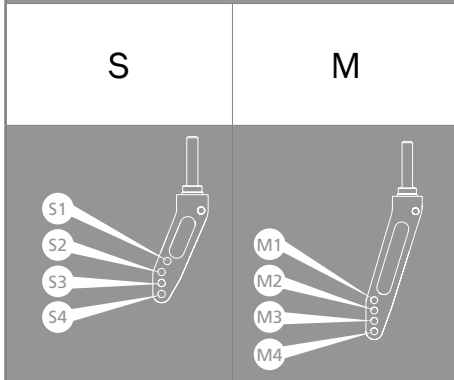

### Rear wheel positions

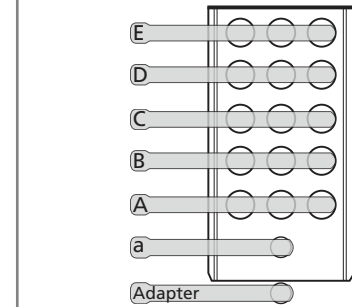

### Seat height table 45 mm hub width

	6"	8"	6"	8"	16"	20"	22"	24"
38	S2					E		
40	S2				B			
40.5	S2					D	E	
42.5	S2	S4	M2		A			E
43	S2	S4	M2			C	D	
45	S4	S4	M2	M1	a			D
45.5	S4	S4	M2	M1		B	C	
47.5		S4	M3	M1-M4				C
48		S4	M3	M1-M4		A	B	
50			M4	M4				B
50.5			M4	M4			A	
51.5				M4	Ad			
52.5				M4				A

Tolerance in the above measurements +/-10 mm  
More combinations may be possible.

# 14. Advanced settings, adjustments

## Changing the rear wheel position

1. Loosen the nut.
2. Open the kit with the washers and install at the required position (see table in Section "Seat height table").  
An adaptor sleeve should be used with 16" wheels in positions A2 and B2.
3. Adjust the castors/castor fork so that the chassis undercarriage is horizontal (see section "Height adjustment, front").

4. Adjust the user brake, see section "Brake, adjustment".



Tipping risk. Inactivated anti-tips will increase the risk of injury. Activate the anti-tips to avoid the risk of tipping.

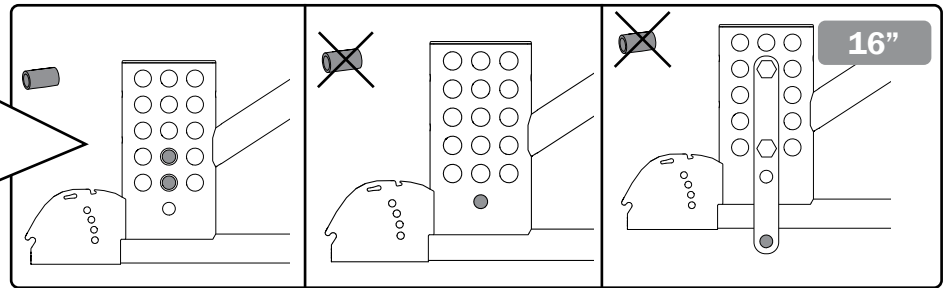
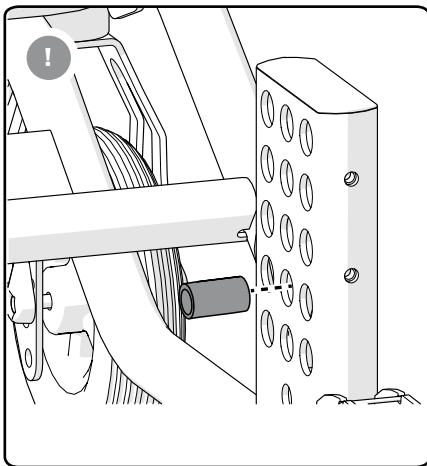
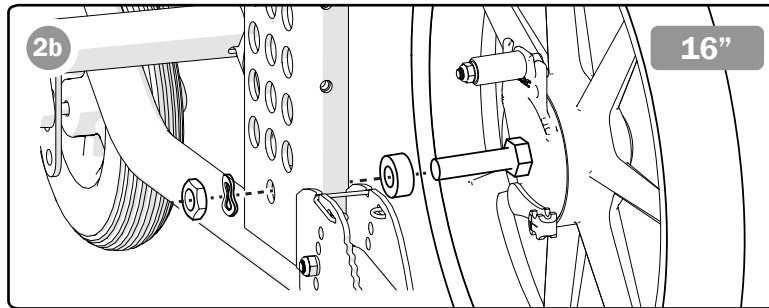
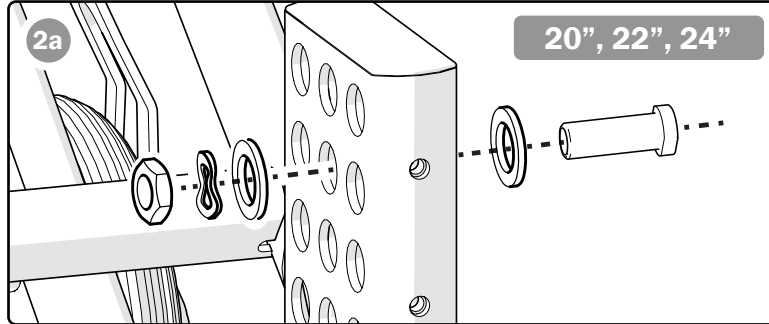
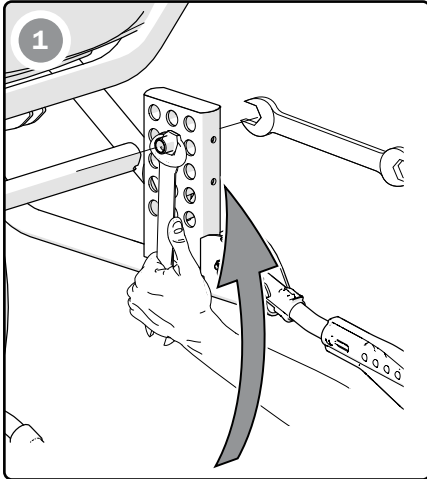

17 mm  
24 mm



14 Nm

During installation, make sure that the hubs end up in the same position on the right and left side.



When attaching the QR-axle make sure that the quick-release button fully returns. Test by pulling the axle. Risk of injury.

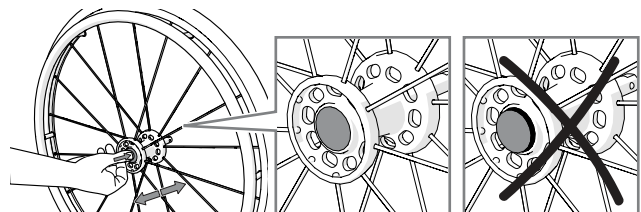
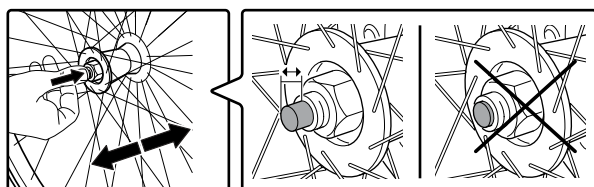
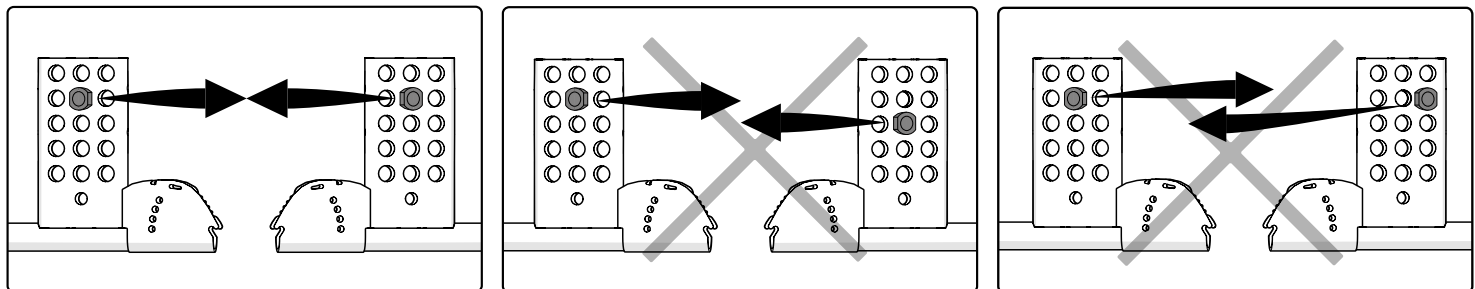



# 14. Advanced settings, adjustments

## Height adjustment front

The chassis undercarriage must always be horizontal. When adjusting the seat height, it is therefore also necessary to adjust the castor wheel position in the fork or change the castor/fork (see Section "Seat height table").

## Height adjustment front fork housing

Loosen the screw that holds the front fork housing and adjust the height so that the lower tube of the chassis is parallel to the floor. Tighten the screw again.



Tipping risk. Inactivated anti-tips will increase the risk of injury. Activate the anti-tips to avoid the risk of tipping.



Tipping risk. Inactivated anti-tips will increase the risk of injury. Activate the anti-tips to avoid the risk of tipping.

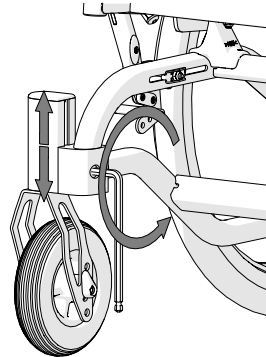

6 mm



20 Nm

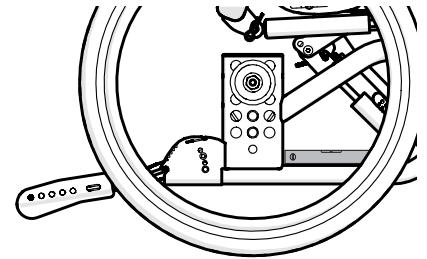

## Disassembly/assembly of the castor wheel

Loosen screw, nut and spacers and mount the wheel in correct position.



Tipping risk. Inactivated anti-tips will increase the risk of injury. Activate the anti-tips to avoid the risk of tipping.

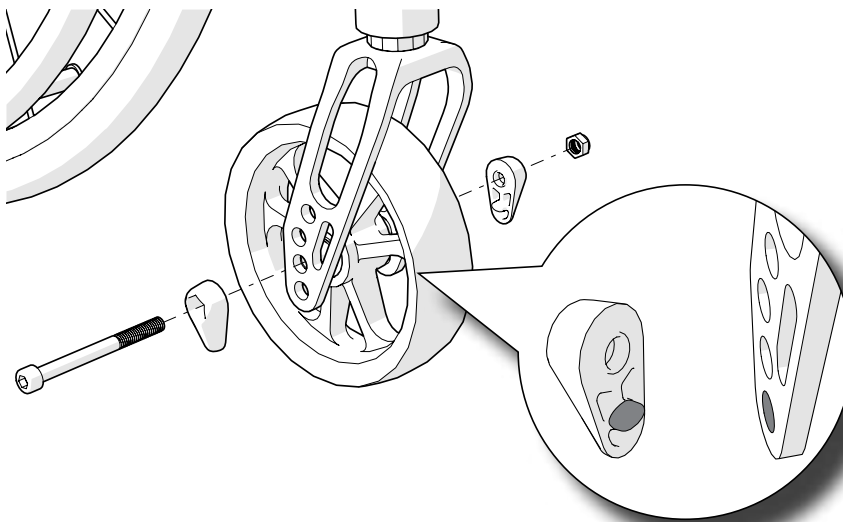

5 mm

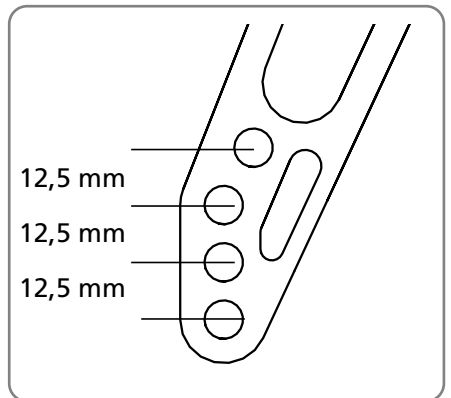

## Disassembly/assembly of the front fork

1. Remove the nut cover and disassemble/assemble the front fork with the castor wheel in accordance with the illustration.

NB! It is important to ensure that the ball bearings and washers in the attachment (under the retaining nut) are placed in the right order with the spring washer on top.

During installation, tighten the retaining nut until it comes to a stop and then release by 1/2 - 1 turn. The spring washer then has the correct tension and reduces the risk of the castor starting to "wobble".



Tipping risk. Inactivated anti-tips will increase the risk of injury. Activate the anti-tips to avoid the risk of tipping.

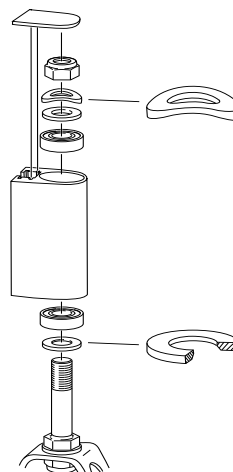

19 mm

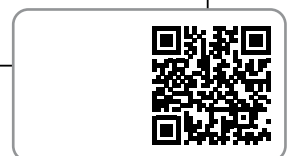
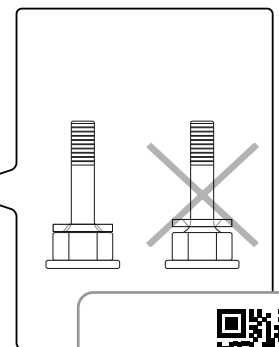

# 14. Advanced settings, adjustments

## Seat height adjustment with attendant brake

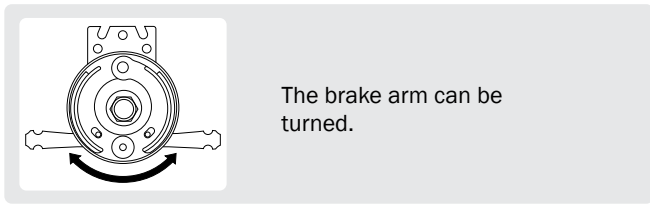
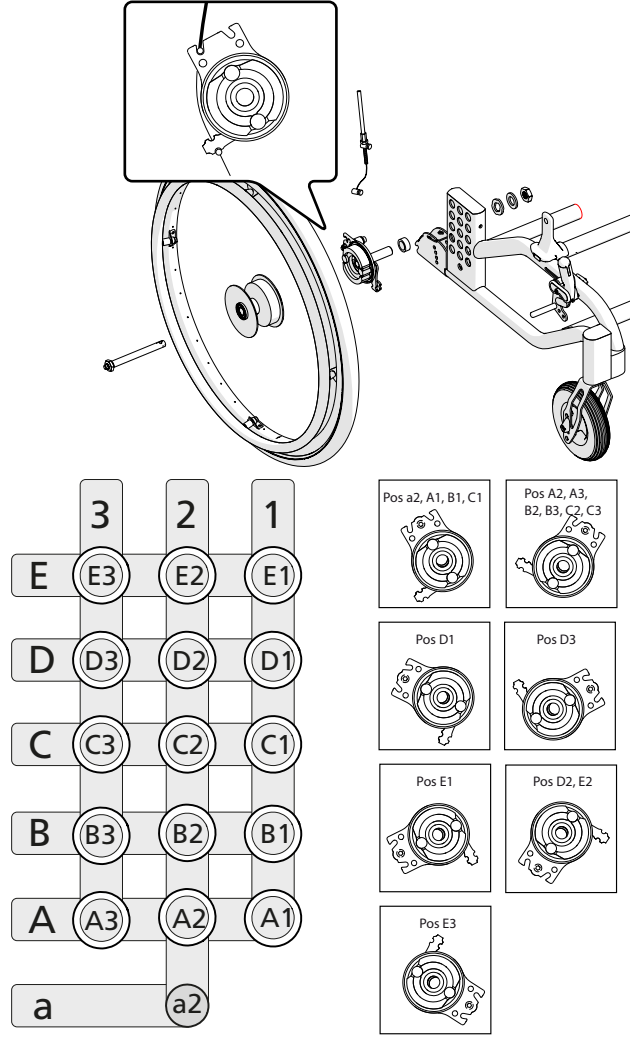
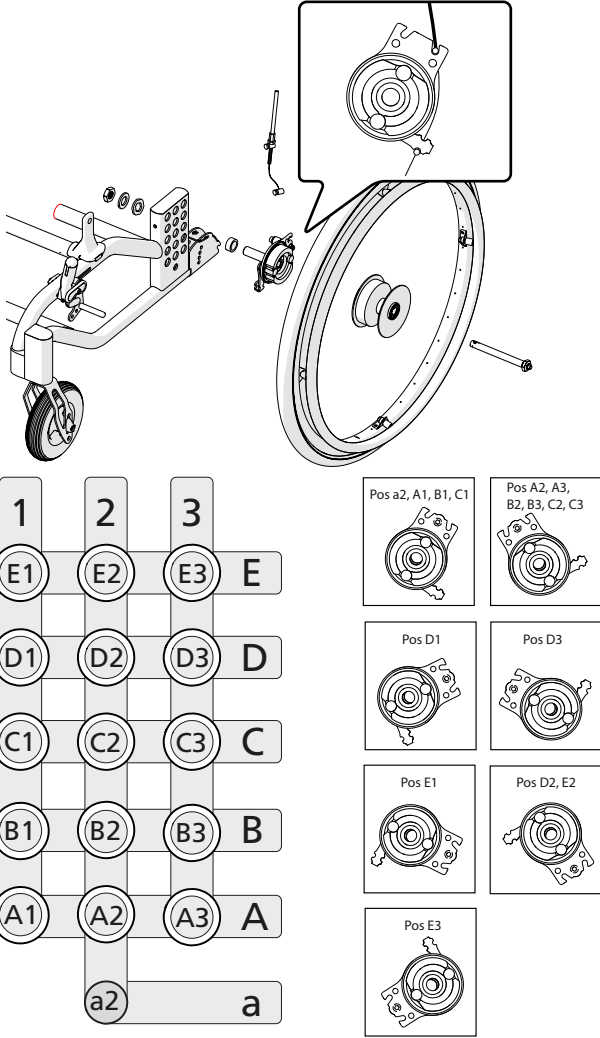

When adjusting the brake loosen nut (A) and adjust the brake by moving (B) up/down.  
 When the brake has a reasonable effect tighten nut (A).  
 This adjustment should be carried out when the brake is not functioning satisfactorily.

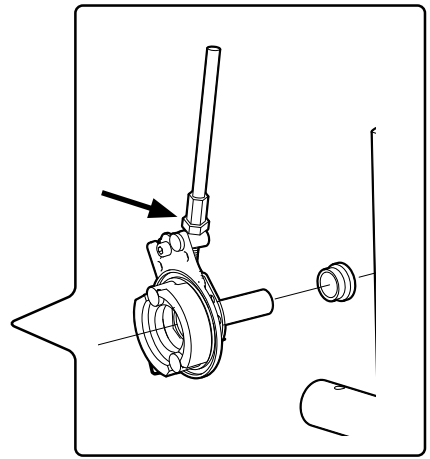
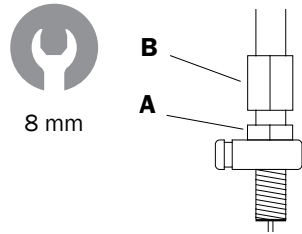

# 14. Advanced settings, adjustments



## Adjust the back support height and lumbar angle

The back support height is settable (see "The chairs options").

1. Loosen the locking screws (A) a maximum of 1 turn.
2. Adjust the back support height using the scale and marking on the lower back rail. Tighten the locking screws max. 1/2 turn.
3. Insert the Allen key in the eccentric sleeve locking screw and loosen it 1/2 turn. Move the Allen key to the key grip of the eccentric sleeve and set the desired lumbar angle.

4. Tighten the locking screws.



Tipping risk. Inactivated anti-tips will increase the risk of injury. Activate the anti-tips to avoid the risk of tipping.

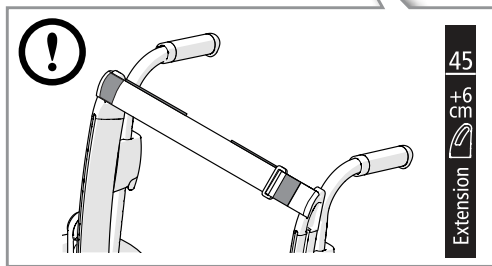
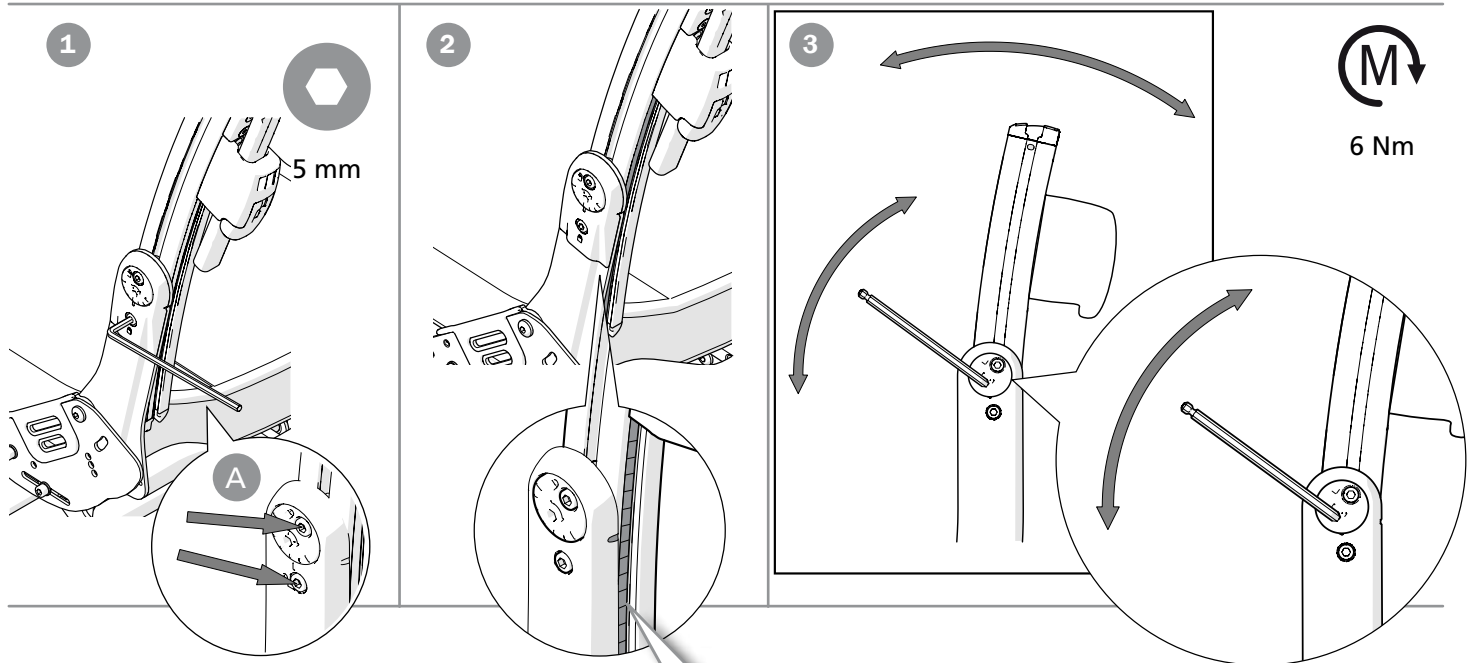

## Back angle limitation

The back supports angular range forward can be limited to 10° by fitting a screw according to illustration.



Tipping risk. Inactivated anti-tips will increase the risk of injury. Activate the anti-tips to avoid the risk of tipping.



2.5 mm



7 mm

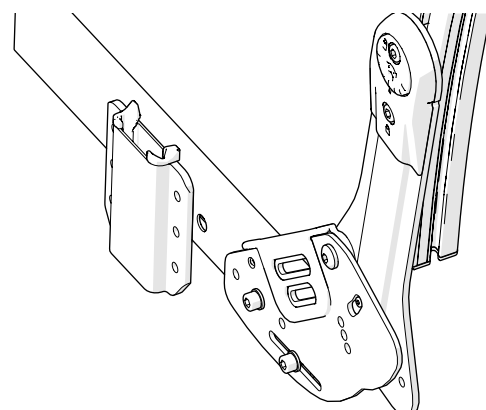
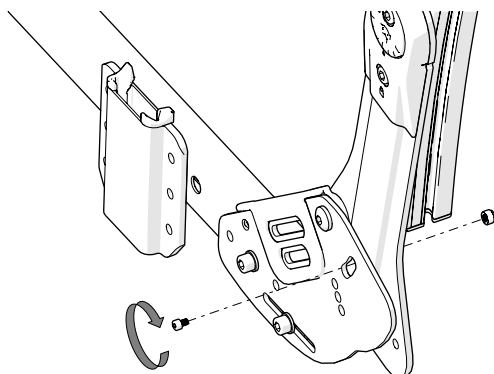



## 14. Advanced settings, adjustments

### Seat depth, front

1. Loosen the screws on both sides of the seat.
2. Adjust the seat depth by pulling the seat out or by pushing it in.
3. The front seat depth can be adjusted by up to 7 cm. Do not pull the seat out further than the "max. line".
4. Tighten the retaining screws.



Tipping risk. Inactivated anti-tips will increase the risk of injury. Activate the anti-tips to avoid the risk of tipping.



5 mm

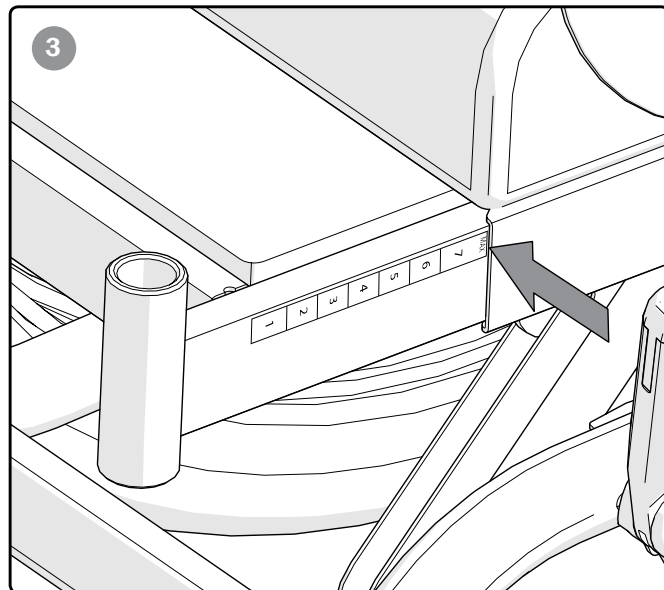
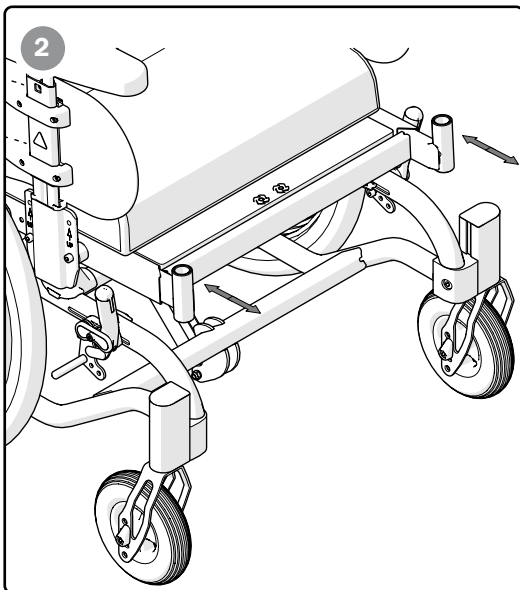
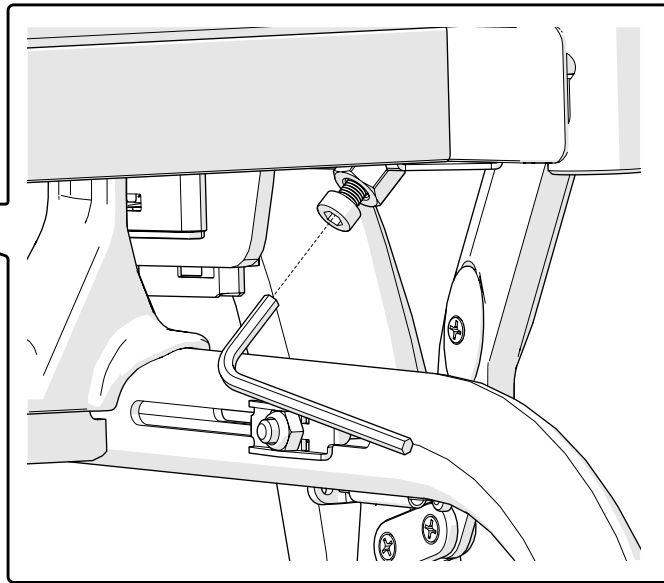
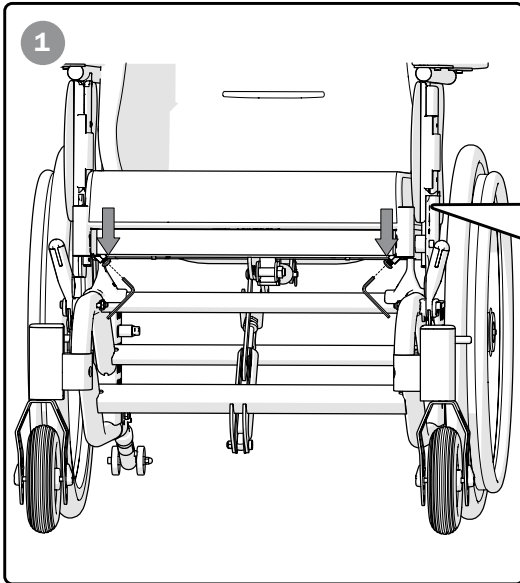



# 14. Advanced settings, adjustments

## Seat depth rear manual recline function

The seat depth can be adjusted in three fixed positions by epositioning the back chassis and the rear seat plate.

1. Tilt the back support upwards.
2. Tilt the seat as far back as possible and remove the seat cushion.
3. Remove the leg supports. Loosen the screws and remove the front seat frame.



Tipping risk. Inactivated anti-tips will increase the risk of injury. Activate the anti-tips to avoid the risk of tipping.



Remember that the wheel positions might also need to be re-adjusted to achieve correct balance in the chair.



13 mm



5 mm

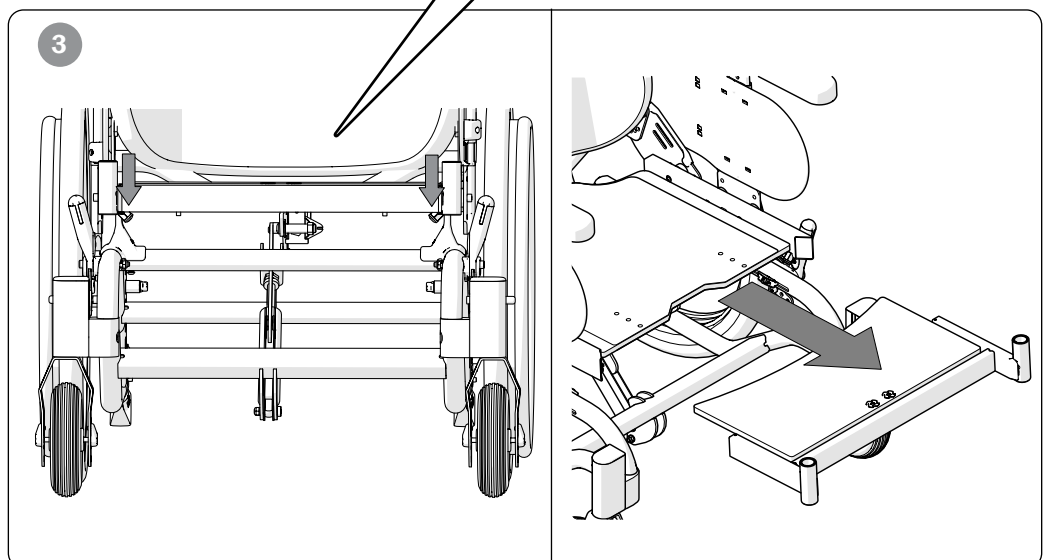
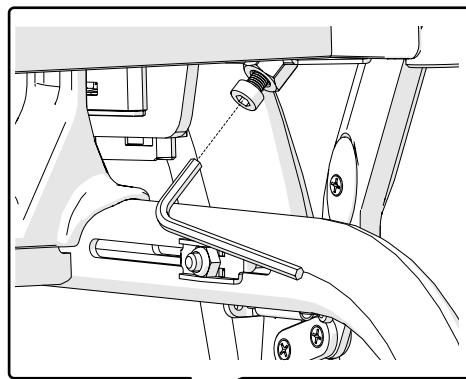
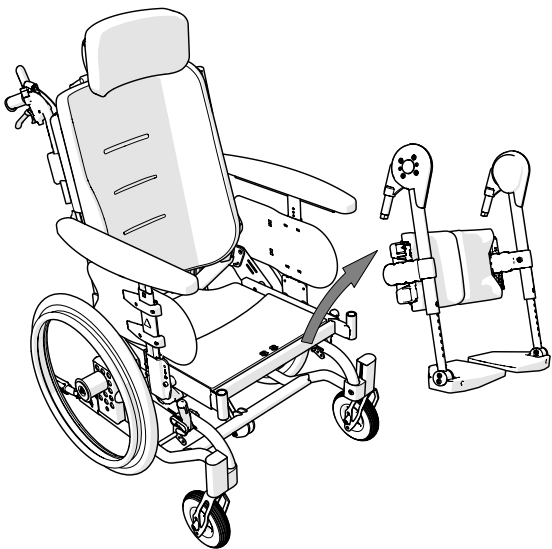
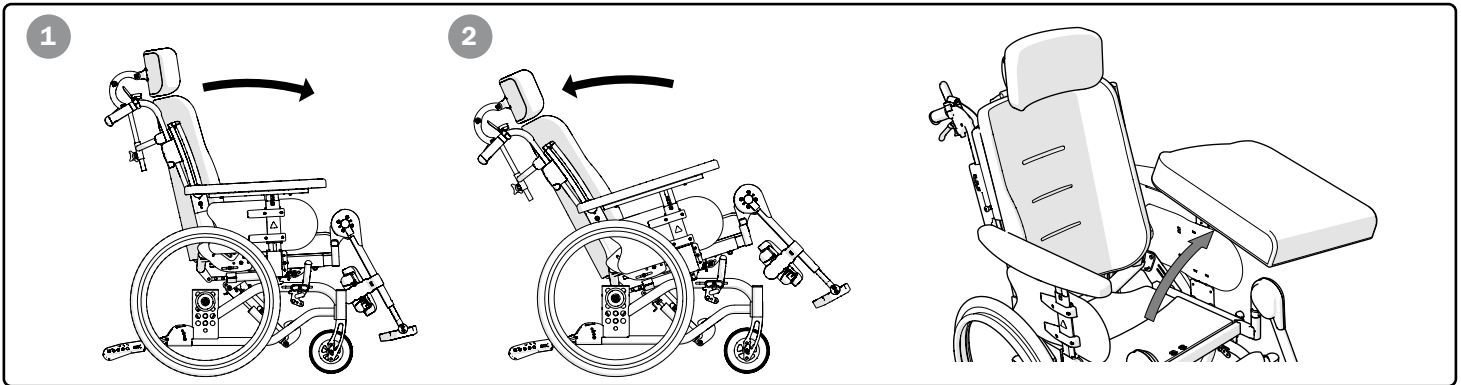

## 14. Advanced settings, adjustments

4. Remove the rear wheels (not 16"). Remove the arm support and fold the back support forward by loosening the gas piston.
5. Loosen the screws on the side plates by approx. 1-2 turns. Loosen and remove the screws which hold the side plates in place. Support the back chassis while the screws are loosened. Reposition to the required seat depth, insert and tighten the screws (see illustrations in section "Gas piston attachment").



Tipping risk. Inactivated anti-tips will increase the risk of injury. Activate the anti-tips to avoid the risk of tipping.



13 mm



5 mm

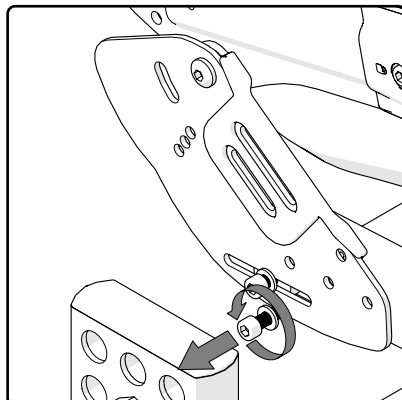
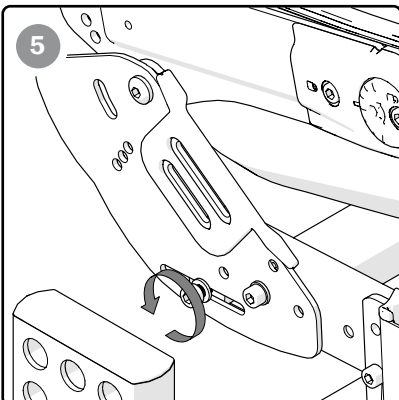
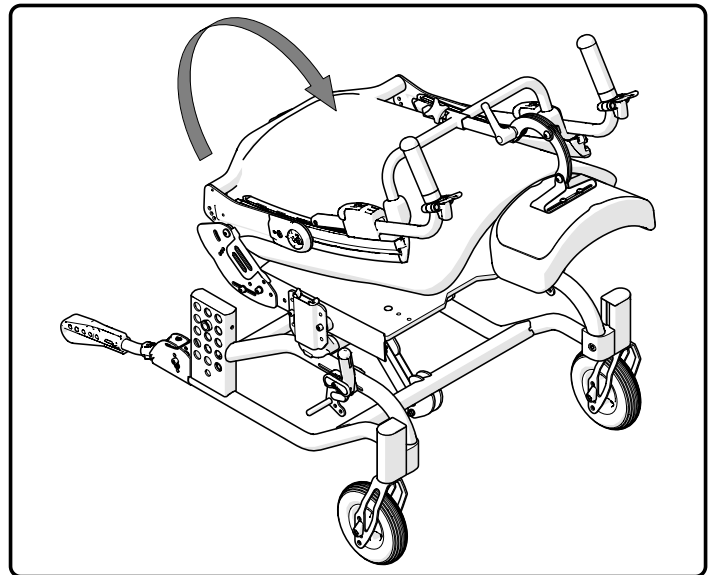
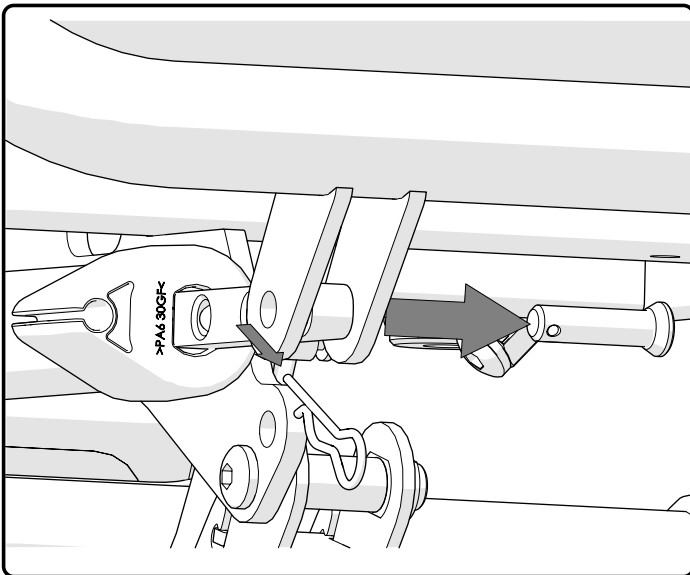
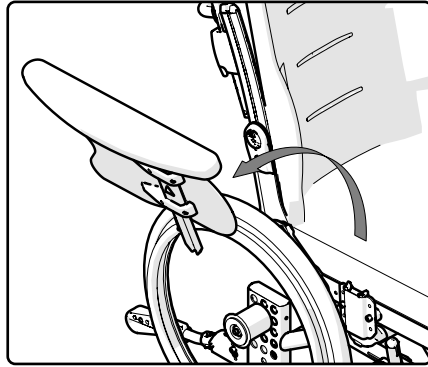
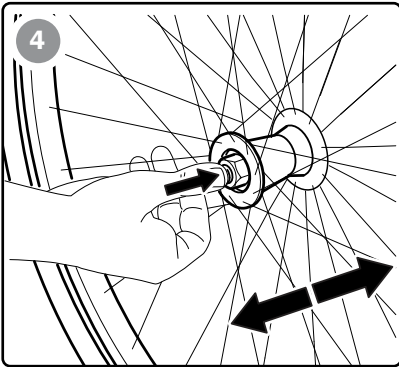

## 14. Advanced settings, adjustments



6. Secure the gas spring in accordance with the illustrations in section "Gas piston attachment". NB! If fitted into the wrong hole, the back support adjustment will not function correctly.
7. Fit the seat plates in accordance with the illustrations in section "Gas piston attachment". Mount the front seat frame.
8. Fit rear wheels, arm support and seat cushion.
9. Engage the anti-tips and check the seat and back angling function.



Tipping risk. Inactivated anti-tips will increase the risk of injury. Activate the anti-tips to avoid the risk of tipping.

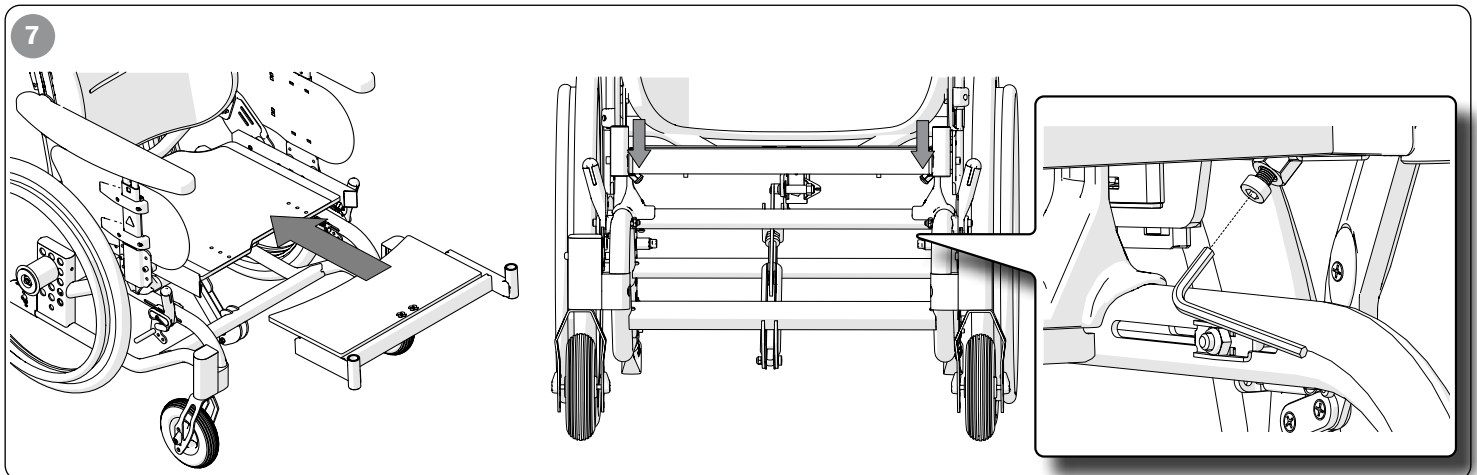
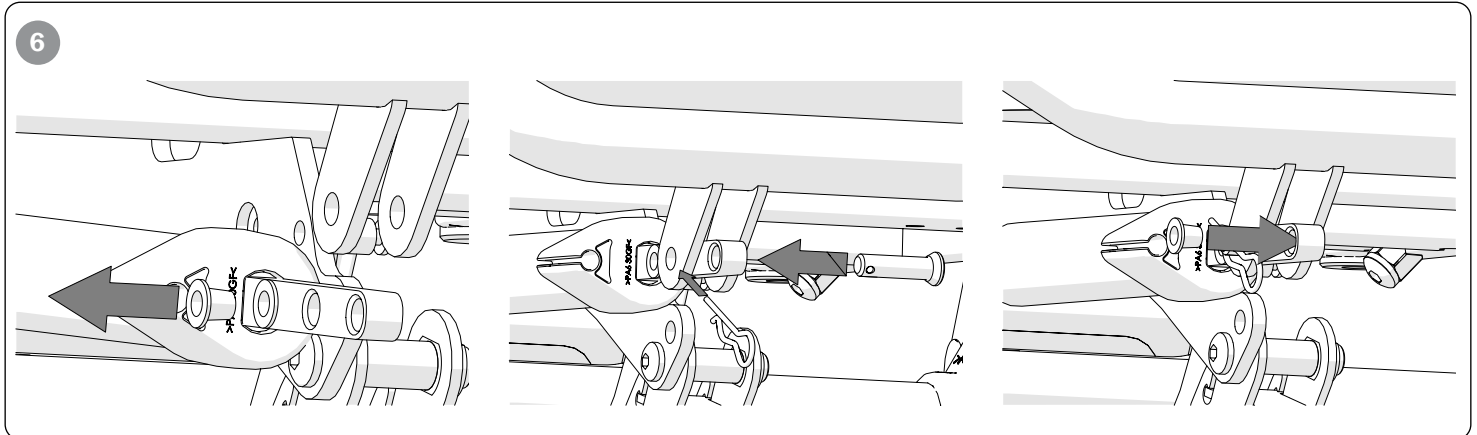



## 14. Advanced settings, adjustments

### Gas piston attachment

Short seat depth 39-46 cm

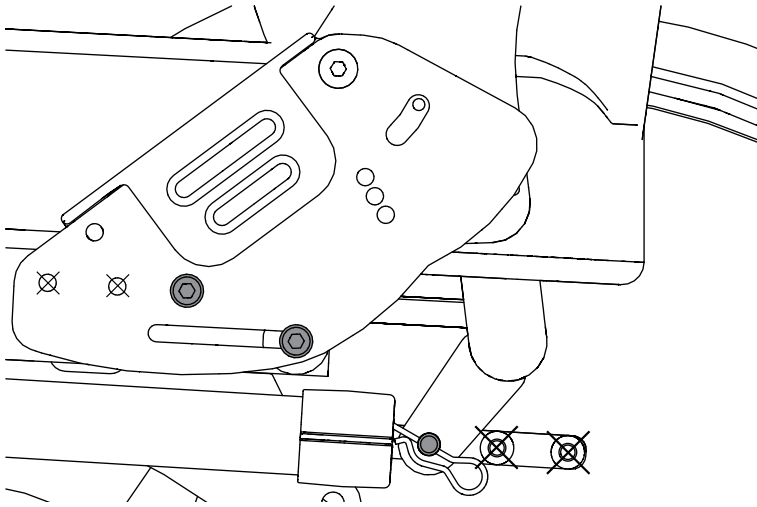

Screw positions seat plates

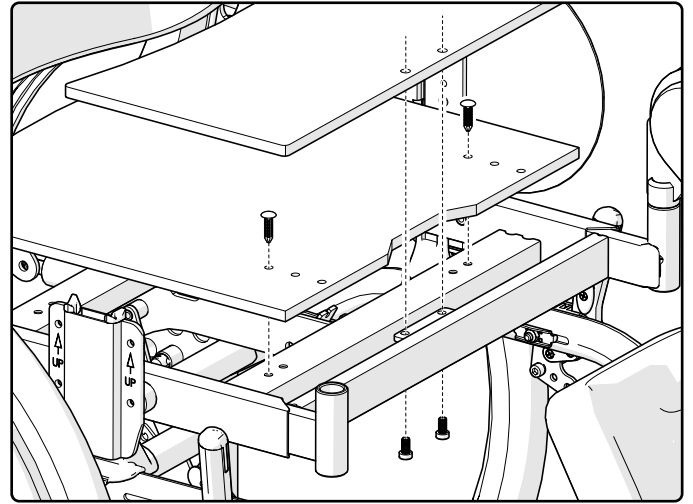

Medium seat depth 41.5-48.5 cm

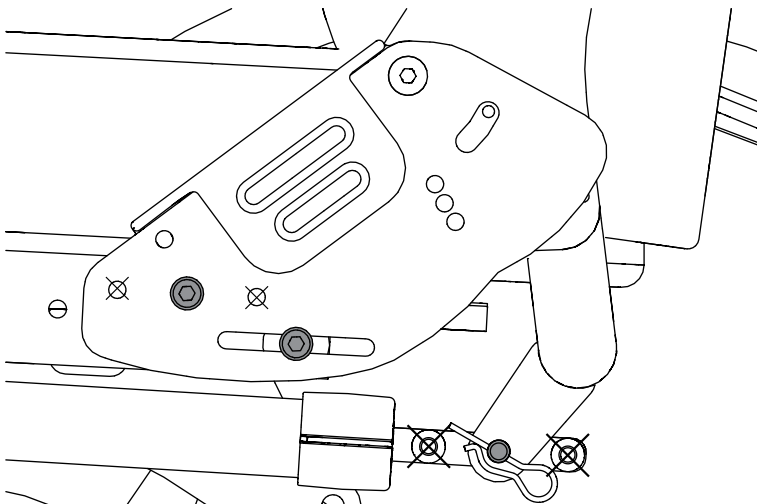

Screw positions seat plates

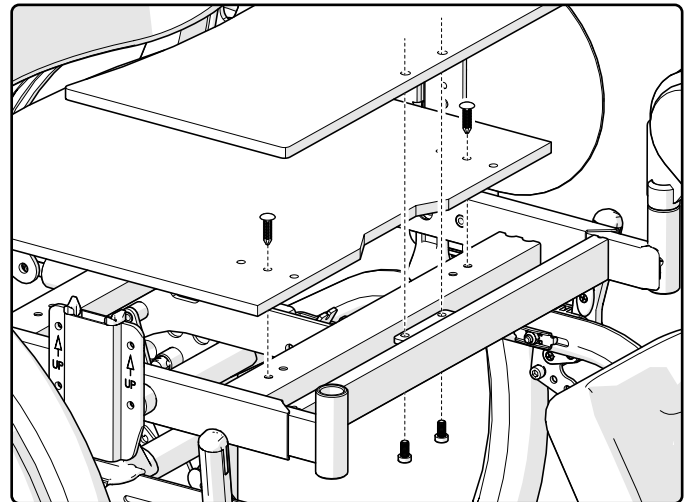

Long seat depth 44-51 cm

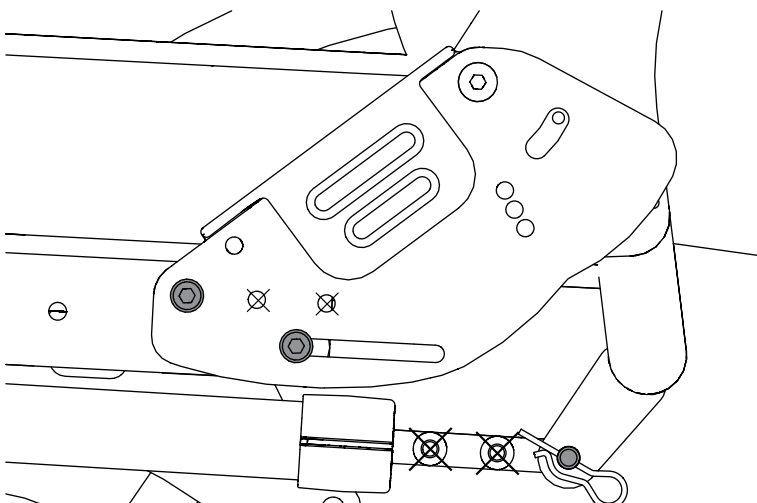

Screw positions seat plates

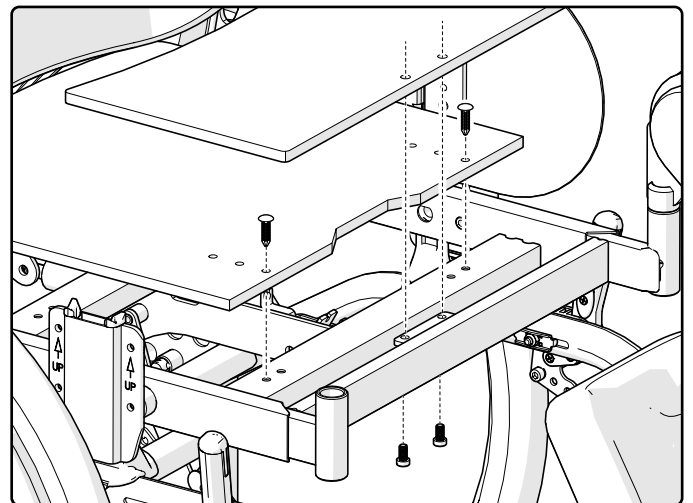



# 14. Advanced settings, adjustments

## Seat depth rear, electrical recline function

The seat depth can be adjusted in three fixed positions by repositioning the back chassis and the rear seat plate.

1. Tilt the back support upwards.
2. Tilt the seat as far back as possible and remove the seat cushion.
3. Remove the leg supports. Loosen the screws and remove the front seat frame.
4. Fold up the anti-tips.



Tipping risk. Inactivated anti-tips will increase the risk of injury. Activate the anti-tips to avoid the risk of tipping.



Remember that the wheel positions might also need to be re-adjusted to achieve correct balance in the chair.



13 mm



5 mm

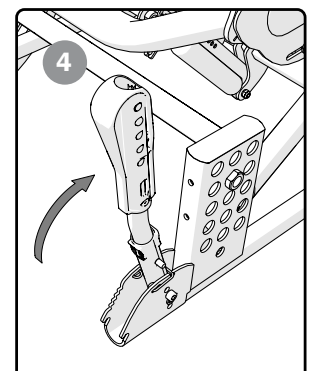
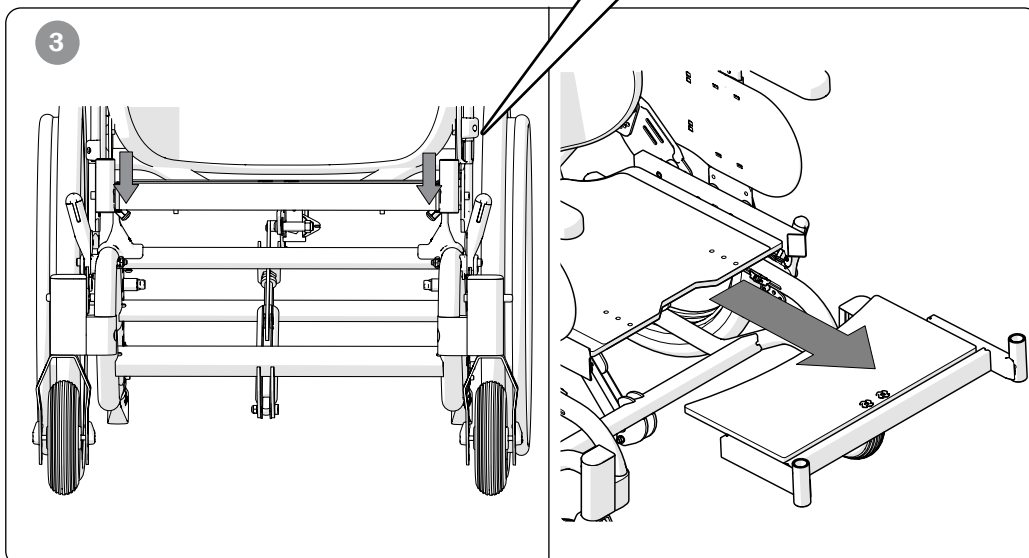
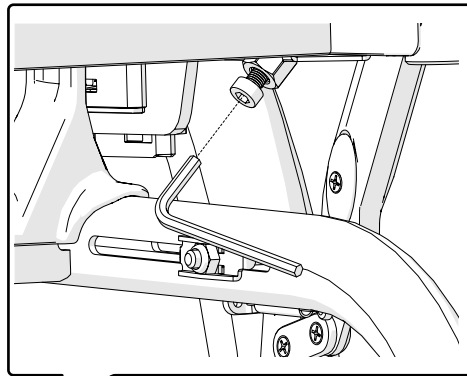
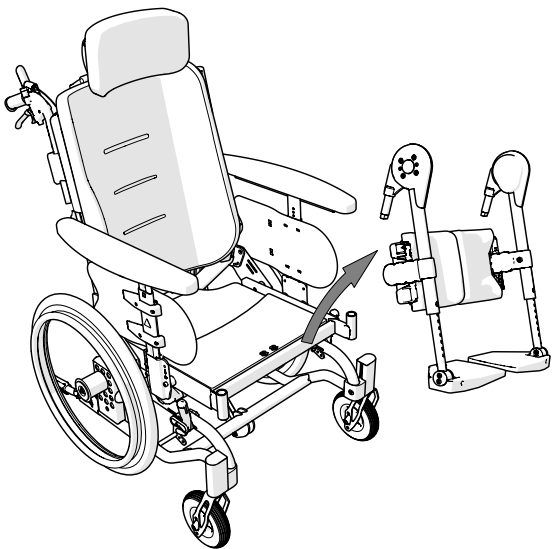
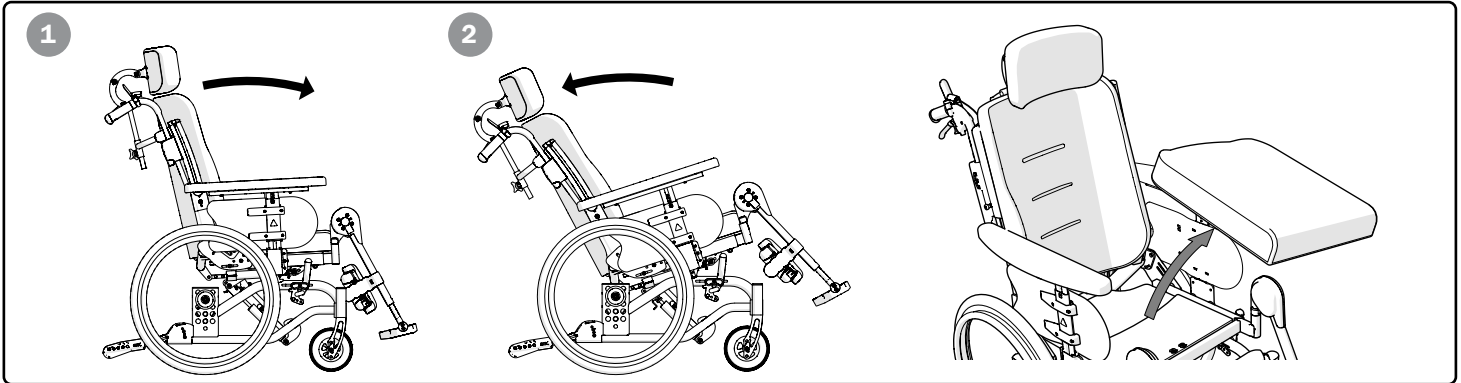

## 14. Advanced settings, adjustments

5. Remove the rear wheels (not 16"). Remove one arm support and lock the back support angle using a screw driver, an Allen key or similar (later adjust the back support angle to align correctly with the hole).
6. Lie the chair down on its "back". Loosen the screw next to the gas piston's front attachment.
7. Loosen the screws on the side plates by approx. 1-2 turns. Loosen and remove the screws which hold the side plates in place. Support the back chassis while the screws are loosened. This will prevent the gas piston being damaged. Reposition to the required seat depth, insert and tighten the screws (see illustrations in section "Screw positions for rear seat depth, electrical recline function").



Tipping risk. Inactivated anti-tips will increase the risk of injury. Activate the anti-tips to avoid the risk of tipping.



13 mm



5 mm

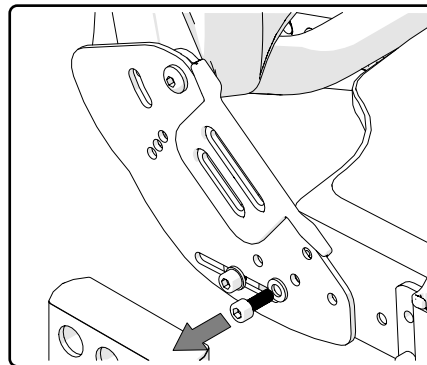
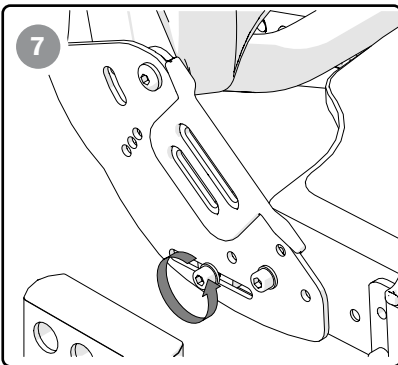
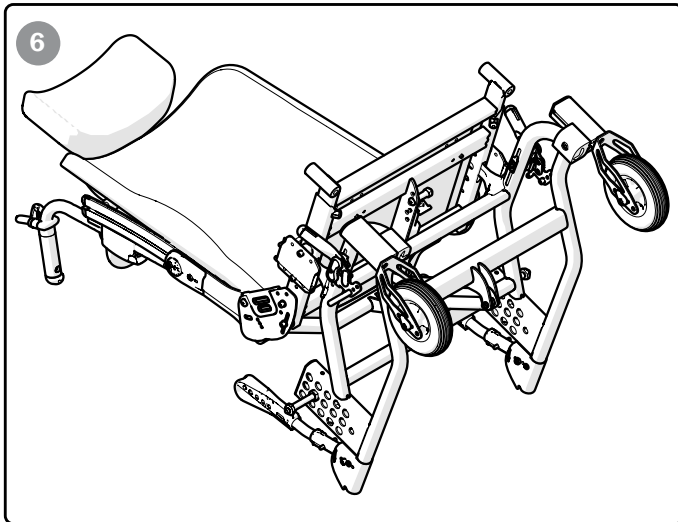
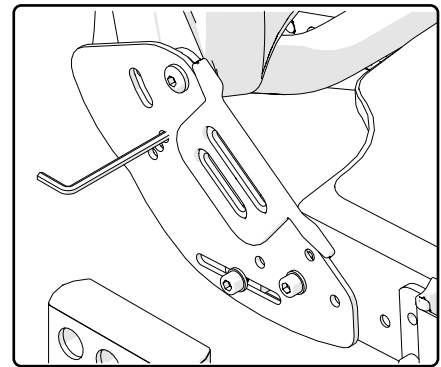
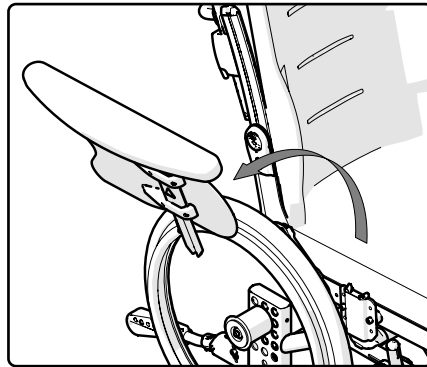
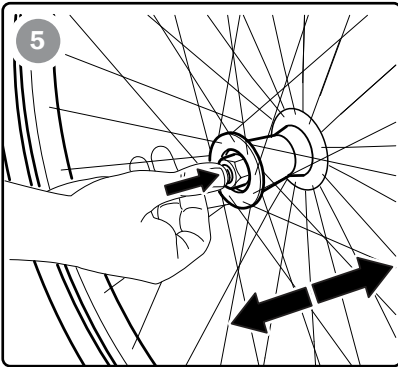



## 14. Advanced settings, adjustments

8. Secure the gas spring in accordance with the illustrations in section "Screw positions for rear seat depth, electrical recline function". Do not forget the washer in between. NB! If fitted into the wrong hole, the back support adjustment will not function correctly.
9. Raise the chair up and remove the Allen key used to lock the back support angle.
10. Fit the seat plates in accordance with the illustrations in section "Screw positions for rear seat depth, electrical recline function".
11. Fit rear wheels, arm support and seat cushion.

12. Engage the anti-tips and check the seat and back angling function.



Tipping risk. Inactivated anti-tips will increase the risk of injury. Activate the anti-tips to avoid the risk of tipping.

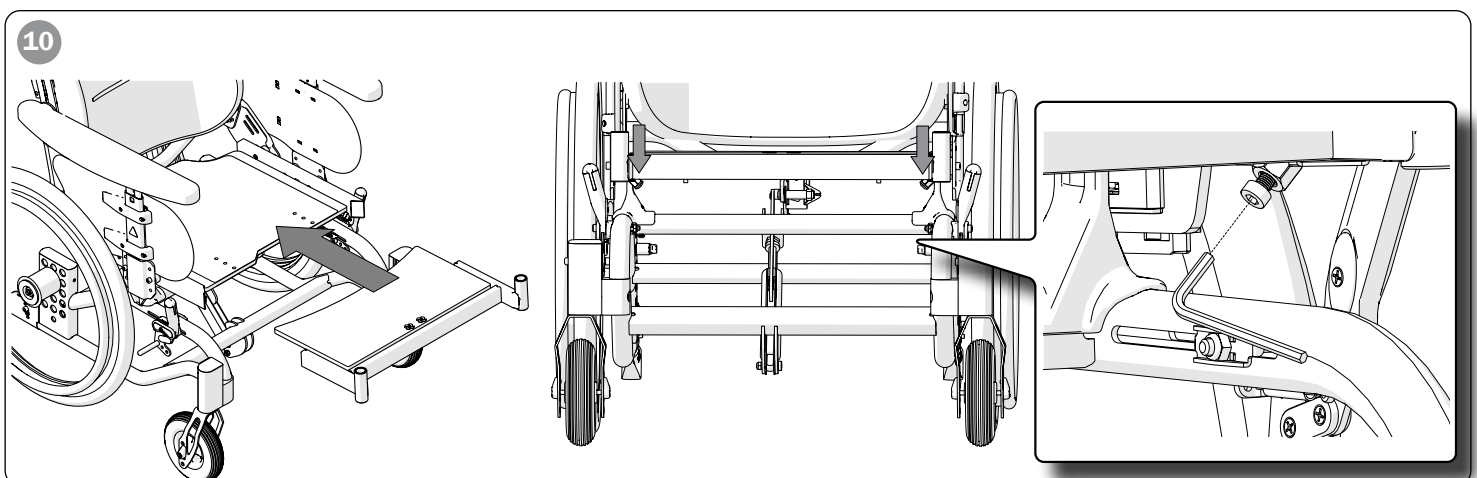
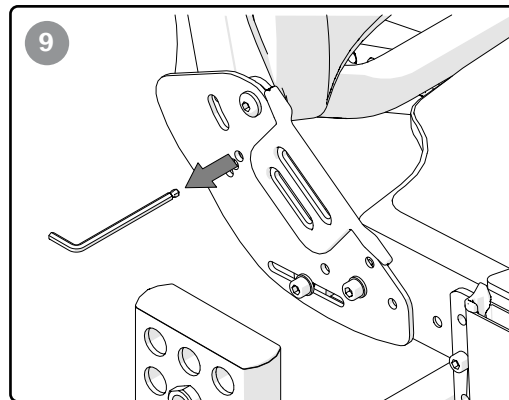
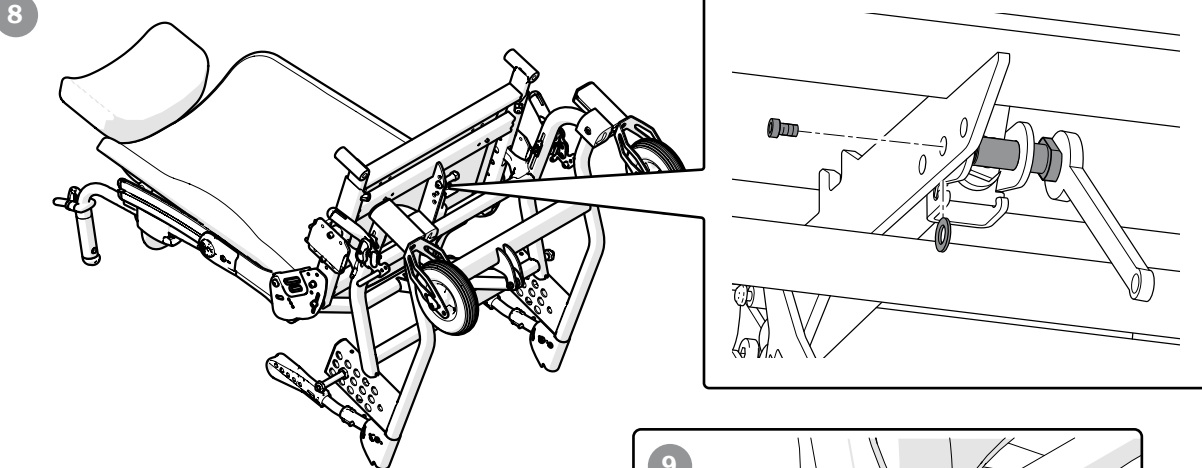



## 14. Advanced settings, adjustments

### Screw positions for rear seat depth, electrical recline function

#### Short seat depth 39-46 cm

Screw positions for frame side/gas piston attachment.

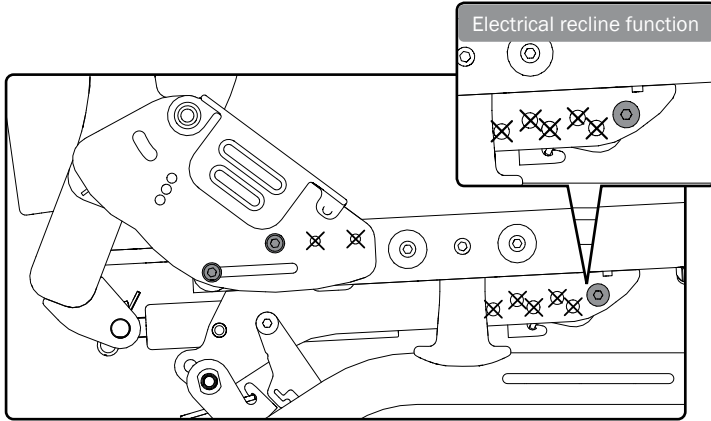

#### Screw positions seat plates

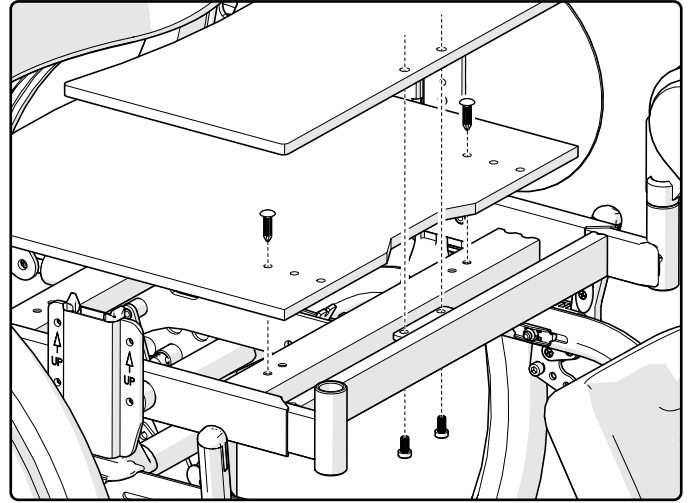

#### Medium seat depth 41.5-48.5 cm

Screw positions for frame side/gas piston attachment.

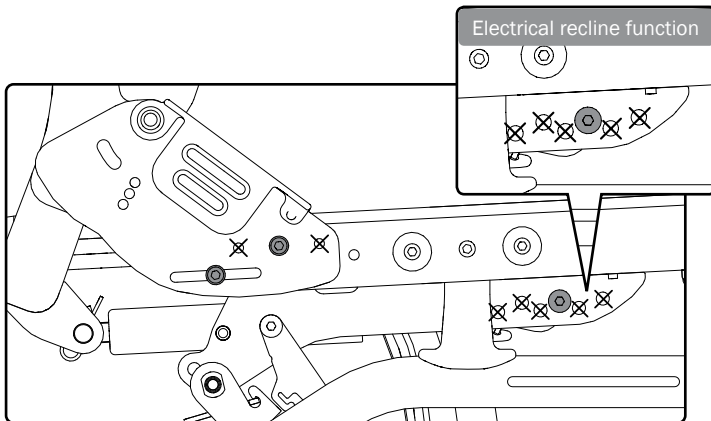

#### Screw positions seat plates

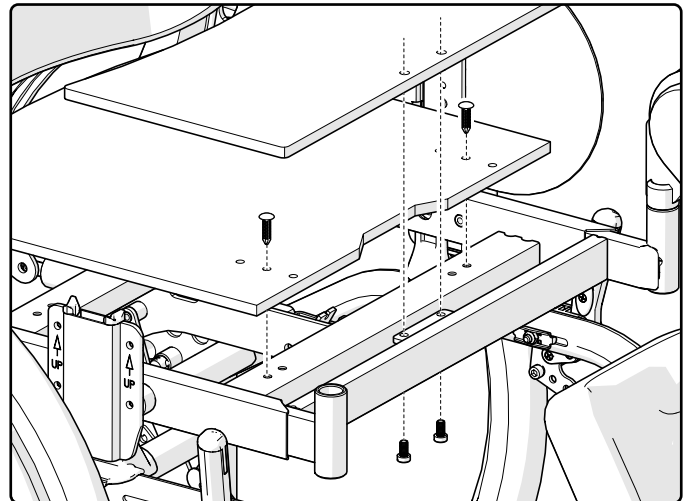

#### Long seat depth 44-51 cm

Screw positions for frame side/gas piston attachment.

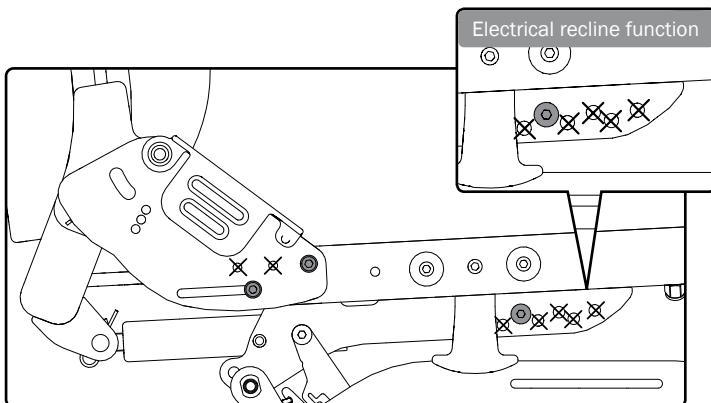

#### Screw positions seat plates

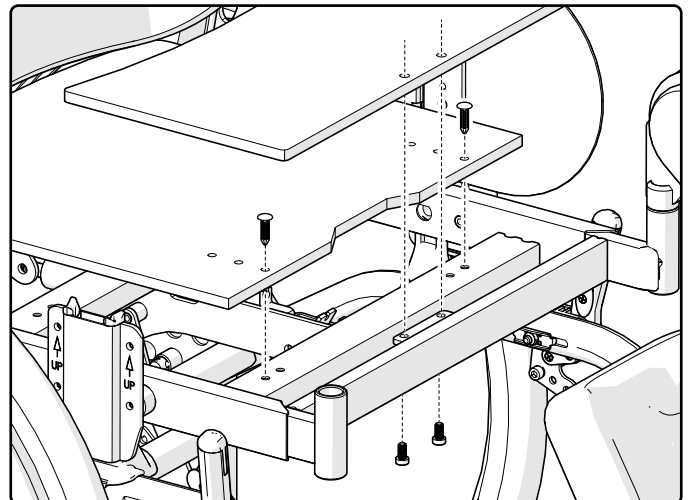



# 14. Advanced settings, adjustments

## Adjustment of comfort lock

1. Undo screw and nut.
2. Adjust the seat angle for the comfort lock by moving and securing the ball bearing bushing. The different angle options are marked on the plate.



Tipping risk. Inactivated anti-tips will increase the risk of injury. Activate the anti-tips to avoid the risk of tipping.



2 Nm



4 mm



8 mm

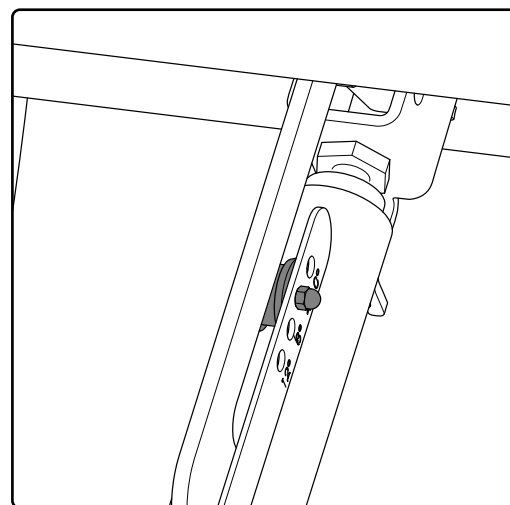
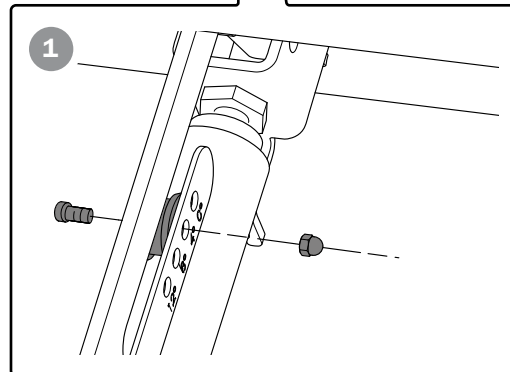
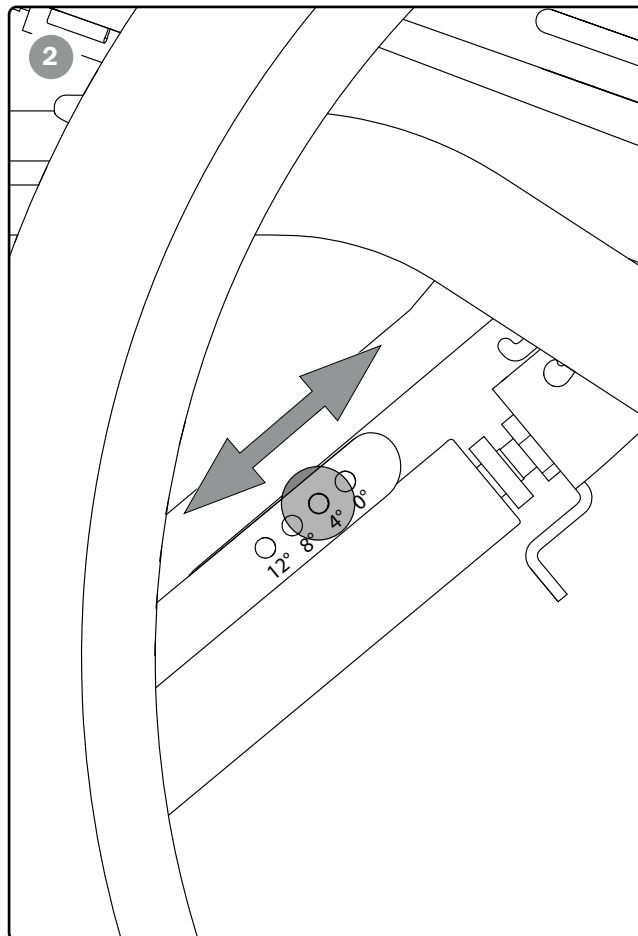
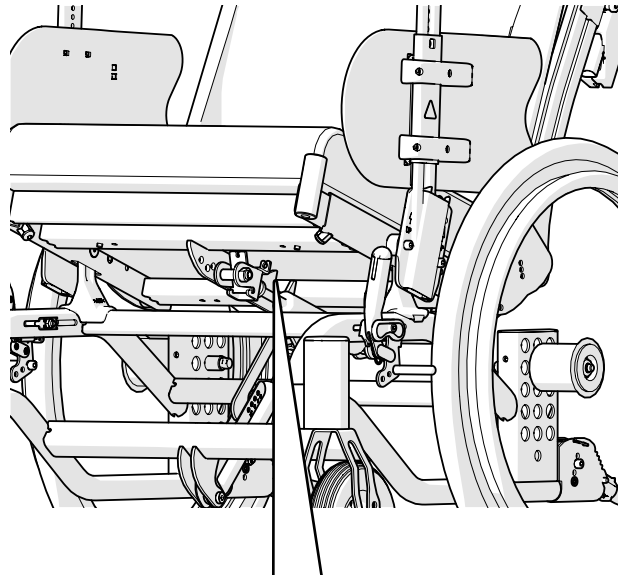
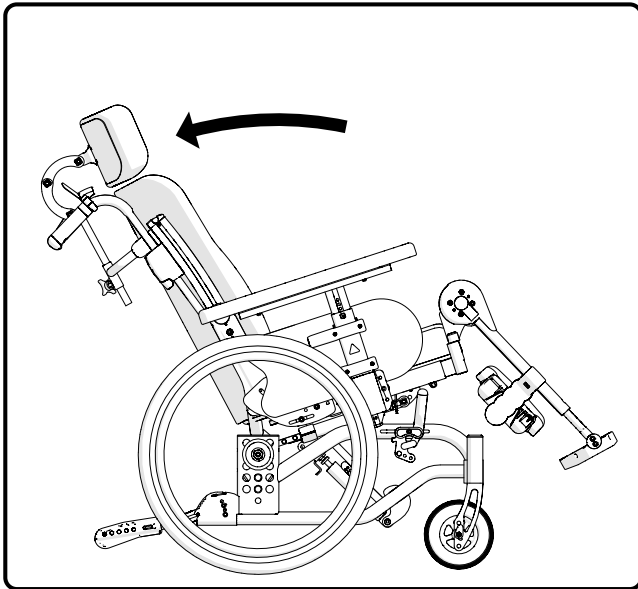

## 15. Settings, readjustments

**The arm support attachment** can be mounted in two different heights. In position 1, the arm support height is settable 23.5-32.5 cm (standard) and in position 2, 26-35 cm at 1 cm intervals. If necessary, the right arm support can be mounted on the left side and vice versa.

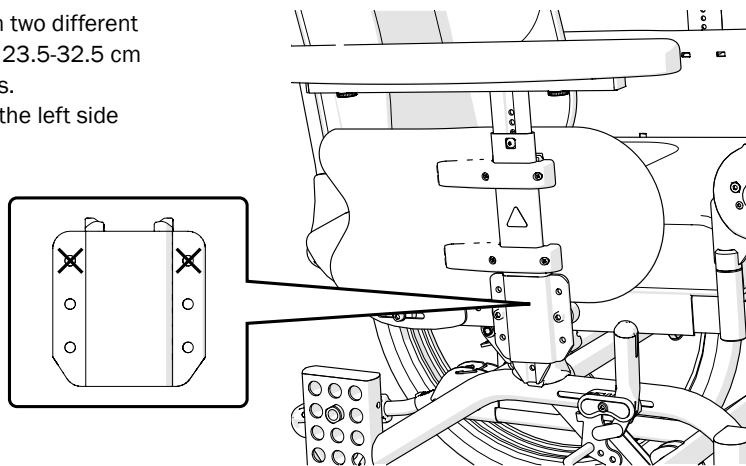

# 15. Settings, readjustments



## Rear wheel with quick-release

The distance between the hub sleeve and the locking balls can be adjusted by adjusting the nut on the outside of the hub. The distance between the hub sleeve and the locking balls should be 0.2 to 1.2 mm.



When attaching the rear wheels, make sure that the quick-release button fully returns. Test by pulling the wheel. Risk of injury.

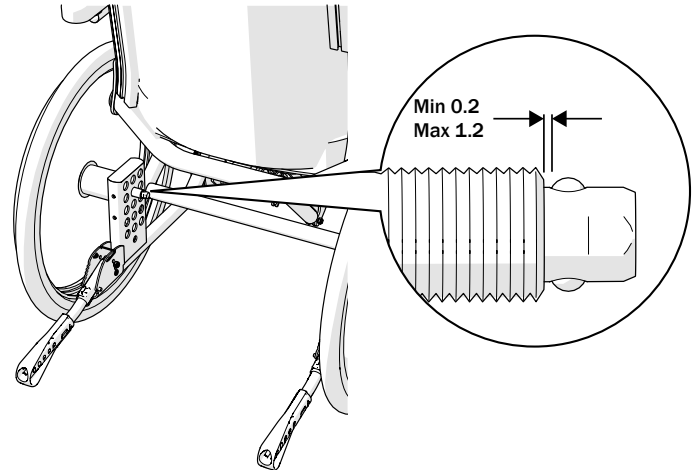
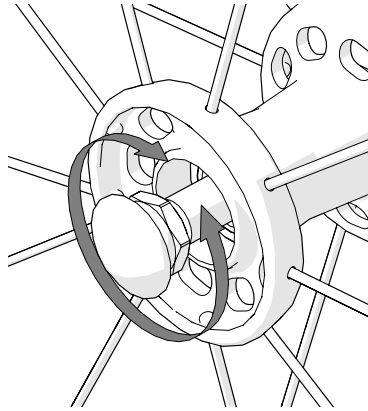
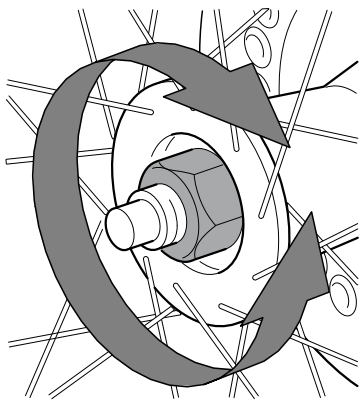

## Brake adjustment

The brakes are variably settable

1. Loosen the screw a few turns.
2. Adjust the brake position
3. The brake block must be approximately 15-20 mm from the tyre when the brake is not being applied.

4. Ensure that the brake is positioned straight in the track. Tighten the nut with approximately 5 Nm. Test the brakes!
5. Make sure that the nut is positioned correctly and locks into the nut pocket on the inside.

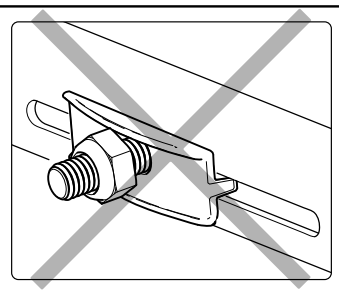
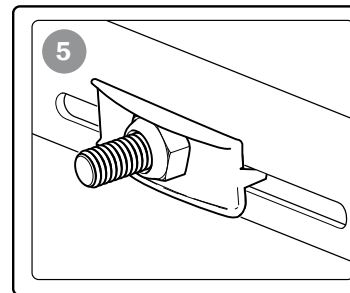
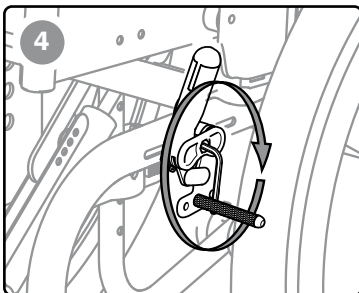
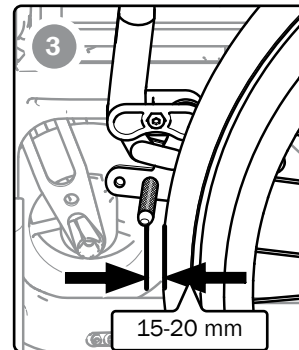
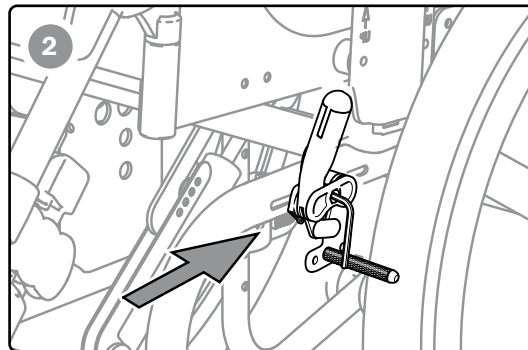
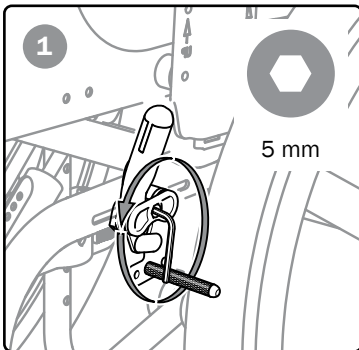

## Brake lever adjustment

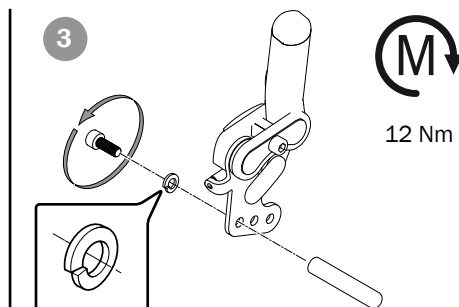
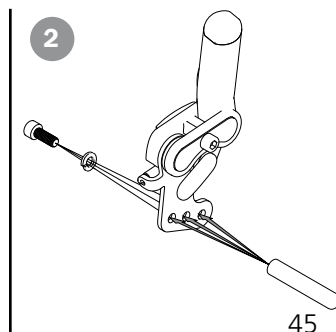
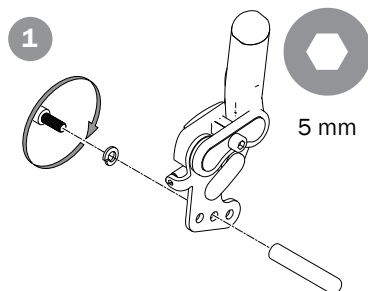

## 15. Settings, readjustments

### Brake, mounting and adjusting brake adapter

Brake adapter is required for the user brake to work with 16", 20" and 22" rear wheels (certain positions, see section "Adjustment of the centre of balance").

See also section "Brake, adjustment".

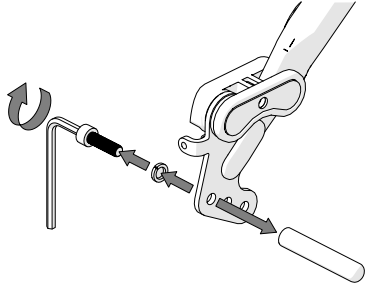

12 Nm

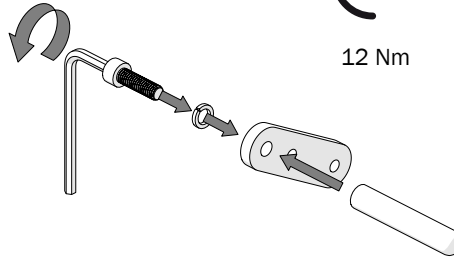

12 Nm

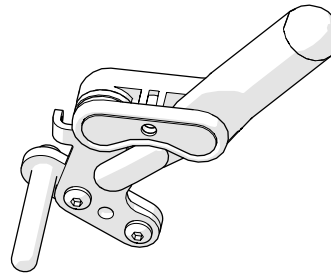
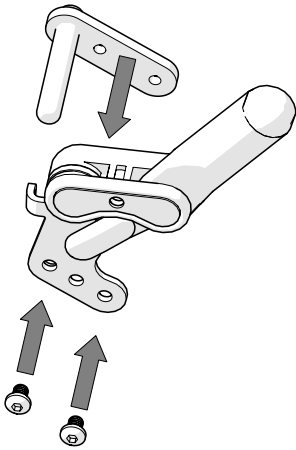

12 Nm

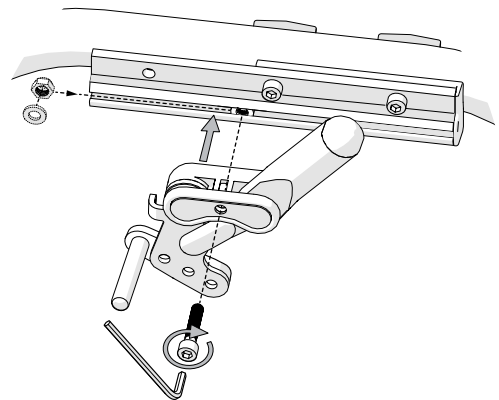
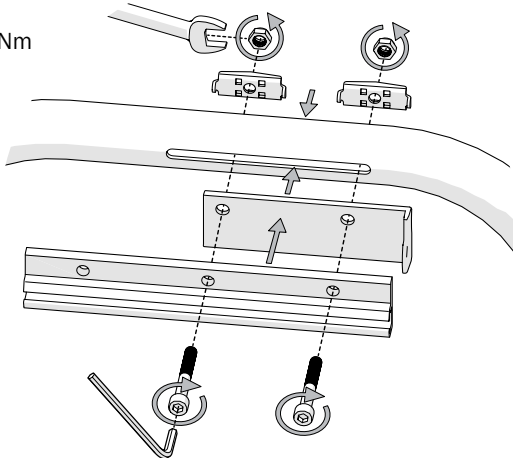



# 15. Settings, readjustments

## Adjustment of the centre of balance

The centre of balance is adjusted by changing the position of the rear wheels.

When the position of the rear wheels is moved forwards the wheelchair becomes much more manoeuvrable, but the tendency to tip backwards increases.

- Move the hub sleeves/rear wheels forward or backward (pos 1, 2, 3). See section "Changing the rear wheel position".
- Adjust the user brake, see Section "Brake, adjustment".

There are restrictions, see illustration.

**X** = inadequate user brake function

**○** = brake adapter required, see section "Brake, mounting and adjusting brake adapter"



Tipping risk. Inactivated anti-tips will increase the risk of injury. Activate the anti-tips to avoid the risk of tipping.



When attaching the rear wheels, make sure that the quick-release button fully returns. Test by pulling the wheel. Risk of injury.



The centre of balance is also altered when the seat and/or back support angle are adjusted.



24 mm



17 mm

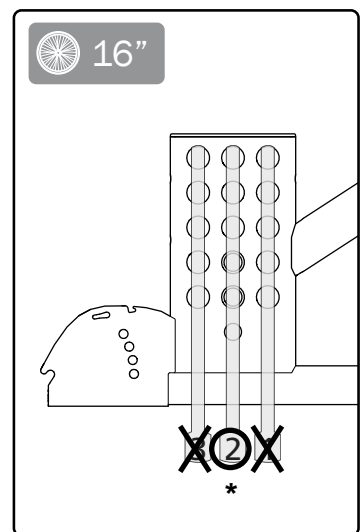
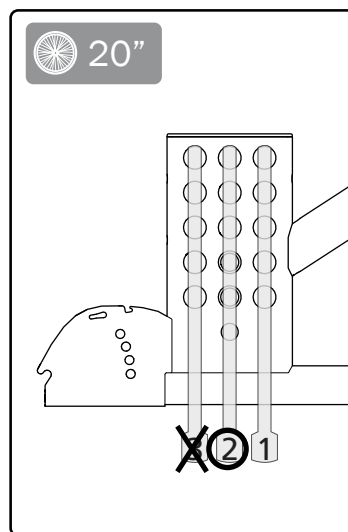
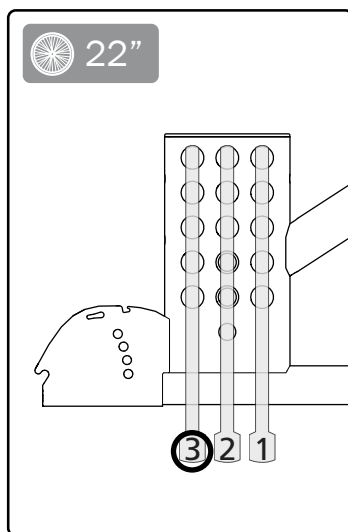
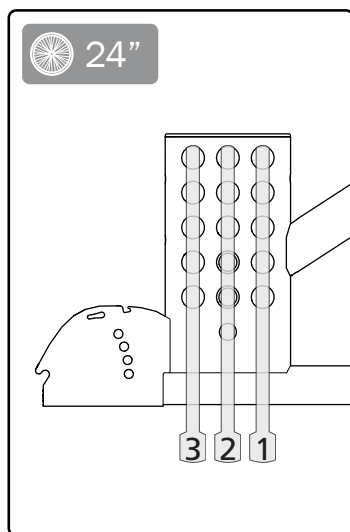

\* Not with seat height adaptor for seat height 51.5 cm

## Amputee leg support

The amputee leg support is height, depth, angle and sideways-settable.

Never sit on the amputee leg support.



4 mm

6 mm

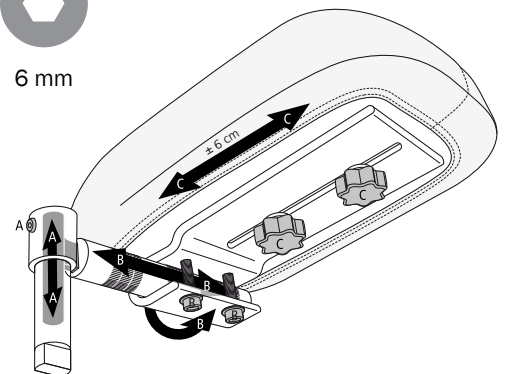

## 15. Settings, readjustments

### Elevating leg support with calf support

The calf support is height and depth-settable.

1. Loosen the screw, adjust the height of the calf support and tighten.
2. Loosen the screw that keeps the calf support in place.
3. Remove the screw and select the depth.
4. Insert the screw and tighten slightly. The calf plate should be movable so that it follows the contours of the calf.



Do not stand on the foot plates. Risk of injury.



Do not lift the wheelchair by the leg supports. Risk of injury.



Always make sure that the screw and footplate knob are installed even if the footplate is not used.



5 mm

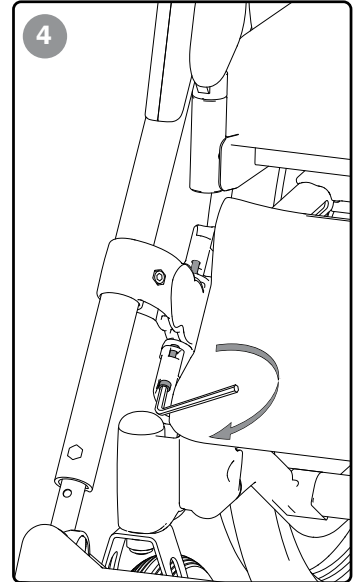
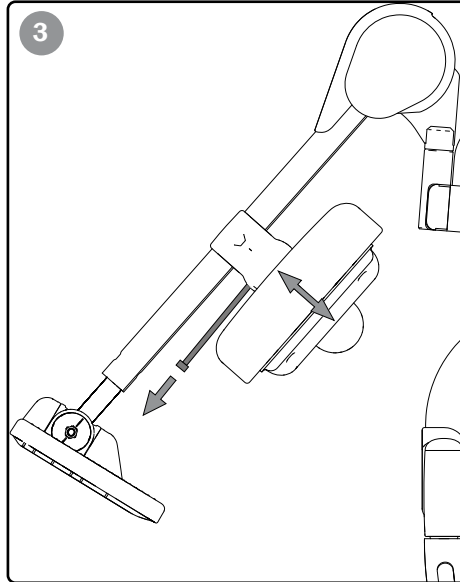
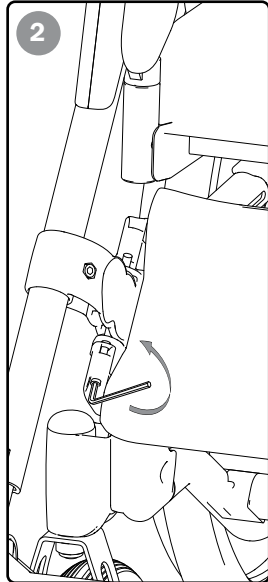
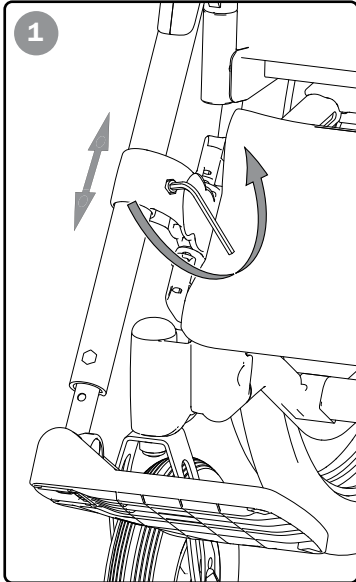

### Anti-tips

The anti-tips are foldable, turnable and height-settable.



Tipping risk. Inactivated anti-tips will increase the risk of injury. Activate the anti-tips to avoid the risk of tipping.



5 mm



2 Nm

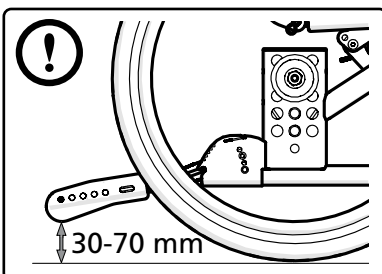
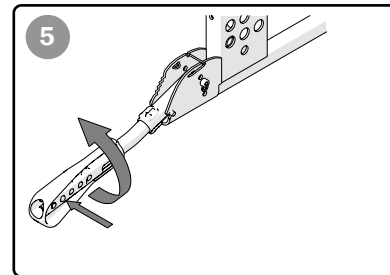
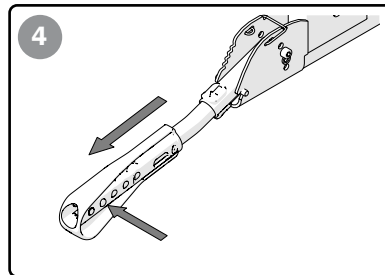
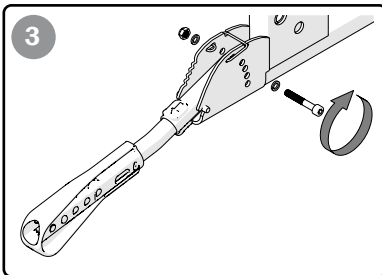
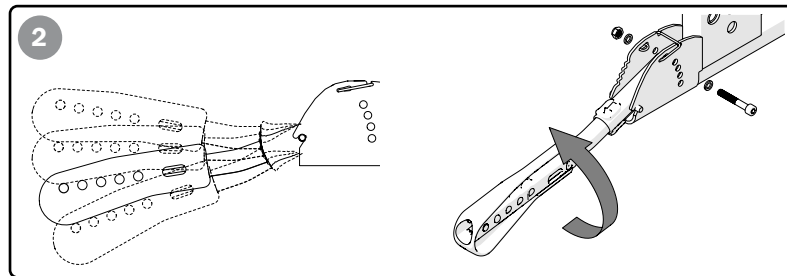
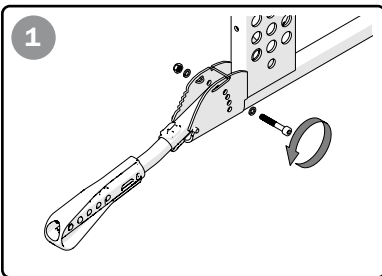

## 16. Accessories - adjustments, handling



Assembly instructions are always provided with accessories when they are supplied by Etac.

Instructions are also available on our website [www.etac.com](http://www.etac.com)

### Positioning belt

The positioning belt is in two parts, length-adjustable and equipped with a snap lock. It is installed in the front part of the lower track in the back support plate or in a separate attachment (accessory).

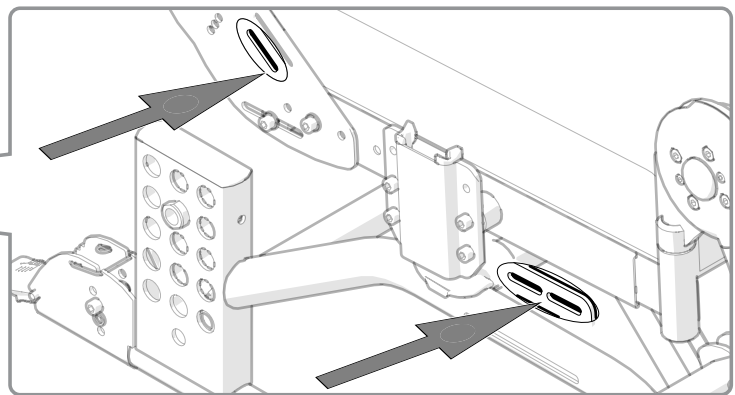
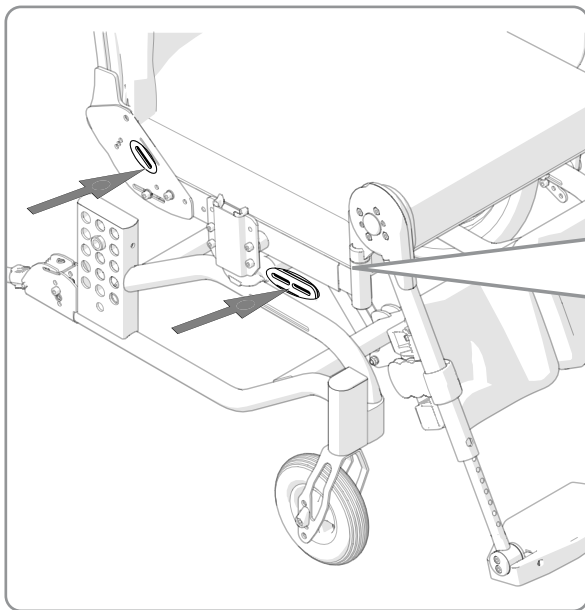

4 mm

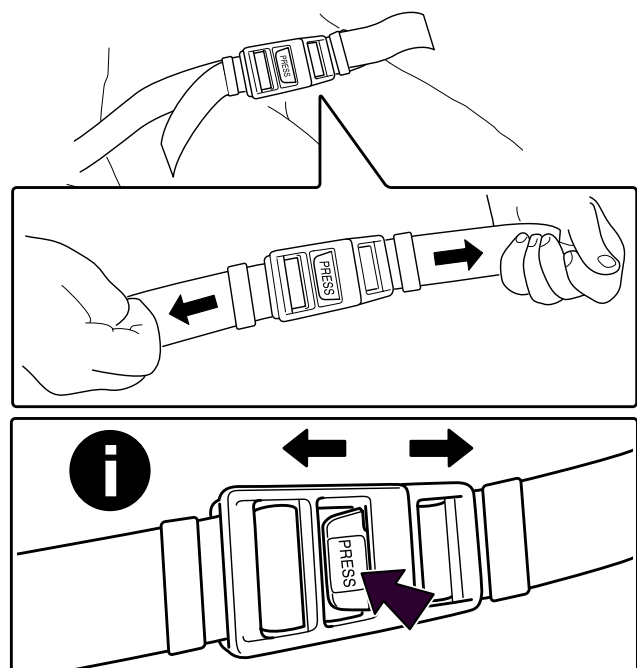
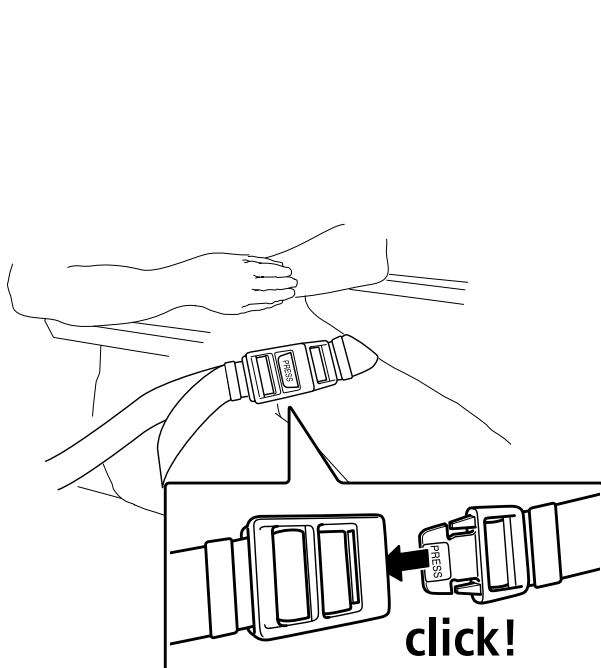



## 16. Accessories - adjustments, handling

### Attachment for chest harness



Chest harness shall only be used in combination with a positioning belt.

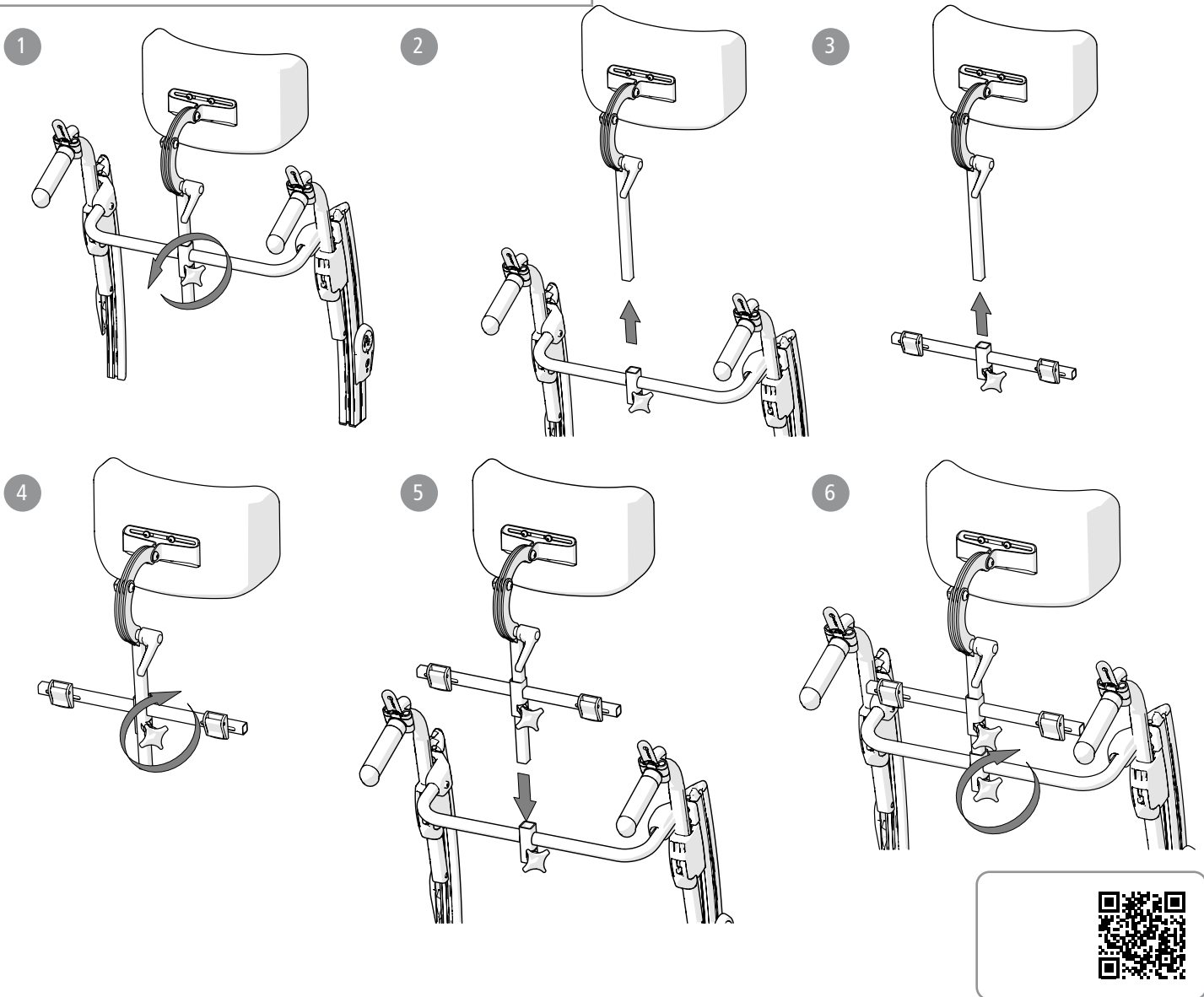

### Attachment points for the chest harness



Chest harness shall only be used in combination with a positioning belt.

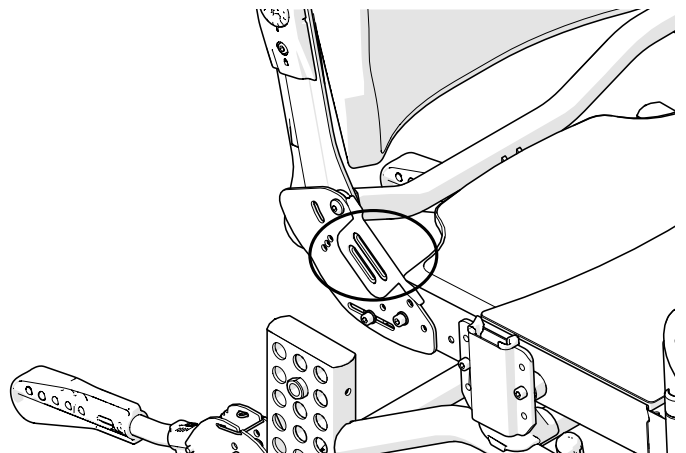
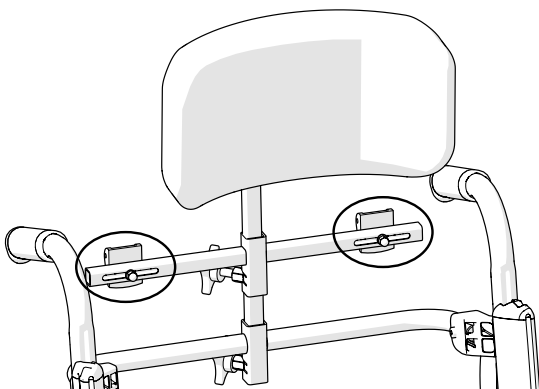

## 16. Accessories - adjustments, handling



### Back support widening

Back support widening is mounted in the slots of the back support frame and widens the back support 40 mm per side. The back support widening is settable in height.

Preferably combined with a wider back support cushion or cover.

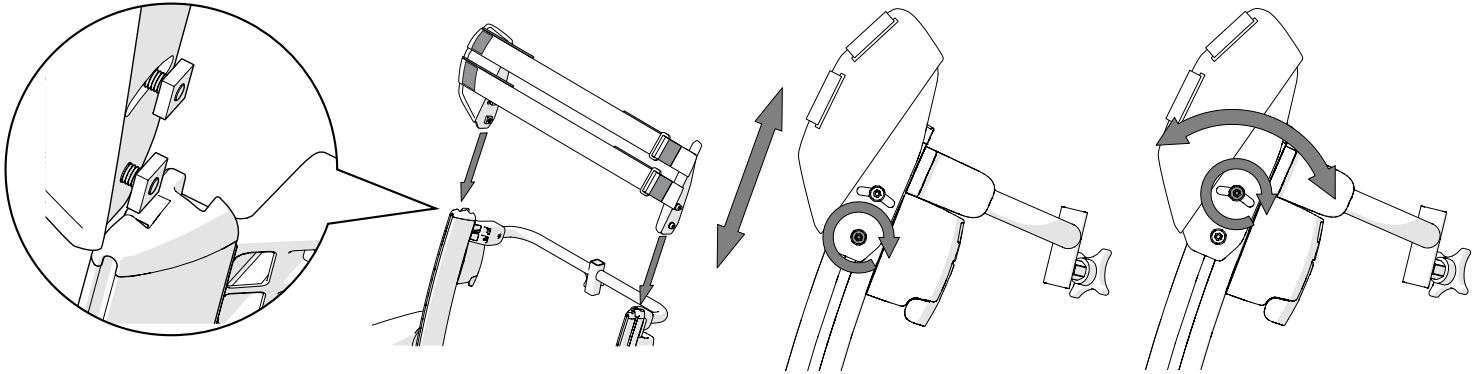

**UK REP**

**Etac Ltd.**

Unit 60, Hartlebury Trading Estate,  
Hartlebury, Kidderminster,  
Worcestershire, DY10 4JB  
+44 121 561 2222

**CH REP**

**Promefa AG**

Kasernenstrasse 3A  
8184 Bachenbülach, CH  
+41 44 872 97 79



**Etac Supply Center AB**

Långgatan 12  
SE-334 33 Anderstorp

 +46 371 58 73 00

 [info@etac.com](mailto:info@etac.com)

 [www.etac.com](http://www.etac.com)



75440

**etac**<sup>®</sup>  
Creating Possibilities